





LISSÉ Bath spout for wall mounting - Brushed Chrome

LISSÉ

13 801 845

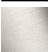
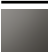

- 210mm projection
- circular normal flow
- hole diameter 37 mm
- 1/2" connection
- plug-link mounting
- max. flow 21.5 l/min at 3 bar flow pressure
- WRAS 2207003

	Brushed Chrome	13 801 845-93
	Chrome	13 801 845-00
	Brushed Platinum	13 801 845-06
	Dark Chrome	13 801 845-19
	Matte Black	13 801 845-33
	Brushed Dark Platinum	13 801 845-99

13 801 845

mm [inches]

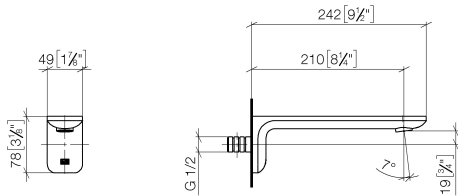

Flow rate chart

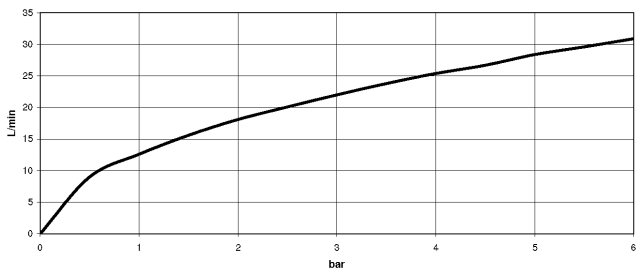

Codes & Standards

ASME A112.18.1	ASME A112.18.1/CSA B125.1	cUPC	DIN 4109
ISO 3822	Scottish Water Byelaws	UK Water Supply Regulations	Ü-Zeichen



LISSE Bath spout for wall mounting - Brushed Chrome

LISSE

13 801 845

Certificates

IAPMO_4976

LGA_29

WRAS_2207

Product version from 3/9/2016

Parts for other
finishes can be found
here: [Chrome](#)

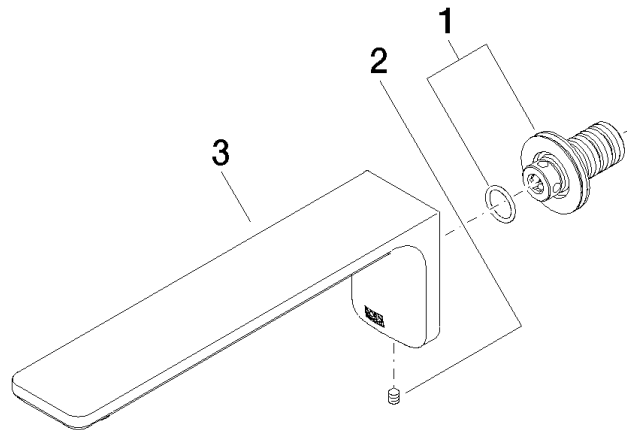



LISSE Bath spout for wall mounting - Brushed Chrome

LISSE

13 801 845

Spare parts list

Product version from 3/9/2016

No.	Item Number	Name	Quantity used	Delivery time
	90 24 03 108 00 90	nipple set	3	2