

VAIA Two-hole bridge mixer for rinsing/Profi spray - Champagne (22kt Gold)

VAIA

19 825 809



- 241mm projection
- pivotable spout 360°
- air-enriched flow
- max. flow 5.7 l/min at 3 bar flow pressure
- lead-free
- This product can help a building meet the requirements of Green Building Rating Systems, e.g. LEED®, BREEAM®, DGNB

|  |                               |                    |
|--|-------------------------------|--------------------|
|  | Champagne (22kt Gold)         | 19 825 809-47 0010 |
|  | Chrome                        | 19 825 809-00 0010 |
|  | Brushed Platinum              | 19 825 809-06 0010 |
|  | Platinum                      | 19 825 809-08 0010 |
|  | Durabrand (23kt Gold)         | 19 825 809-09 0010 |
|  | Dark Chrome                   | 19 825 809-19 0010 |
|  | Brushed Durabrand (23kt Gold) | 19 825 809-28 0010 |
|  | Matte Black                   | 19 825 809-33 0010 |
|  | Brushed Champagne (22kt Gold) | 19 825 809-46 0010 |
|  | Brushed Chrome                | 19 825 809-93 0010 |
|  | Brushed Dark Platinum         | 19 825 809-99 0010 |

Recommended miscellaneous



VAIA Dispenser with rosette - Champagne (22kt Gold)

82 434 809-47

Recommended miscellaneous



VAIA AIR SWITCH Control button - Champagne (22kt Gold)

10 713 809-47



**Product version from 7/1/2023**

Parts for other  
finishes can be found  
here: [Chrome](#)

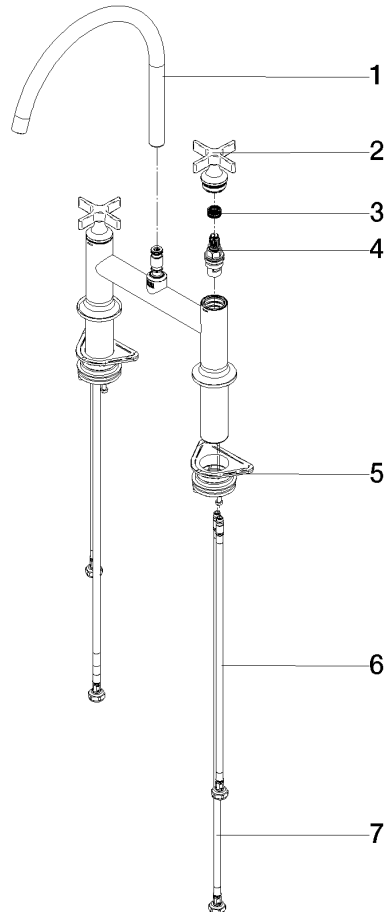



## VAIA Two-hole bridge mixer for rinsing/Profi spray - Champagne (22kt Gold)

VAIA

19 825 809

### Spare parts list

#### Product version from 7/1/2023

| No. | Item Number        | Name  | Quantity used | Delivery time |
|-----|--------------------|-------|---------------|---------------|
|     | 90 28 22 396 01-47 | spout | 13            | 60            |