

20 000 980

- hole diameter valve 32 mm
- rosette 60 x 60 mm



20 000 980

mm [inches]

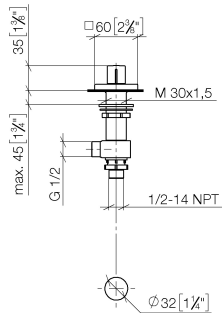

Flow rate chart

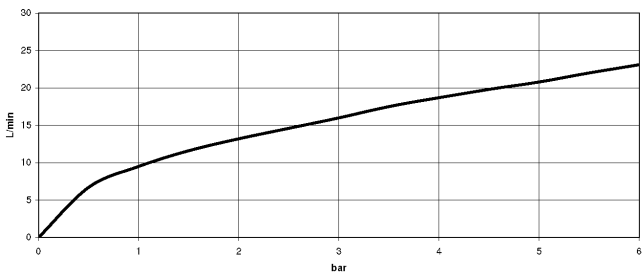

Codes & Standards

ASME A112.18.1	ASME A112.18.1/CSA B125.1	cUPC	EN 200
NSF/ANSI 372	NSF/ANSI/CAN 61	NSF372	VA-Zeichen



SYMETRICS Deck valve anti-clockwise closing cold or hot - Chrome

IMO

20 000 980

Certificates

ETA_18

IAPMO_4976

IAPMO_6

20 000 980

Product version up to 4/30/2013

Product version from 4/30/2013

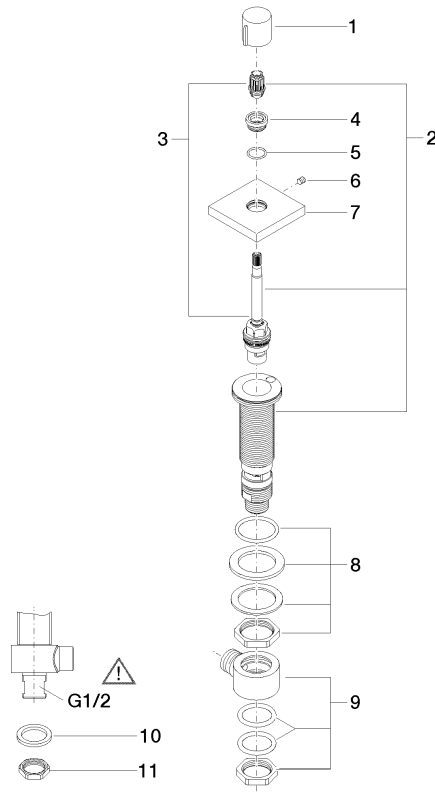



SYMETRICS Deck valve anti-clockwise closing cold or hot - Chrome

IMO

20 000 980

Spare parts list

Product version up to 4/30/2013

Product version from 4/30/2013

No.	Item Number	Name	Quantity used	Delivery time
	09 20 98 001-00	handle	11	10