

MEM Three-hole basin mixer with pop-up waste - Platinum

MEM

20 705 782



- 165mm projection
- fixed spout
- rectangular, air-enriched flow
- height of mixer 144 mm
- height up to aerator 78 mm
- hole diameter spout 35 mm
- hole diameter valve 32 mm
- rosette 60 x 60 mm
- 2x screw-in M 10 x 1 pressure hose, leak-tested
- max. flow 4.5 l/min
- lead-free
- This product can help a building meet the requirements of Green Building Rating Systems, e.g. LEED®, BREEAM®, DGNB

Only suitable for basins with an overflow.

| | | |
|--|-----------------------------------|--------------------|
|  | Platinum | 20 705 782-08 0010 |
|  | Chrome | 20 705 782-00 0010 |
|  | Brushed Platinum | 20 705 782-06 0010 |
|  | Dark Chrome | 20 705 782-19 0010 |
|  | Brushed Durabronze (23kt Gold) | 20 705 782-28 0010 |
|  | Brushed Dark Platinum | 20 705 782-99 0010 |

20 705 782

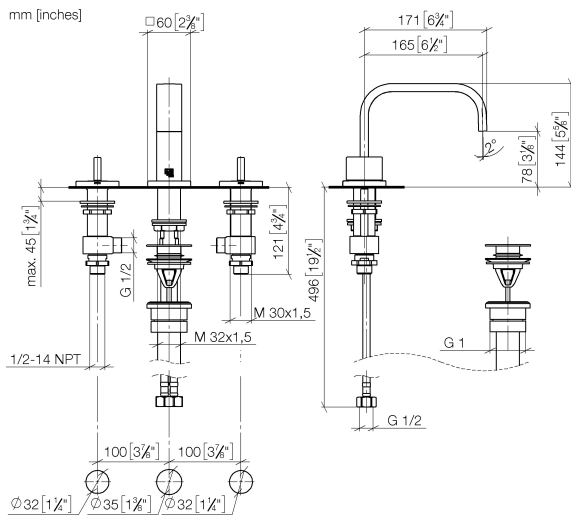

Flow rate chart

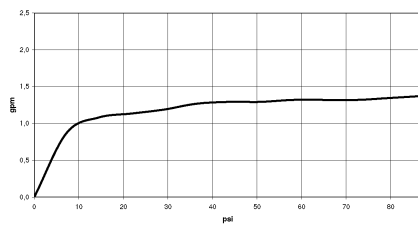

Codes & Standards

California Energy
Commission
(CEC)

20 705 782

Parts for other
finishes can be found
here: [Chrome](#)

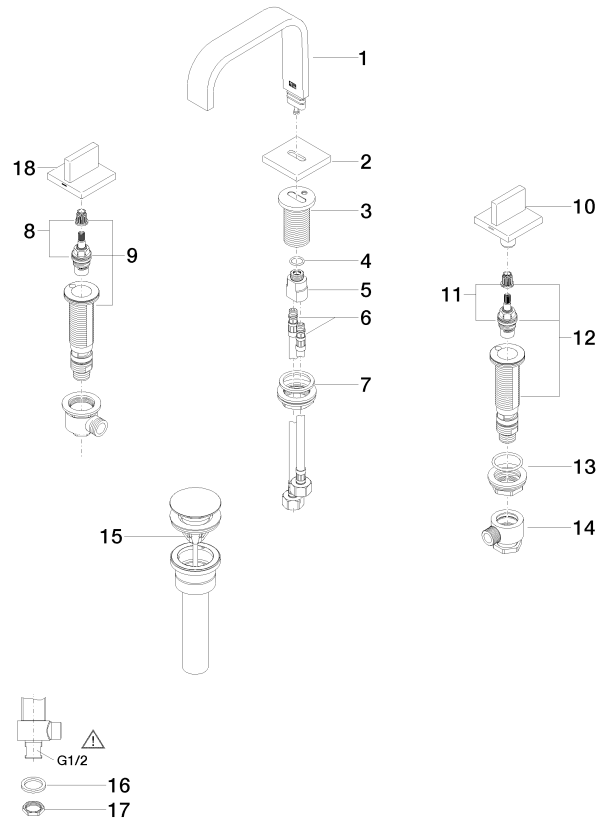



MEM Three-hole basin mixer with pop-up waste - Platinum

MEM

20 705 782

Spare parts list

| No. | Item Number | Name | Quantity used | Delivery time |
|-----|--------------------|-------|---------------|---------------|
| | 90 28 22 360 00-08 | spout | 23 | 40 |