

VAIA Three-hole basin mixer with pop-up waste - Brushed Platinum

VAIA

20 713 809



- 168mm projection
- 1 1/4" pop-up waste
- pivotable spout 360°
- circular, air-enriched flow
- height of mixer 280 mm
- height up to aerator 191 mm
- hole diameter valve 32 mm
- hole diameter spout 35 mm
- rosette Ø 60 mm
- max. flow 4.5 l/min
- lead-free
- This product can help a building meet the requirements of Green Building Rating Systems, e.g. LEED®, BREEAM®, DGNB

Only suitable for basins with an overflow.

| | | |
|--|--------------------------------|--------------------|
|  | Brushed Platinum | 20 713 809-06 0010 |
|  | Chrome | 20 713 809-00 0010 |
|  | Platinum | 20 713 809-08 0010 |
|  | Dark Chrome | 20 713 809-19 0010 |
|  | Brushed Durabronze (23kt Gold) | 20 713 809-28 0010 |
|  | Brushed Bronze | 20 713 809-42 0010 |
|  | Brushed Champagne (22kt Gold) | 20 713 809-46 0010 |
|  | Champagne (22kt Gold) | 20 713 809-47 0010 |
|  | Brushed Dark Platinum | 20 713 809-99 0010 |

20 713 809

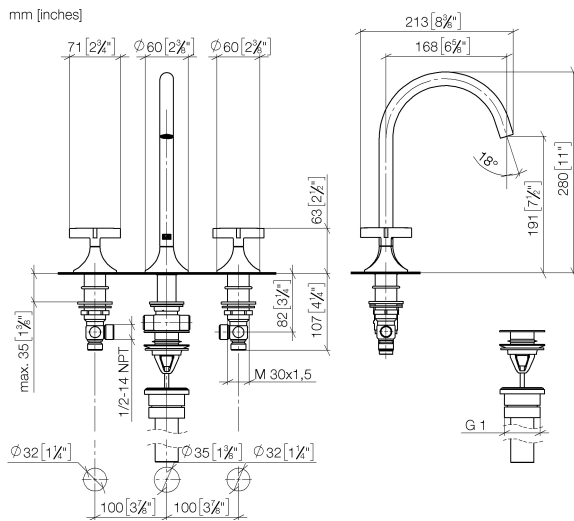

Flow rate chart

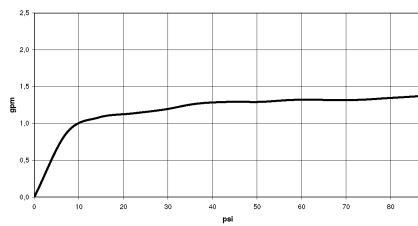

Codes & Standards

| | | | |
|--------|----------------|---------------------------------|--|
| ADA | ASME A112.18.1 | ASME A112.18.1/CSA B125.1 | California Energy Commission (CEC) |
| cUPC | EPA WaterSense | NSF/ANSI 372 | NSF/ANSI/CAN 61 |
| NSF372 | NSF61 | Water Sense | WaterSense  |



VAIA Three-hole basin mixer with pop-up waste - Brushed Platinum

VAIA

20 713 809

Certificates

IAPMO_4976

IAPMO_N-4

IAPMO_8834

IAPMO_6

20 713 809

Product version from 3/13/2017 to 5/27/2021

Product version from 5/27/2021

Parts for other
finishes can be found
here: [Chrome](#)

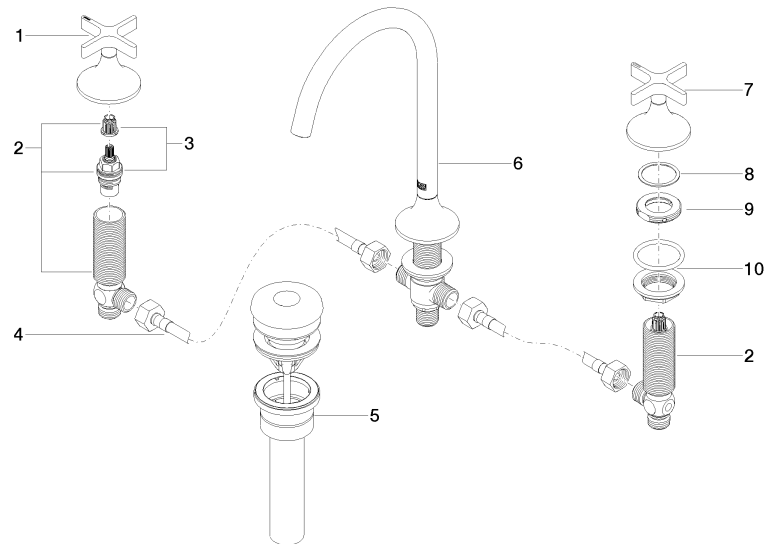



VAIA Three-hole basin mixer with pop-up waste - Brushed Platinum

VAIA

20 713 809

Spare parts list

Product version from 3/13/2017 to 5/27/2021

Product version from 5/27/2021

| No. | Item Number | Name | Quantity used | Delivery time |
|-----|--------------------|----------------|---------------|---------------|
| | 90 20 80 011 00-06 | handle (hot) | 16 | 10 |