

META Single-lever basin mixer with stand pipe without pop-up waste - Brushed Chrome

META

22 584 660



- 196mm projection
- fixed spout
- circular, air-enriched flow
- total height 1033 - 1103 mm
- height up to aerator 951 – 1021 mm
- rosette Ø 135 mm
- max. flow 4.5 l/min
- lead-free
- This product can help a building meet the requirements of Green Building Rating Systems, e.g. LEED®, BREEAM®, DGNB

| | | |
|---|-------------------------------|--------------------|
|  | Brushed Chrome | 22 584 660-93 0010 |
|  | Chrome | 22 584 660-00 0010 |
|  | Brushed Platinum | 22 584 660-06 0010 |
|  | Light Gold | 22 584 660-26 0010 |
|  | Brushed Light Gold | 22 584 660-27 0010 |
|  | Matte Black | 22 584 660-33 0010 |
|  | Brushed Bronze | 22 584 660-42 0010 |
|  | Brushed Champagne (22kt Gold) | 22 584 660-46 0010 |
|  | Champagne (22kt Gold) | 22 584 660-47 0010 |
|  | Brushed Dark Platinum | 22 584 660-99 0010 |

Required miscellaneous



- Concealed floor mounting -**
- max. recess depth 150 mm
 - min. recess depth 80 mm

35 949 970-90
0010



META Single-lever basin mixer with stand pipe without pop-up waste - Brushed Chrome

META

22 584 660
mm [inches]

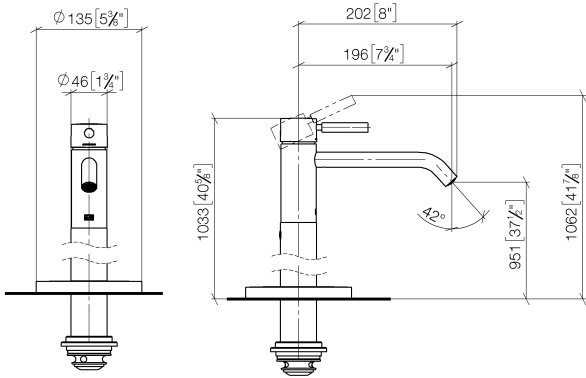

Flow rate chart

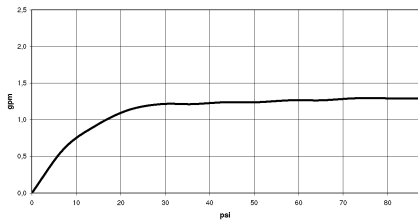

Codes & Standards

| | | | | |
|------------------------------------|----------------|-------------|------------|--|
| California Energy Commission (CEC) | EPA WaterSense | Water Sense | WaterSense | |
|------------------------------------|----------------|-------------|------------|--|



META Single-lever basin mixer with stand pipe without pop-up waste - Brushed Chrome

META

22 584 660

Certificates

IAPMO_8834

META Single-lever basin mixer with stand pipe without pop-up waste - Brushed Chrome

META

22 584 660

Product version from 5/1/2022





META Single-lever basin mixer with stand pipe without pop-up waste - Brushed Chrome

META

22 584 660

Spare parts list

Product version from 5/1/2022

| No. | Item Number | Name | Quantity used | Delivery time |
|-----|--------------------|--------|---------------|---------------|
| | 90 20 66 002 00-93 | handle | 17 | 20 |