

VAIA Bath mixer for wall mounting with hand shower set - Brushed Dark Platinum

VAIA

25 133 809



- 240mm projection
- spout: circular, air-enriched flow
- complete hand shower set: normal flow
- complete hand shower set with anti-scale system
- rotary diverter for bath/shower
- slide-on rosettes Ø 70 mm
- rosette for shower holder Ø 60mm
- 1/2" connection
- gauge 150 mm - 15 mm
- metal shower hose 1250mm with integrated anti-twist protection
- max. flow 21.5 l/min at 3 bar flow pressure
- max. flow for complete hand shower set 6.8 l/min

Intrinsic protection against back flow.

Note: Local building codes may require the use of an anti-scald device. Please refer to remote pressure balance valve (35 910 970 90)

Intrinsic protection against back flow.

Note: Local building codes may require the use of an anti-scald device. Please refer to remote pressure balance valve (35 910 970 90)

Required miscellaneous



Concealed adapter -

- please order two adapters (USA only)

35 080 970-90

0010

VAIA Bath mixer for wall mounting with hand shower set - Brushed Dark Platinum

VAIA

25 133 809
mm [inches]

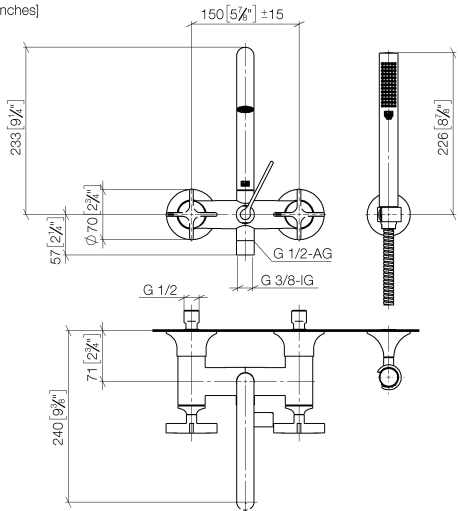

Flow rate chart



Codes & Standards

California Energy
Commission
(CEC)



VAIA Bath mixer for wall mounting with hand shower set - Brushed Dark Platinum

VAIA

25 133 809

Certificates

LGA_29293.

25 133 809

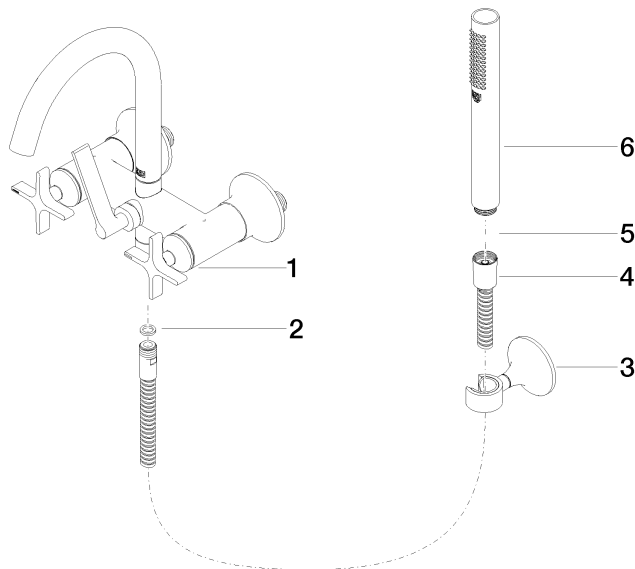

Spare parts list

No.	Item Number	Name	Quantity used	Delivery time
1	25 100 809-99	shower set	1	60
2	90 14 20 026 00 90	seal	1	2
3	28 050 809-99	VAIA Wall bracket - Brushed Dark Platinum	1	30
4	90 30 02 072 00-99	Metal shower hose 1/2" x 3/8" x 1250 mm - Brushed Dark Platinum	1	30
5	90 14 20 002 00 90	seal	1	2
6	28 019 979-99	Hand shower - Brushed Dark Platinum	1	30