

## Shower set without hand shower - Brushed Light Gold

IMO

26 413 980



Fits: IMO, MEM, CL.1, CYO

- slide bar
- Pipe diameter 18 mm
- rosette 60 x 60 mm
- gauge 800 mm
- metal shower hose 1750mm with integrated anti-twist protection
- shower hose connector 3/8"
- WRAS 2009048

**This article does not include a hand shower!**

**NOTE: Hand shower sold separately. Please see hand shower options under the miscellaneous articles section of each series.**

This article does not include a hand shower!

NOTE: Hand shower sold separately. Please see hand shower options under the miscellaneous articles section of each series.

	Brushed Light Gold	26 413 980-27
	Chrome	26 413 980-00
	Brushed Platinum	26 413 980-06
	Platinum	26 413 980-08
	Dark Chrome	26 413 980-19
	Brushed Durabronze (23kt Gold)	26 413 980-28
	Matte Black	26 413 980-33
	Brushed Champagne (22kt Gold)	26 413 980-46
	Champagne (22kt Gold)	26 413 980-47
	Brushed Chrome	26 413 980-93
	Brushed Dark Platinum	26 413 980-99

### Required miscellaneous

	<b>Concealed adapter -</b>	35 080 970-90 0010
---	----------------------------	-----------------------

### Recommended miscellaneous

	<b>Wall elbow - Chrome</b>	28 450 980-00
---	----------------------------	---------------

### Required miscellaneous

	<b>Hand shower FlowReduce - Brushed Light Gold</b>	28 018 979-27 0010
---	--	-----------------------

### Required miscellaneous

	<b>Hand shower FlowReduce - Brushed Light Gold</b>	28 012 979-27 0010
---	--	-----------------------

### Required miscellaneous

	<b>Hand shower FlowReduce - Brushed Light Gold</b>	28 016 979-27 0010
---	--	-----------------------

## Shower set without hand shower - Brushed Light Gold

IMO

26 413 980

mm [inches]

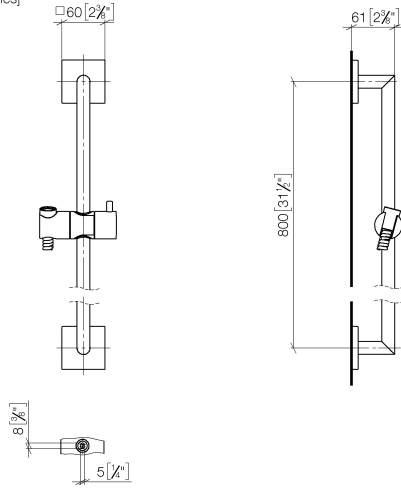

**Product version from 6/1/2024**

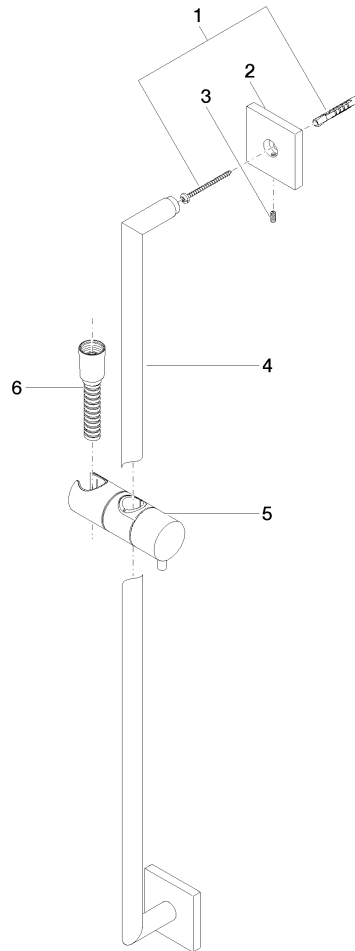



## Shower set without hand shower - Brushed Light Gold

IMO

26 413 980

### Spare parts list

#### Product version from 6/1/2024

No.	Item Number	Name	Quantity used	Delivery time
	05 30 31 025 00 90	fixing set	9	2