







## MADISON Rain shower with ceiling fixing 200 mm - Durabrand (23kt Gold)

MADISON

28 565 977

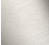

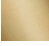
- rain shower Ø 200 mm
- PURE RAIN, max. flow rate 6.8 l/min (at 3 bar)
- distance between ceiling and lower edge of the shower 185mm
- rosette Ø 55 mm
- 1/2" connection
- with anti-scale system
- This product reduces water consumption by % (compared to requirements of EPAct '92)
- This product can help a building meet the requirements of Green Building Rating Systems, e.g. LEED®, BREEAM®, DGNB

	Durabrand (23kt Gold)	28 565 977-09 0010
	Chrome	28 565 977-00 0010
	Brushed Platinum	28 565 977-06 0010
	Platinum	28 565 977-08 0010
	Brushed Durabrand (23kt Gold)	28 565 977-28 0010
	Brushed Dark Platinum	28 565 977-99 0010

### Required miscellaneous



- Concealed wall elbow -** 35 085 970-90  
 • max. recess depth 163 mm 0010  
 • min. recess depth 90 mm



MADISON Rain shower with ceiling fixing 200 mm - Durabrand (23kt Gold)

MADISON

28 565 977

mm [inches]

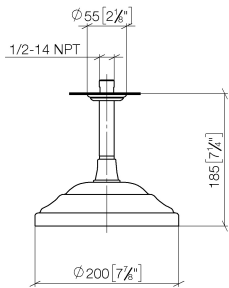

Flow rate chart

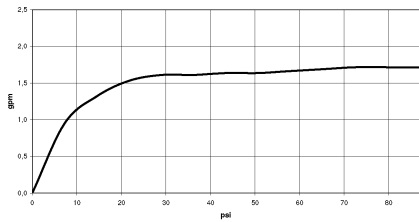

Codes & Standards

ASME A112.18.1	ASME A112.18.1/CSA B125.1	California Energy Commission (CEC)	cUPC
EPA WaterSense	Water Sense	WaterSense	



## MADISON Rain shower with ceiling fixing 200 mm - Durabrass (23kt Gold)

---

MADISON

28 565 977

### Certificates

---

IAPMO\_4976

IAPMO\_11

Product version up to 12/5/2019

**Product version from 12/5/2019**

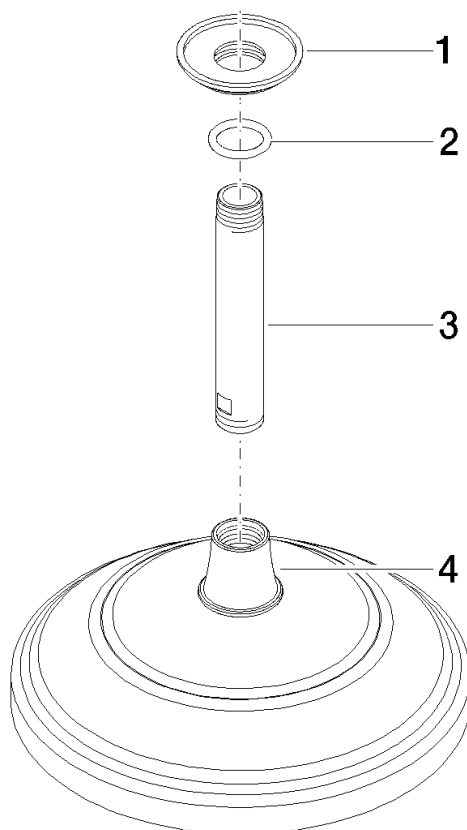



MADISON Rain shower with ceiling fixing 200 mm - Durabrass (23kt Gold)

MADISON

28 565 977

Spare parts list

Product version up to 12/5/2019

Product version from 12/5/2019

No.	Item Number	Name	Quantity used	Delivery time
	09 27 35 003-09	rosette	4	40