

## Rain shower with ceiling fixing 300 x 240 mm - Platinum







MEM

28 775 980

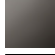

Fits: MEM, CL.1

- PURE RAIN, max. flow rate 6.8 l/min (at 3 bar)
- with anti-scale system
- rain shower 300 x 240mm
- distance between ceiling and lower edge of the shower 165mm
- rosette 60 x 60, as required
- 1/2" connection
- Function from: 6 l/min
- This product reduces water consumption by % (compared to requirements of EPAct '92)
- This product can contribute to Water Use Reduction in LEED® Green Building Rating
- This product can help a building meet the requirements of Green Building Rating Systems, e.g. LEED®, BREEAM®, DGNB

	Platinum	28 775 980-08 0010
	Chrome	28 775 980-00 0010
	Brushed Platinum	28 775 980-06 0010
	Dark Chrome	28 775 980-19 0010
	Brushed Durabross (23kt Gold)	28 775 980-28 0010
	Matte Black	28 775 980-33 0010
	Brushed Champagne (22kt Gold)	28 775 980-46 0010
	Champagne (22kt Gold)	28 775 980-47 0010
	Brushed Chrome	28 775 980-93 0010
	Brushed Dark Platinum	28 775 980-99 0010

### Required miscellaneous



#### Concealed wall elbow -

- max. recess depth 163 mm
- min. recess depth 90 mm

35 085 970-90  
0010

28 775 980

mm [inches]

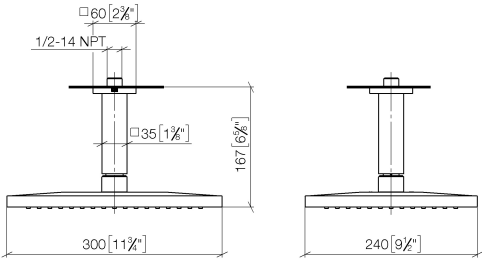

Flow rate chart

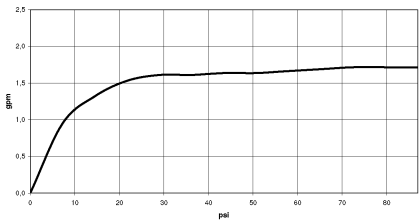

Codes & Standards

ASME A112.18.1/CSA B125.1	California Energy Commission (CEC)	Water Sense	
---------------------------------	--	-------------	--



## Rain shower with ceiling fixing 300 x 240 mm - Platinum

---

MEM

28 775 980

### Certificates

---

IAPMO\_11777.      IAPMO\_4976 (4).

28 775 980

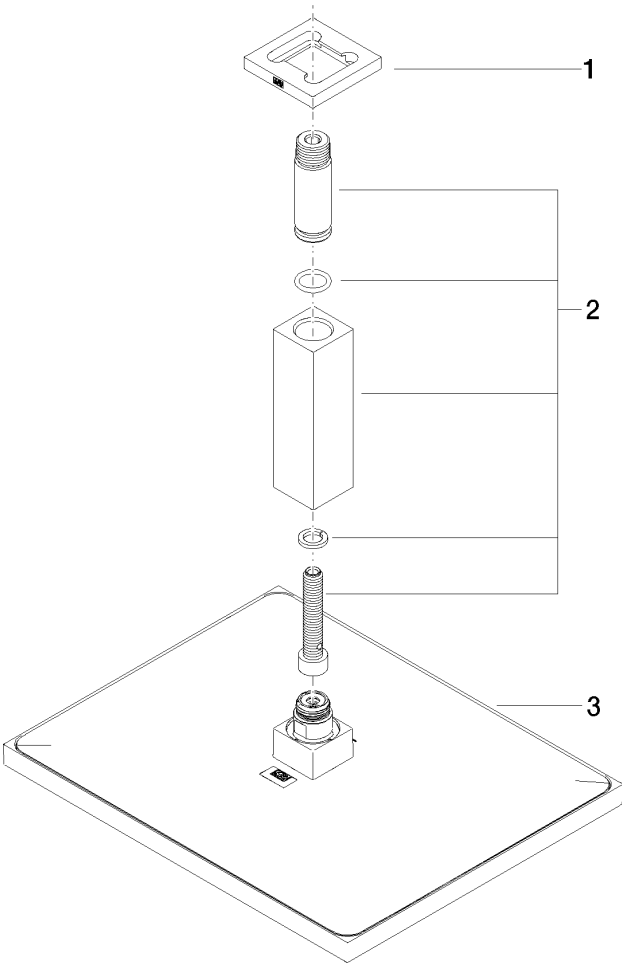

Spare parts list

No.	Item Number	Name	Quantity used	Delivery time
1	09 27 98 017-08	rosette	1	40
2	90 11 10 092 00-08	connection	1	40
3	04 12 05 063 10-08	shower	1	40