

LOT Single-lever mixer - Platinum

LOT

33 800 680 Product version from 3/1/2023



- 236mm projection
- pivotable spout 360°
- air-enriched flow
- height of mixer 292 mm
- height up to aerator 267 mm
- hole diameter 35 mm
- 2 x pressure hose with 3/8" cap nut
- max. flow 5.7 l/min at 3 bar flow pressure
- lead-free
- This product can help a building meet the requirements of Green Building Rating Systems, e.g. LEED®, BREEAM®, DGNB

Not possible in combination with rinsing spray.

| | | |
|---|--------------------------------|--------------------|
|  | Platinum | 33 800 680-08 0010 |
|  | Chrome | 33 800 680-00 0010 |
|  | Brushed Platinum | 33 800 680-06 0010 |
|  | Dark Chrome | 33 800 680-19 0010 |
|  | Brushed Durabronze (23kt Gold) | 33 800 680-28 0010 |
|  | Brushed Champagne (22kt Gold) | 33 800 680-46 0010 |
|  | Champagne (22kt Gold) | 33 800 680-47 0010 |
|  | Brushed Dark Platinum | 33 800 680-99 0010 |

Recommended miscellaneous

Dispenser with rosette - Platinum 82 439 970-08



Recommended miscellaneous

AIR SWITCH Control button - Platinum 10 714 970-08





LOT Single-lever mixer - Platinum

LOT

33 800 680 Product version from 3/1/2023

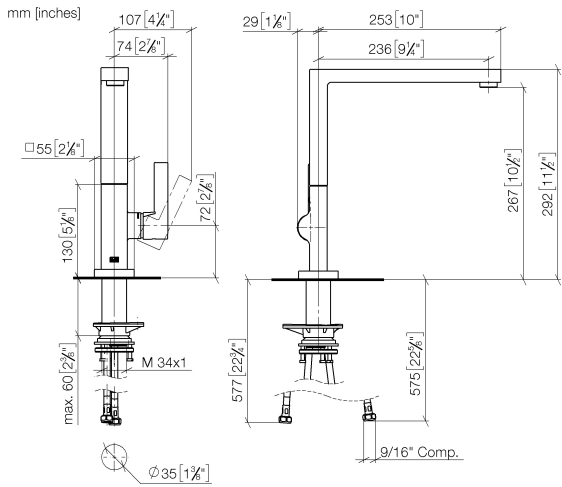

Flow rate chart

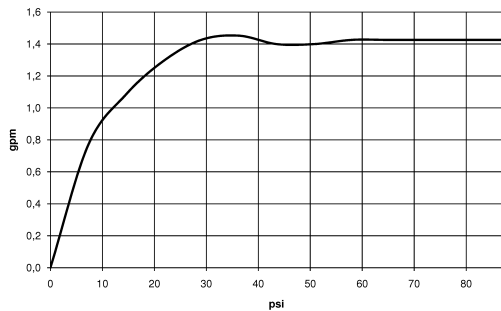

Codes & Standards

California Energy Commission (CEC) NSF372



LOT Single-lever mixer - Platinum

LOT

33 800 680 Product version from 3/1/2023

Certificates

IAPMO_6397

LOT Single-lever mixer - Platinum

LOT

33 800 680 Product version from 3/1/2023

Parts for other
finishes can be found
here: [Chrome](#)

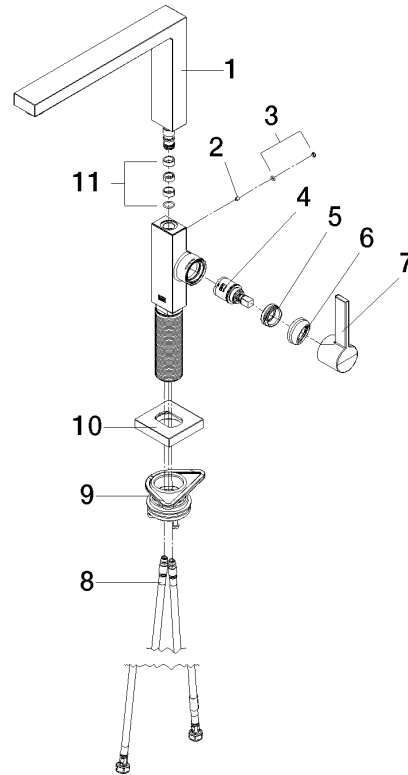

Spare parts list

| No. | Item Number | Name | Quantity used | Delivery time |
|--|--------------------|------------|---------------|---------------|
| 1 | 90 11 06 218 01-08 | spout | 1 | - |
| Spare part can no longer be ordered, please order the replacement item | | | | |
| 2 | 09 31 11 044 90 | pin | 1 | 2 |
| 3 | 90 31 20 087 00-08 | plug | 1 | 40 |
| 4 | 90 15 05 042 00 90 | cartridge | 1 | 2 |
| 5 | 09 24 04 266 90 | nut | 1 | 2 |
| 6 | 90 28 30 052 00-08 | cover | 1 | 40 |
| 7 | 90 20 86 004 00-08 | handle | 1 | 40 |
| 8 | 04 30 04 103 00 90 | hose | 2 | 2 |
| 9 | 90 30 10 057 00 90 | fixing set | 1 | - |
| Spare part can no longer be ordered, please order the replacement item | | | | |
| 10 | 90 27 86 004 00-08 | rosette | 1 | - |
| Spare part can no longer be ordered, please order the replacement item | | | | |
| 11 | 90 28 10 207 00 90 | gasket kit | 1 | 2 |