

MEM BAR TAP Single-lever mixer - Platinum

MEM

33 805 682



- 166mm projection
- pivotable spout 360°
- Optional swivel limiter available with swivel limiter set 12 820 970 90
- laminar flow
- height of mixer 322 mm
- height up to laminar flow regulator 216 mm
- hole diameter 35 mm
- 2 x pressure hose with 3/8" cap nut
- max. flow 5.7 l/min at 3 bar flow pressure
- lead-free
- This product can help a building meet the requirements of Green Building Rating Systems, e.g. LEED®, BREEAM®, DGNB

Not possible in combination with rinsing spray.

| | | |
|---|-------------------------------|--------------------|
|  | Platinum | 33 805 682-08 0010 |
|  | Chrome | 33 805 682-00 0010 |
|  | Brushed Platinum | 33 805 682-06 0010 |
|  | Durabrand (23kt Gold) | 33 805 682-09 0010 |
|  | Dark Chrome | 33 805 682-19 0010 |
|  | Brushed Durabrand (23kt Gold) | 33 805 682-28 0010 |
|  | Matte Black | 33 805 682-33 0010 |
|  | Brushed Champagne (22kt Gold) | 33 805 682-46 0010 |
|  | Champagne (22kt Gold) | 33 805 682-47 0010 |
|  | Brushed Chrome | 33 805 682-93 0010 |
|  | Brushed Dark Platinum | 33 805 682-99 0010 |

Recommended miscellaneous

Swivel limitation set -

12 820 970 90



Recommended miscellaneous

**AIR SWITCH Control button -
Platinum**

10 713 970-08



Recommended miscellaneous

**Dispenser without rosette -
Platinum**

82 424 970-08



33 805 682

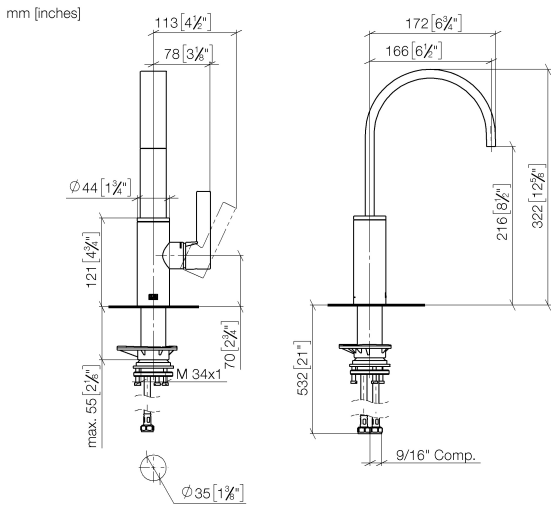

Flow rate chart

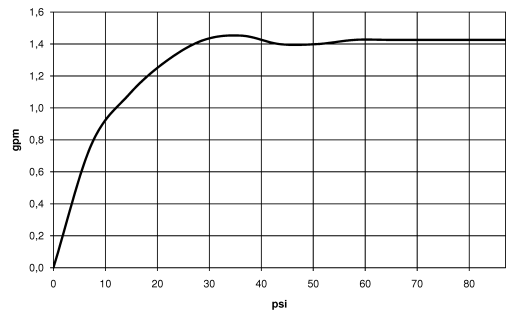

Codes & Standards

California Energy
Commission
(CEC)

33 805 682



Spare parts list

| No. | Item Number | Name | Quantity used | Delivery time |
|--|--------------------|------------|---------------|---------------|
| 1 | 90 28 22 282 01-08 | spout | 1 | - |
| Spare part can no longer be ordered, please order the replacement item | | | | |
| 2 | 09 19 86 012-08 | cover | 1 | 60 |
| 3 | 90 23 10 128 00 90 | nut | 1 | 2 |
| 4 | 90 15 05 042 00 90 | cartridge | 1 | 2 |
| 5 | 09 24 04 266 90 | nut | 1 | 2 |
| 6 | 90 28 30 052 00-08 | cover | 1 | 40 |
| 7 | 90 20 86 004 00-08 | handle | 1 | 40 |
| 8 | 04 23 10 044 08 90 | fixing set | 1 | 2 |
| 9 | 04 30 04 103 00 90 | hose | 2 | 2 |