

VAIA Single-lever mixer for rinsing/Profi spray - Platinum

VAIA

33 810 809



- 202mm projection
- pivotable spout 360°
- air-enriched flow
- max. flow 5.7 l/min at 3 bar flow pressure
- lead-free
- This product can help a building meet the requirements of Green Building Rating Systems, e.g. LEED®, BREEAM®, DGNB

Single-lever mixer for combining with rinsing/Profi spray only

| | | |
|---|-------------------------------|--------------------|
|  | Platinum | 33 810 809-08 0010 |
|  | Chrome | 33 810 809-00 0010 |
|  | Brushed Platinum | 33 810 809-06 0010 |
|  | Durabrass (23kt Gold) | 33 810 809-09 0010 |
|  | Dark Chrome | 33 810 809-19 0010 |
|  | Brushed Durabrass (23kt Gold) | 33 810 809-28 0010 |
|  | Matte Black | 33 810 809-33 0010 |
|  | Brushed Champagne (22kt Gold) | 33 810 809-46 0010 |
|  | Champagne (22kt Gold) | 33 810 809-47 0010 |
|  | Brushed Chrome | 33 810 809-93 0010 |
|  | Brushed Dark Platinum | 33 810 809-99 0010 |

Recommended miscellaneous



VAIA Rinsing spray set - Platinum 27 718 809-08

Recommended miscellaneous



VAIA AIR SWITCH Control button - Platinum 10 713 809-08

Recommended miscellaneous



VAIA Dispenser with rosette - Platinum 82 434 809-08

Flow rate chart

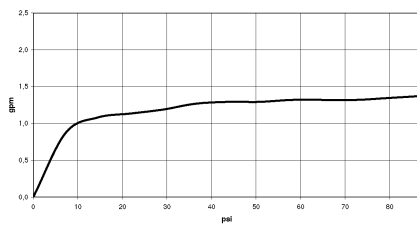

Codes & Standards

California Energy
Commission
(CEC)

33 810 809

Parts for other
finishes can be found
here: [Chrome](#)

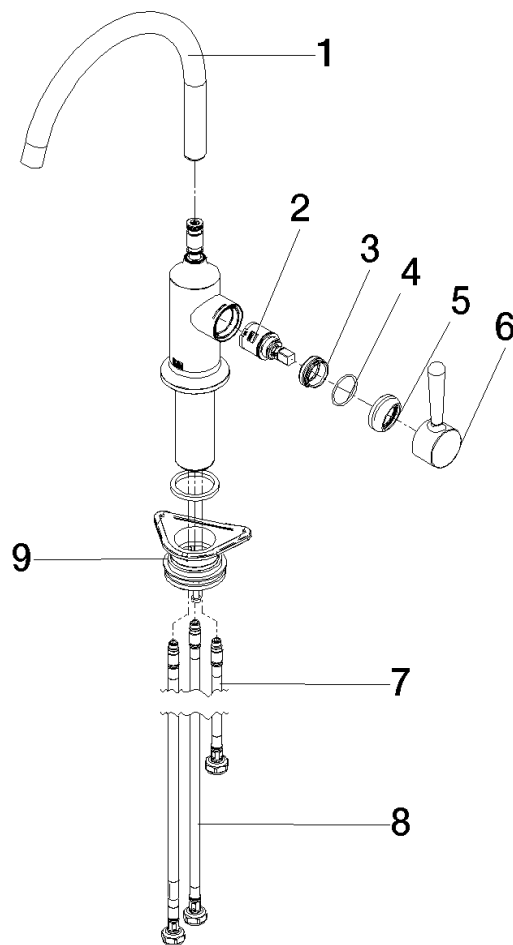

Spare parts list

| No. | Item Number | Name | Quantity used | Delivery time |
|--|--------------------|------------|---------------|---------------|
| 1 | 90 28 22 313 00-08 | spout | 1 | 40 |
| 2 | 90 15 05 042 00 90 | cartridge | 1 | 2 |
| 3 | 09 24 04 266 90 | nut | 1 | 2 |
| 4 | 09 14 10 091 90 | seal | 1 | 2 |
| 5 | 90 28 30 052 00-08 | cover | 1 | 40 |
| 6 | 90 20 80 050 00-08 | handle | 1 | - |
| Spare part can no longer be ordered, please order the replacement item | | | | |
| 7 | 04 30 04 100 00 90 | hose | 1 | 2 |
| 8 | 04 30 04 103 00 90 | hose | 2 | 2 |
| 9 | 04 23 10 044 08 90 | fixing set | 1 | 2 |