

META SQUARE Single-lever mixer - Brushed Dark Platinum

META SQUARE

33 815 861



- 235mm projection
- pivotable spout 360°
- Optional swivel limiter available with swivel limiter set 12 820 970 90
- air-enriched flow
- height of mixer 357 mm
- height up to aerator 282 mm
- hole diameter 35 mm
- 2 x pressure hose with 3/8" cap nut
- max. flow 5.7 l/min at 3 bar flow pressure
- lead-free
- This product can help a building meet the requirements of Green Building Rating Systems, e.g. LEED®, BREEAM®, DGNB

Not possible in combination with rinsing spray.

| | | |
|---|-------------------------------|--------------------|
|  | Brushed Dark Platinum | 33 815 861-99 0010 |
|  | Chrome | 33 815 861-00 0010 |
|  | Brushed Platinum | 33 815 861-06 0010 |
|  | Platinum | 33 815 861-08 0010 |
|  | Durabrand (23kt Gold) | 33 815 861-09 0010 |
|  | Dark Chrome | 33 815 861-19 0010 |
|  | Brushed Durabrand (23kt Gold) | 33 815 861-28 0010 |
|  | Matte Black | 33 815 861-33 0010 |
|  | Brushed Champagne (22kt Gold) | 33 815 861-46 0010 |
|  | Champagne (22kt Gold) | 33 815 861-47 0010 |
|  | Brushed Chrome | 33 815 861-93 0010 |

Recommended miscellaneous

Swivel limitation set -

12 820 970 90



Recommended miscellaneous

AIR SWITCH Control button -
Brushed Dark Platinum

10 713 970-99



Recommended miscellaneous

Dispenser without rosette -
Brushed Dark Platinum

82 424 970-99



33 815 861

mm [inches]

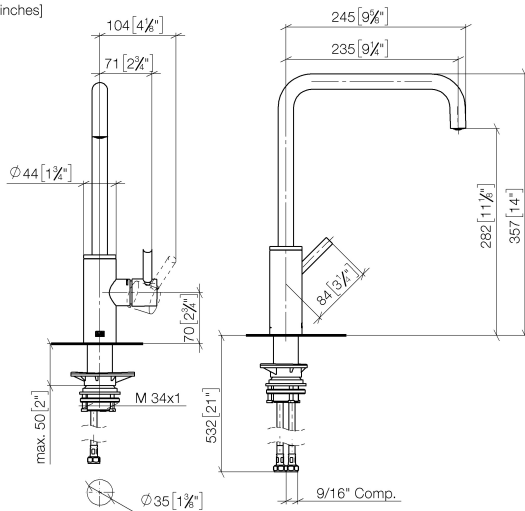

Flow rate chart

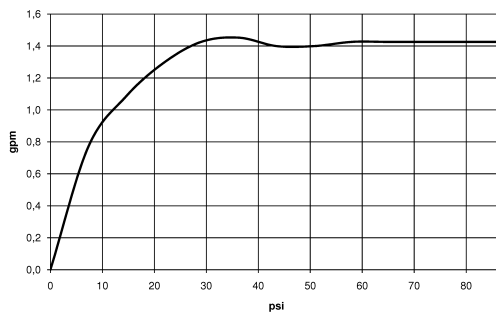

Codes & Standards

California Energy
Commission
(CEC)

33 815 861

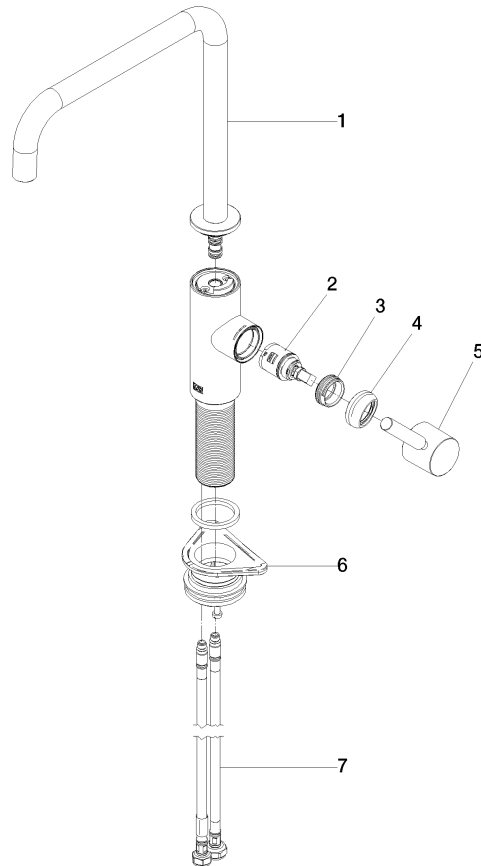

Spare parts list

| No. | Item Number | Name | Quantity used | Delivery time |
|--|--------------------|------------|---------------|---------------|
| 1 | 90 28 22 284 01-99 | spout | 1 | - |
| Spare part can no longer be ordered, please order the replacement item | | | | |
| 2 | 90 15 05 042 00 90 | cartridge | 1 | 2 |
| 3 | 09 24 04 266 90 | nut | 1 | 2 |
| 4 | 90 28 30 052 00-99 | cover | 1 | 30 |
| 5 | 90 20 66 033 00-99 | handle | 1 | 30 |
| 6 | 04 23 10 044 08 90 | fixing set | 1 | 2 |
| 7 | 04 30 04 103 00 90 | hose | 2 | 2 |