

CL.1 Concealed two-way diverter - Brushed Dark Platinum

CL.1

36 200 705



- rotary diverter
- rosette 60 x 60 mm
- with shut-off function

	Brushed Dark Platinum	36 200 705-99 0010
	Chrome	36 200 705-00 0010
	Brushed Platinum	36 200 705-06 0010
	Dark Chrome	36 200 705-19 0010
	Brushed Champagne (22kt Gold)	36 200 705-46 0010
	Champagne (22kt Gold)	36 200 705-47 0010

Required miscellaneous



Concealed two-way diverter -	35 202 970-90
•max. recess depth 160 mm	0010
•min. recess depth 115 mm	



CL.1 Concealed two-way diverter - Brushed Dark Platinum

CL.1

36 200 705

mm [inches]

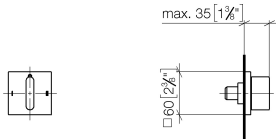

Flow rate chart

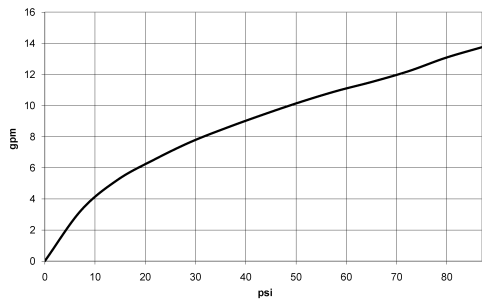

Codes & Standards

ASME A112.18.1	California Energy Commission (CEC)	cUPC
----------------	------------------------------------	------



CL.1 Concealed two-way diverter - Brushed Dark Platinum

CL.1

36 200 705

Certificates

IAPMO_4976

Product version from 4/1/2022

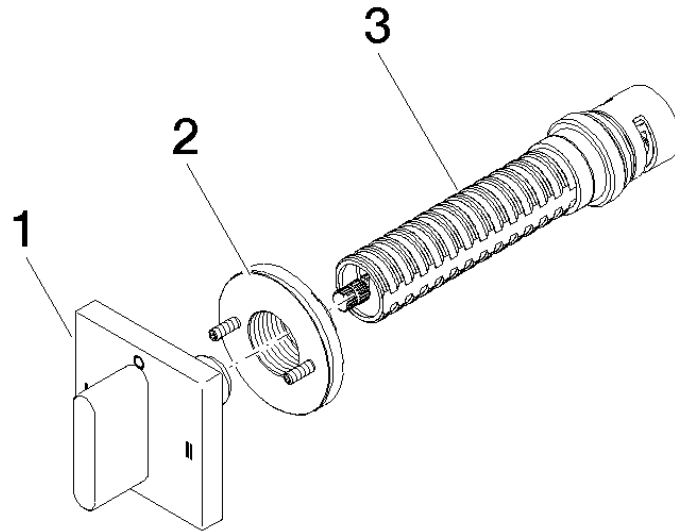



CL.1 Concealed two-way diverter - Brushed Dark Platinum

CL.1

36 200 705

Spare parts list

Product version from 4/1/2022

No.	Item Number	Name	Quantity used	Delivery time
	90 20 70 051 09-99	handle	3	30