





CL.1 Concealed two-way diverter - Brushed Champagne (22kt Gold)

CL.1

36 201 705

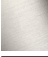

- with WAVES structure
- rotary diverter
- rosette 60 x 60 mm
- with shut-off function

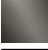
	Brushed Champagne (22kt Gold)	36 201 705-46 0010
	Chrome	36 201 705-00 0010
	Brushed Platinum	36 201 705-06 0010
	Dark Chrome	36 201 705-19 0010
	Champagne (22kt Gold)	36 201 705-47 0010
	Brushed Dark Platinum	36 201 705-99 0010

Required miscellaneous



- Concealed two-way diverter -**
 - min. recess depth 115 mm
 - max. recess depth 160 mm

35 202 970-90
0010

CL.1 Concealed two-way diverter - Brushed Champagne (22kt Gold)

CL.1

36 201 705

mm [inches]

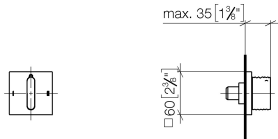

Flow rate chart

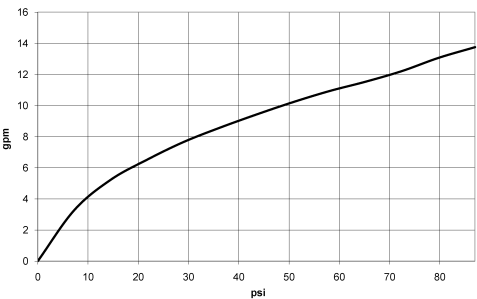

Codes & Standards

California Energy
Commission
(CEC)

Product version from 4/1/2022

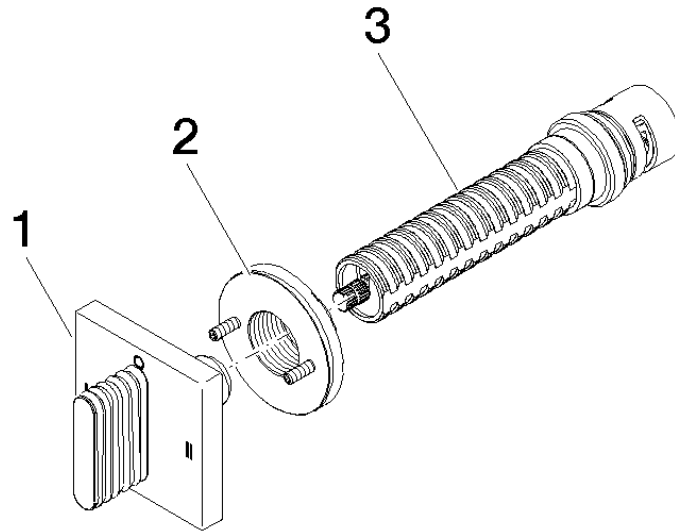



CL.1 Concealed two-way diverter - Brushed Champagne (22kt Gold)

CL.1

36 201 705

Spare parts list

Product version from 4/1/2022

No.	Item Number	Name	Quantity used	Delivery time
	90 20 70 055 09-46	handle	3	30