

Wall valve - Brushed Platinum











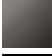

CL.1

36 310 740

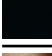
- without rosette
- handle Ø 60mm

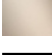

Fits: CL.1, META

	Brushed Platinum	36 310 740-06
	Chrome	36 310 740-00
	Platinum	36 310 740-08
	Dark Chrome	36 310 740-19
	Light Gold	36 310 740-26
	Brushed Light Gold	36 310 740-27
	Brushed Durabrass (23kt Gold)	36 310 740-28
	Matte Black	36 310 740-33
	Brushed Bronze	36 310 740-42
	Brushed Champagne (22kt Gold)	36 310 740-46
	Champagne (22kt Gold)	36 310 740-47
	Brushed Chrome	36 310 740-93
	Brushed Dark Platinum	36 310 740-99

Required miscellaneous



- Wall valve clockwise closing 1/2" - 35 621 970-90**
 •min. recess depth 65 mm 0010
 •max. recess depth 130 mm

36 310 740

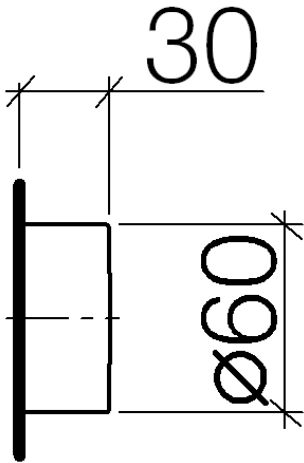

Flow rate chart



36 310 740

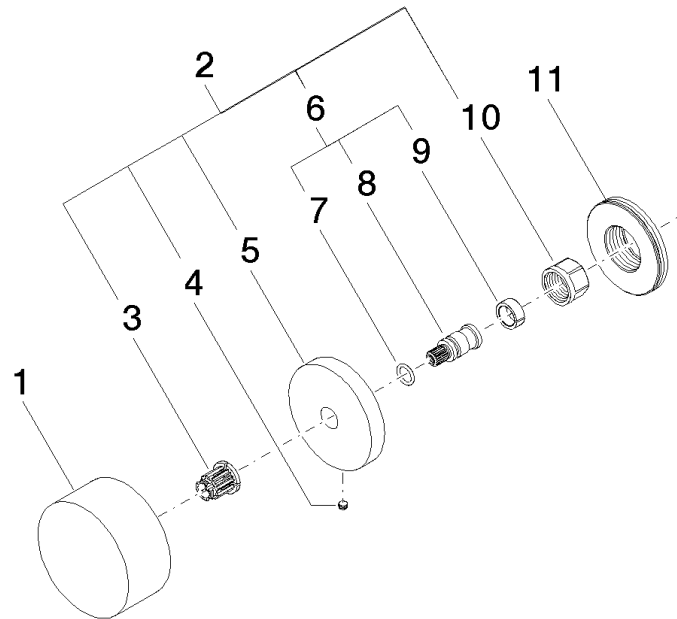

Spare parts list

No.	Item Number	Name	Quantity used	Delivery time
1	09 20 74 004-06	handle	1	60
2	04 27 74 002 00-06	rosette	1	10
3	90 12 12 002 00 90	fixing cap	1	2
4	09 31 11 055 90	pin	1	2
5	09 27 74 002-06	rosette	1	60
6	04 29 06 020 00-00	spindle	1	10
7	90 14 10 060 00 90	seal	1	2
8	09 29 06 020-06	spindle	1	-
Spare part can no longer be ordered, please order the replacement item				
9	90 14 15 020 03 90	ring	1	2
10	90 23 30 023 00 90	nut	1	2
11	09 30 01 107 90	sleeve	1	2