

WATER BAR Concealed body spray FlowReduce - Light Gold

IMO

36 517 979

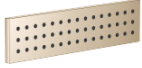

- HORIZONTAL RAIN, max. flow rate 6 l/min (at 3 bar)
- with anti-scale system
- cover plate 240 x 60 mm
- 1/2" connection
- This product can help a building meet the requirements of Green Building Rating Systems, e.g. LEED®, BREEAM®, DGNB
- WRAS 1304001

Fits: IMO, LULU, MADISON, MEM, TARA, CL.1, LISSÉ, VAIA, META, CYO

| | | |
|--|--------------------------------|---------------|
|  | Light Gold | 36 517 979-26 |
|  | Chrome | 36 517 979-00 |
|  | Brushed Platinum | 36 517 979-06 |
|  | Platinum | 36 517 979-08 |
|  | Dark Chrome | 36 517 979-19 |
|  | Brushed Light Gold | 36 517 979-27 |
|  | Brushed Durabronze (23kt Gold) | 36 517 979-28 |
|  | Matte Black | 36 517 979-33 |
|  | Brushed Bronze | 36 517 979-42 |
|  | Brushed Champagne (22kt Gold) | 36 517 979-46 |
|  | Champagne (22kt Gold) | 36 517 979-47 |
|  | Brushed Chrome | 36 517 979-93 |
|  | Brushed Dark Platinum | 36 517 979-99 |

Required miscellaneous



- Concealed wall installation box -** 35 206 970-90
- min. recess depth 100 mm
 - max. recess depth 173 mm

Recommended miscellaneous



- xGRID Attachment set for integrating in the dry wall construction -** 12 340 970 90

Required miscellaneous



- xGRID Installation track 555 mm -** 12 360 970 90

36 517 979

mm [inches]

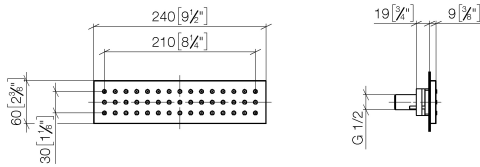

Flow rate chart

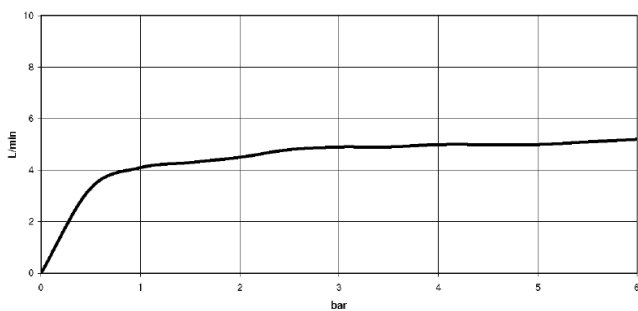

Trajectory diagram

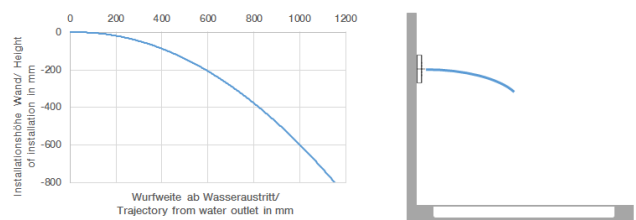

Codes & Standards

ASME
A112.18.1/CSA
B125.1

California Energy
Commission
(CEC)

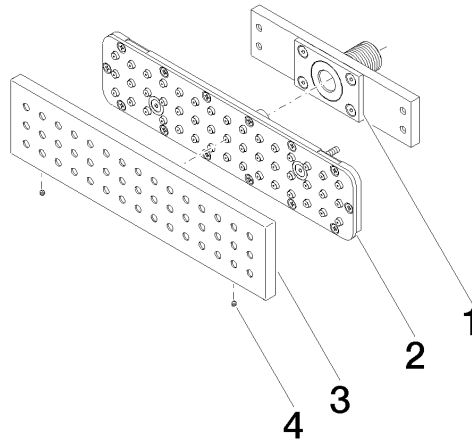



WATER BAR Concealed body spray FlowReduce - Light Gold

IMO

36 517 979

Spare parts list