

ST 050 304 7360



- shower with fixed riser projection 420mm
- Rain shower: PURE RAIN, max. flow rate 6.8 l/min (at 3 bar)
- rain shower Ø 200 mm
- rain shower with anti-scale system
- Hand shower: Three or five settings: COMPACT RAIN, COMPACT SOFT FLOW, COMPACT AQUAPRESSURE FLOW, max. flow rate 6.8 l/min (at 3 bar)
- spray head Ø 95mm
- rotary diverter for fixed-riser shower/hand shower
- height of fittings up to rain shower (bottom edge) 985mm
- height of fittings up to top edge of elbow 1160mm
- two-part push-on rosette Ø 65 mm
- rosette for shower holder Ø 65mm
- rosette for wall mounting Ø 60mm
- gauge 150 mm - 13 mm
- metal shower hose 1250mm with integrated anti-twist protection
- 1/2" connection

**This article does not include a hand shower!**

**Intrinsic protection against back flow.**

**NOTE: Hand shower sold separately. Please see hand shower options under the miscellaneous articles section of each series.**

	Brushed Dark Platinum	ST 050 304 7360-99 0010
	Chrome	ST 050 304 7360-00 0010
	Brushed Platinum	ST 050 304 7360-06 0010
	Platinum	ST 050 304 7360-08 0010
	Durabrand (23kt Gold)	ST 050 304 7360-09 0010
	Brushed Durabrand (23kt Gold)	ST 050 304 7360-28 0010

### Individual components of this set

You need the following components for this set

1x 11 420 360-99



1x 28 002 978-99 0010



1x 34 459 360-99 0010







MADISON Showerpipe with shower thermostat - Brushed Dark Platinum

MADISON

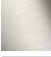
ST 050 304 7360



	Brushed Dark Platinum	11 420 360-9
	Chrome	11 420 360-0
	Brushed Platinum	11 420 360-0
	Platinum	11 420 360-0
	Durabrand (23kt Gold)	11 420 360-0
	Brushed Durabrand (23kt Gold)	11 420 360-2



MADISON Showerpipe with shower thermostat - Brushed Dark Platinum

MADISON

ST 050 304 7360

19  
—  
10  
—  
16  
—  
18  
—  
19  
—  
18  
—



## MADISON Showerpipe with shower thermostat - Brushed Dark Platinum

---

MADISON

ST 050 304 7360



## MADISON Showerpipe with shower thermostat - Brushed Dark Platinum

---

MADISON

ST 050 304 7360

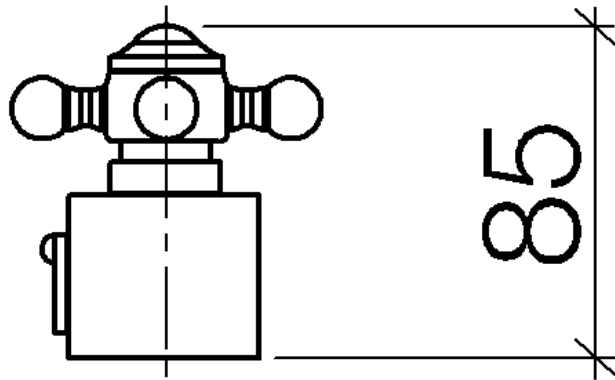



## MADISON Showerpipe with shower thermostat - Brushed Dark Platinum

---

MADISON

ST 050 304 7360

Parts for other  
finishes can be found  
here: [Chrome](#)

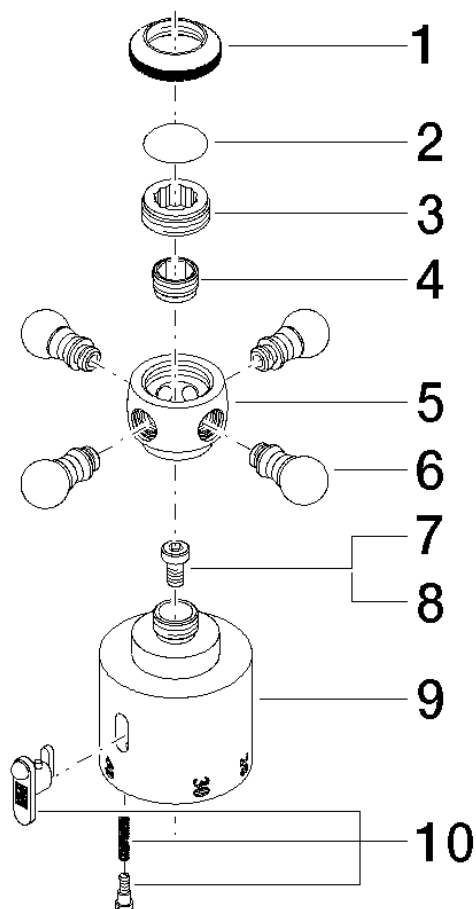





MADISON Showerpipe with shower thermostat - Brushed Dark Platinum

MADISON

ST 050 304 7360

Spare parts list

No.	Item Number	Name	Quantity used	Delivery time
	09 20 36 005-99	handle	13	30

# MADISON Showerpipe with shower thermostat - Brushed Dark Platinum







MADISON

ST 050 304 7360



- Three settings: COMPACT RAIN, COMPACT SOFT FLOW, COMPACT AQUAPRESSURE FLOW, max. flow rate 6.8 l/min (at 3 bar)
- with anti-scale system
- spray head Ø 95mm
- 1/2" connection
- This product can help a building meet the requirements of Green Building Rating Systems, e.g. LEED®, BREEAM®, DGNB

Intrinsic protection against back flow.

	Brushed Dark Platinum	28 002 978-99 001
	Chrome	28 002 978-00 001
	Brushed Platinum	28 002 978-06 001
	Platinum	28 002 978-08 001
	Durabrand (23kt Gold)	28 002 978-09 001
	Brushed Durabrand (23kt Gold)	28 002 978-28 001
	Brushed Chrome	28 002 978-93 001



MADISON Showerpipe with shower thermostat - Brushed Dark Platinum

MADISON

ST 050 304 7360

0  
—  
0  
—  
0  
—  
0  
—  
0  
—  
0  
—  
0  
—

ST 050 304 7360

mm [inches]

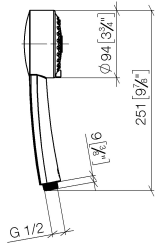

Flow rate chart

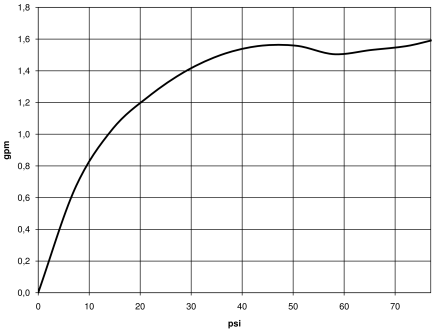

Certificates

IAPMO\_4976

LGA\_18

IAPMO\_11

Codes & Standards

ASME A112.18.1	California Energy Commission (CEC)	cUPC	DIN 4109
EPA WaterSense	ISO 3822	Ü-Zeichen	Water Sense
WaterSense			



## MADISON Showerpipe with shower thermostat - Brushed Dark Platinum

---

MADISON

ST 050 304 7360

Parts for other  
finishes can be found  
here: [Chrome](#)

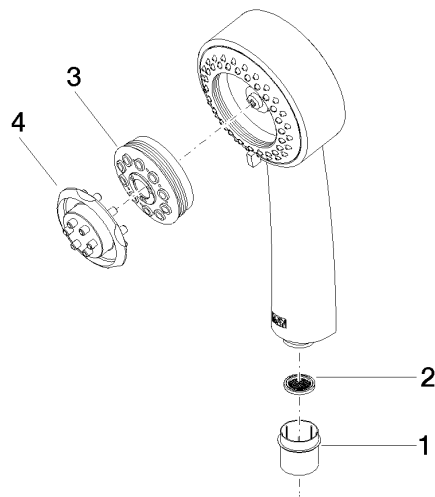



MADISON Showerpipe with shower thermostat - Brushed Dark Platinum

MADISON

ST 050 304 7360

Spare parts list

No.	Item Number	Name	Quantity used	Delivery time
	09 21 02 115 90	cap	4	2



ST 050 304 7360



- shower with fixed riser projection 420mm
- overhead shower: rain flow
- rain shower Ø 200 mm
- rain shower with anti-scale system
- max. rainshower flow 6.8 l/min
- rotary diverter for fixed-riser shower/hand shower
- height of fittings up to rain shower (bottom edge) 985mm
- height of fittings up to top edge of elbow 1160mm
- two-part push-on rosette Ø 65 mm
- rosette for shower holder Ø 65mm
- rosette for wall mounting Ø 60mm
- gauge 150 mm - 13 mm
- metal shower hose 1250mm with integrated anti-twist protection
- 1/2" connection
- Pipe diameter 20 mm

- This product reduces water consumption by % (compared to requirements of EPAct '92)
  - This product can contribute to Water Use Reduction in LEED® Green Building Rating
- Intrinsic protection against back flow.**

**NOTE: Hand shower sold separately. Please see hand shower options under the miscellaneous articles section of each series.**

Intrinsic protection against back flow.

NOTE: Hand shower sold separately. Please see hand shower options under the miscellaneous articles section of each series.

	Brushed Dark Platinum	34 459 360-99 001
	Chrome	34 459 360-00 001
	Brushed Platinum	34 459 360-06 001
	Platinum	34 459 360-08 001
	Durabrand (23kt Gold)	34 459 360-09 001
	Brushed Durabrand (23kt Gold)	34 459 360-28 001

ST 050 304 7360

0  
—  
0  
—  
0  
—  
0  
—  
0  
—  
0  
—

Required miscellaneous

	<b>Concealed adapter -</b>	35 080 970-90
	●please order two adapters (USA only)	0010

ST 050 304 7360

1:10

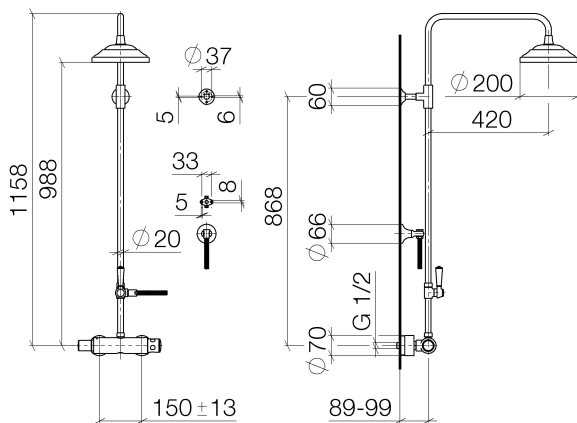

### Flow rate chart

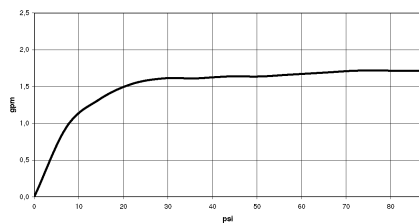

Codes & Standards

ASME	California Energy
A112.18.1/CSA	Commission
B125.1	(CEC)

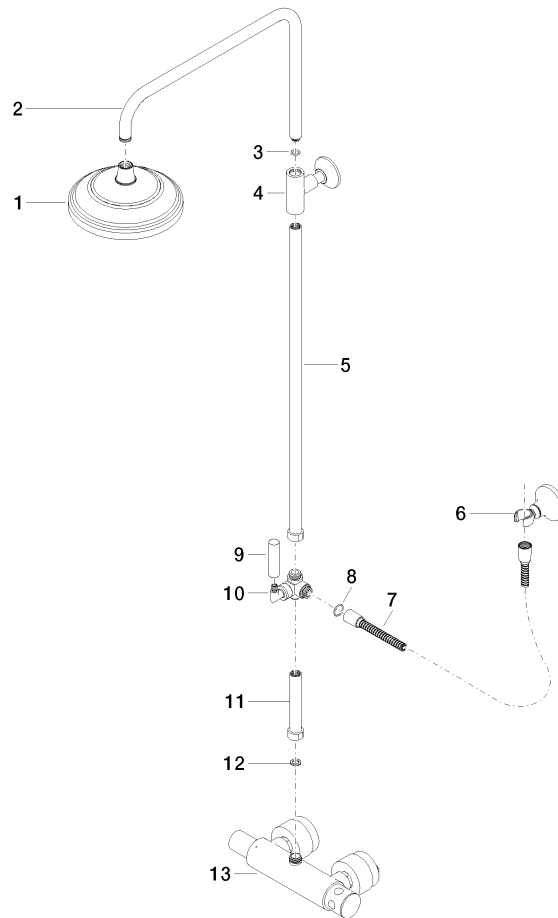

ST 050 304 7360

Spare parts list

No.	Item Number	Name	Quantity used	Delivery time
	04 12 05 038 30-99	shower	17	30