

# VAIA Two-hole bridge mixer with rinsing spray set - Chrome

VAIA

ST 110 202 2809



- 241mm projection
- pivotable spout 360°
- air-enriched flow and spray flow
- automatic spout/shower diverter
- height of mixer 354 mm
- height up to aerator 241 mm
- hole diameter rinsing spray 32mm
- 2 x pressure hose with 3/8" cap nut
- fabric braided hose 1500 mm
- sprayface with anti-scaling system
- max. flow 5.6 l/min at 3 bar flow pressure
- lead-free
- This product can help a building meet the requirements of Green Building Rating Systems, e.g. LEED®, BREEAM®, DGNB

|  |                               |                         |
|--|-------------------------------|-------------------------|
|  | Chrome                        | ST 110 202 2809-00 0010 |
|  | Brushed Platinum              | ST 110 202 2809-06 0010 |
|  | Platinum                      | ST 110 202 2809-08 0010 |
|  | Durabrass (23kt Gold)         | ST 110 202 2809-09 0010 |
|  | Dark Chrome                   | ST 110 202 2809-19 0010 |
|  | Brushed Durabrass (23kt Gold) | ST 110 202 2809-28 0010 |
|  | Matte Black                   | ST 110 202 2809-33 0010 |
|  | Brushed Champagne (22kt Gold) | ST 110 202 2809-46 0010 |
|  | Champagne (22kt Gold)         | ST 110 202 2809-47 0010 |
|  | Brushed Chrome                | ST 110 202 2809-93 0010 |
|  | Brushed Dark Platinum         | ST 110 202 2809-99 0010 |

## Individual components of this set

You need the following components for this set



1x 19 815 809-00 0010



1x 27 718 809-00

## VAIA Two-hole bridge mixer with rinsing spray set - Chrome

VAIA

ST 110 202 2809



- 241mm projection
- pivotable spout 360°
- air-enriched flow
- max. flow 5.7 l/min at 3 bar flow pressure
- lead-free
- This product can help a building meet the requirements of Green Building Rating Systems, e.g. LEED®, BREEAM®, DGNB

|  |                               |                   |
|--|-------------------------------|-------------------|
|  | Chrome                        | 19 815 809-00 001 |
|  | Brushed Platinum              | 19 815 809-06 001 |
|  | Platinum                      | 19 815 809-08 001 |
|  | Durabrand (23kt Gold)         | 19 815 809-09 001 |
|  | Dark Chrome                   | 19 815 809-19 001 |
|  | Brushed Durabrand (23kt Gold) | 19 815 809-28 001 |
|  | Matte Black                   | 19 815 809-33 001 |
|  | Brushed Champagne (22kt Gold) | 19 815 809-46 001 |
|  | Champagne (22kt Gold)         | 19 815 809-47 001 |
|  | Brushed Chrome                | 19 815 809-93 001 |
|  | Brushed Dark Platinum         | 19 815 809-99 001 |





#### Codes & Standards

---

California Energy  
Commission  
(CEC)

**Product version from 7/1/2023**

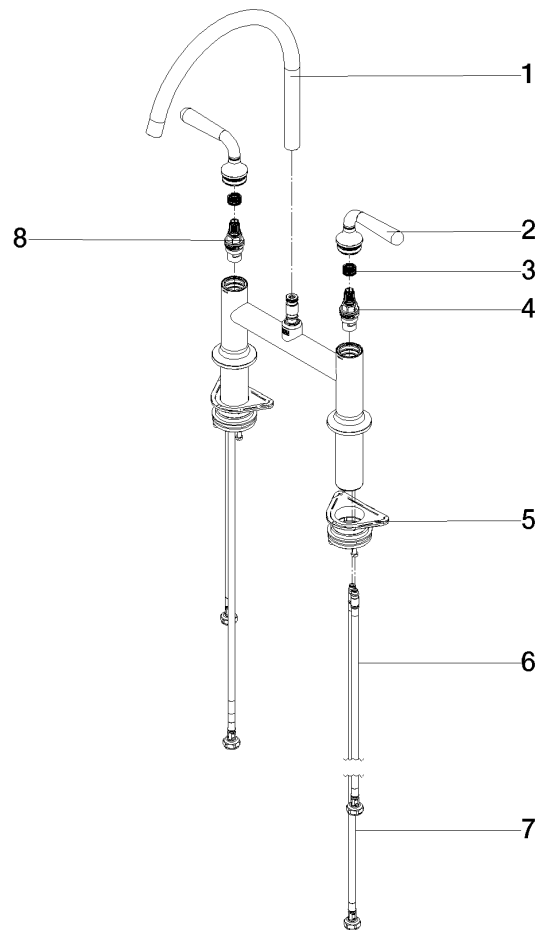



VAIA Two-hole bridge mixer with rinsing spray set - Chrome

VAIA

ST 110 202 2809

**Spare parts list**

**Product version from 7/1/2023**

| No. | Item Number        | Name  | Quantity used | Delivery time |
|-----|--------------------|-------|---------------|---------------|
|     | 90 28 22 396 01-00 | spout | 13            | 10            |

## VAIA Two-hole bridge mixer with rinsing spray set - Chrome

VAIA

ST 110 202 2809



- with round rosette
- spray flow
- automatic spout/shower diverter
- height of mixer 171 mm
- hole diameter rinsing spray 32mm
- fabric braided hose 1500 mm
- sprayface with anti-scaling system
- lead-free
- This product can help a building meet the requirements of Green Building Rating Systems, e.g. LEED®, BREEAM®, DGNB

Can only be combined with 33810809, 33826809, 19815809, 19825809.

Intrinsic protection against back flow.

Residual water may emerge from the spray after closing.

Operating unit can be positioned freely.

Button has to be pressed while using.

|  |                               |              |
|--|-------------------------------|--------------|
|  | Chrome                        | 27 718 809-0 |
|  | Brushed Platinum              | 27 718 809-0 |
|  | Platinum                      | 27 718 809-0 |
|  | Durabrand (23kt Gold)         | 27 718 809-0 |
|  | Dark Chrome                   | 27 718 809-1 |
|  | Brushed Durabrand (23kt Gold) | 27 718 809-2 |
|  | Matte Black                   | 27 718 809-3 |
|  | Brushed Champagne (22kt Gold) | 27 718 809-4 |
|  | Champagne (22kt Gold)         | 27 718 809-4 |
|  | Brushed Chrome                | 27 718 809-9 |
|  | Brushed Dark Platinum         | 27 718 809-9 |





VAIA Two-hole bridge mixer with rinsing spray set - Chrome

VAIA

ST 110 202 2809

0  
—  
6  
—  
8  
—  
9  
—  
9  
—  
8  
—  
3  
—  
6  
—  
7  
—  
3  
—  
9  
—

ST 110 202 2809

mm [inches]

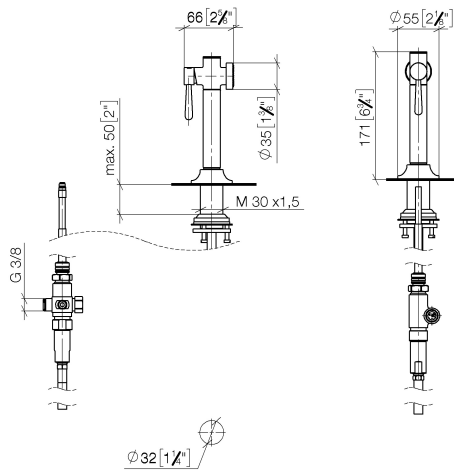

### Flow rate chart

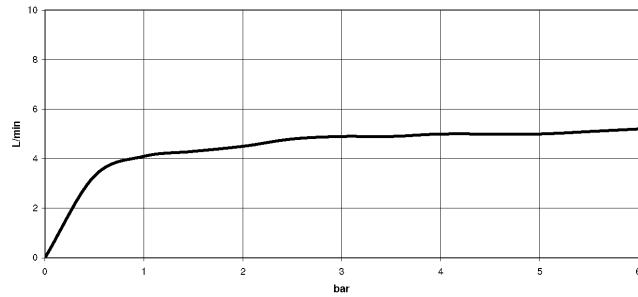

### Certificates

LGA\_38

Codes & Standards

DIN 4109

ISO 3822

Ü-Zeichen



**Product version from 7/1/2023**

Parts for other  
finishes can be found  
here: Brushed  
Platinum





VAIA Two-hole bridge mixer with rinsing spray set - Chrome

VAIA

ST 110 202 2809

**Spare parts list**

**Product version from 7/1/2023**

| No. | Item Number        | Name   | Quantity used | Delivery time |
|-----|--------------------|--------|---------------|---------------|
|     | 90 12 11 096 12-00 | shower | 8             | 60            |