







**IMO Bath spout for wall mounting - Chrome**

IMO

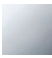
13 801 670

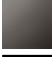

- 200mm projection
- rectangular normal flow
- hole diameter 37 mm
- 1/2" connection
- max. flow 25.1 l/min at 3 bar flow pressure

	Chrome	13 801 670-00
	Brushed Platinum	13 801 670-06
	Dark Chrome	13 801 670-19
	Brushed Light Gold	13 801 670-27
	Matte Black	13 801 670-33
	Brushed Chrome	13 801 670-93

**Required miscellaneous**

**Concealed adapter -**

35 080 970-90  
0010



13 801 670

mm [inches]



**Flow rate chart**



**Codes & Standards**

ASME  
A112.18.1/CSA  
B125.1



## IMO Bath spout for wall mounting - Chrome

---

IMO

13 801 670

### Certificates

---

IAPMO\_4976 (6).    WRAS\_2005002.

13 801 670

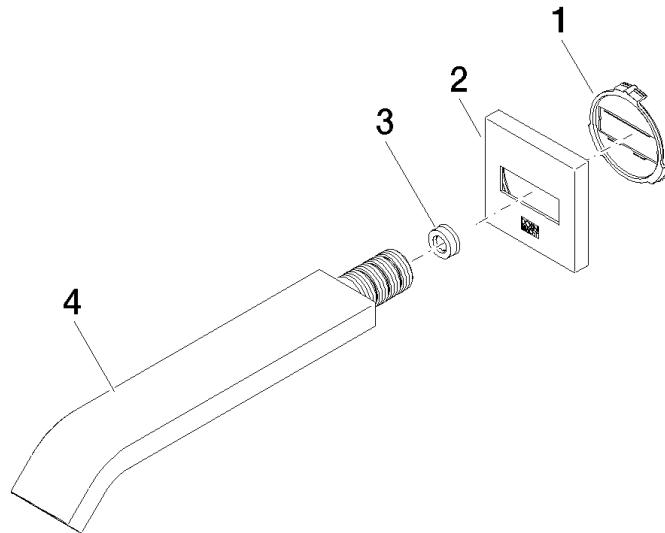

### Spare parts list

No.	Item Number	Name	Quantity used	Delivery time
1	09 18 40 139 90	base	1	2
2	09 27 67 008-00	rosette	1	10
3	09 23 01 057 90	flow reducer	1	2
4	04 28 22 241 00-00	spout	1	10