

28 012 979 Product version from 4/1/2024



- Four settings: COMPACT RAIN, COMPACT SOFT FLOW, COMPACT AQUAPRESSURE FLOW, COMPACT CASCADE, max. flow rate 6.8 l/min (at 3 bar)
- with anti-scale system
- spray head Ø 120mm
- 1/2" connection
- This product reduces water consumption by 28% (compared to requirements of EPAct '92)
- This product can contribute to Water Use Reduction in LEED® Green Building Rating
- This product can help a building meet the requirements of Green Building Rating Systems, e.g. LEED®, BREEAM®, DGNB

Intrinsic protection against back flow.

|   |                               |                    |
|---|-------------------------------|--------------------|
|    | Chrome                        | 28 012 979-00 0010 |
|    | Brushed Platinum              | 28 012 979-06 0010 |
|    | Platinum                      | 28 012 979-08 0010 |
|    | Dark Chrome                   | 28 012 979-19 0010 |
|    | Light Gold                    | 28 012 979-26 0010 |
|    | Brushed Light Gold            | 28 012 979-27 0010 |
|    | Brushed Durabrass (23kt Gold) | 28 012 979-28 0010 |
|    | Matte Black                   | 28 012 979-33 0010 |
|    | Brushed Bronze                | 28 012 979-42 0010 |
|    | Brushed Champagne (22kt Gold) | 28 012 979-46 0010 |
|   | Champagne (22kt Gold)         | 28 012 979-47 0010 |
|  | Brushed Chrome                | 28 012 979-93 0010 |
|  | Brushed Dark Platinum         | 28 012 979-99 0010 |

28 012 979 Product version from 4/1/2024

mm [inches]

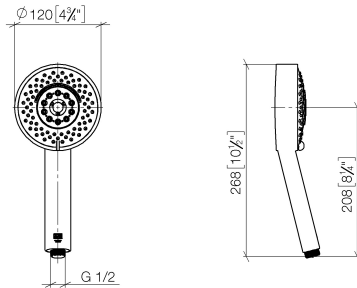

Codes & Standards

|                |                                    |           |          |
|----------------|------------------------------------|-----------|----------|
| ASME A112.18.1 | California Energy Commission (CEC) | cUPC      | DIN 4109 |
| EN 1112        | ISO 3822                           | Ü-Zeichen |          |

Certificates and sustainability

|                 |        |              |
|-----------------|--------|--------------|
| DVGW_DW-6517DN0 | LGA_29 | IAPMO_4976 ( |
|-----------------|--------|--------------|

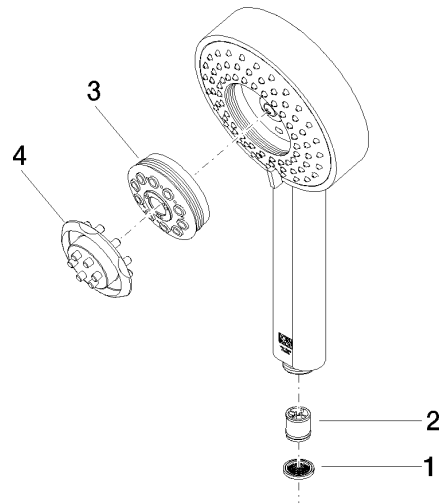

### Spare parts list

| No. | Item Number        | Name         | Quantity used | Delivery time |
|-----|--------------------|--------------|---------------|---------------|
| 3   | 04 12 11 071 00 90 | shower       | 1.00          | 2             |
| 4   | 09 30 09 022 90    | key          | 1.00          | 2             |
| 2   | 09 23 01 166 90    | flow reducer | 1.00          | 2             |
| 1   | 09 23 01 039 90    | sieve        | 1.00          | 2             |