

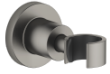











28 050 892

• rosette Ø 55 mm

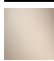

|   |                                |               |
|---|--------------------------------|---------------|
|    | Brushed Dark Platinum          | 28 050 892-99 |
|    | Chrome                         | 28 050 892-00 |
|    | Brushed Platinum               | 28 050 892-06 |
|    | Platinum                       | 28 050 892-08 |
|    | Dark Chrome                    | 28 050 892-19 |
|    | Brushed Durabronze (23kt Gold) | 28 050 892-28 |
|    | Matte Black                    | 28 050 892-33 |
|    | Brushed Bronze                 | 28 050 892-42 |
|   | Brushed Champagne (22kt Gold)  | 28 050 892-46 |
|  | Champagne (22kt Gold)          | 28 050 892-47 |
|  | Cyprus                         | 28 050 892-49 |
|  | Brushed Chrome                 | 28 050 892-93 |

28 050 892

mm [inches]



28 050 892

Parts for other finishes can be found here: [Chrome](#)

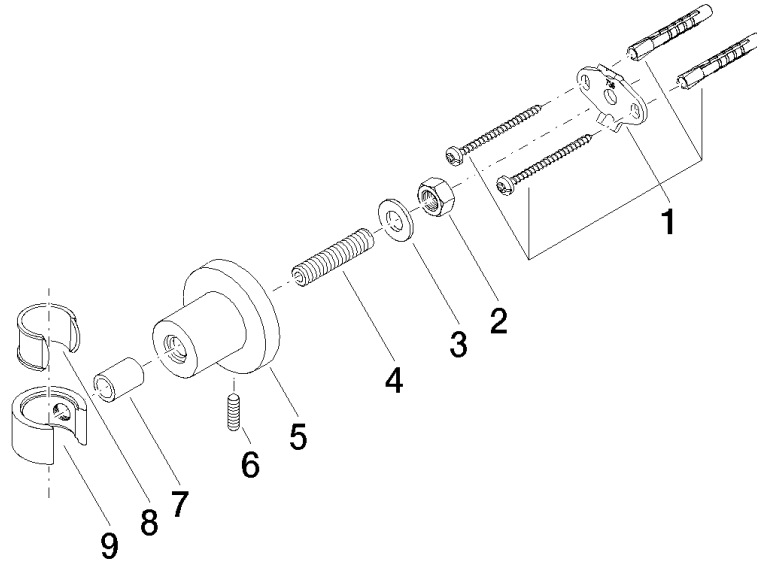

### Spare parts list

| No. | Item Number        | Name       | Quantity used | Delivery time |
|-----|--------------------|------------|---------------|---------------|
| 1   | 05 17 20 739 00 90 | fixing set | 1             | 2             |
| 2   | 09 23 10 026 90    | nut        | 1             | 2             |
| 3   | 09 30 11 046 90    | disc       | 1             | 2             |
| 4   | 08 18 50 586 90    | screw      | 1             | 2             |
| 5   | 08 17 89 505-99    | holder     | 1             | 30            |
| 6   | 04 31 11 113 00 90 | pin        | 1             | 2             |
| 7   | 08 17 20 624-99    | holder     | 1             | 30            |
| 8   | 90 18 40 035 00 90 | sleeve     | 1             | 2             |
| 9   | 09 17 20 014-99    | holder     | 1             | 30            |