

## Rain shower with ceiling fixing 220 mm - Light Gold

IMO

28 669 970



Fits: IMO, TARA, LISSÉ, VAIA, META, CYO

- PURE RAIN, max. flow rate 6.8 l/min (at 3 bar)
- with anti-scale system
- rain shower Ø 220 mm
- rosette Ø 60 mm optional
- 1/2" connection
- Function from: 6 l/min
- quick clearing
- This product reduces water consumption by % (compared to requirements of EAct '92)
- This product can contribute to Water Use Reduction in LEED® Green Building Rating
- This product can help a building meet the requirements of Green Building Rating Systems, e.g. LEED®, BREEAM®, DGNB

|   |                                     |                    |
|---|-------------------------------------|--------------------|
|    | Light Gold                          | 28 669 970-26 0010 |
|    | Chrome                              | 28 669 970-00 0010 |
|    | Brushed Platinum                    | 28 669 970-06 0010 |
|    | Platinum                            | 28 669 970-08 0010 |
|    | Dark Chrome                         | 28 669 970-19 0010 |
|    | Brushed Light Gold                  | 28 669 970-27 0010 |
|    | Brushed Durabrass<br>(23kt Gold)    | 28 669 970-28 0010 |
|    | Matte Black                         | 28 669 970-33 0010 |
|    | Brushed Bronze                      | 28 669 970-42 0010 |
|   | Brushed<br>Champagne (22kt<br>Gold) | 28 669 970-46 0010 |
|  | Champagne (22kt<br>Gold)            | 28 669 970-47 0010 |
|  | Brushed Chrome                      | 28 669 970-93 0010 |
|  | Brushed Dark<br>Platinum            | 28 669 970-99 0010 |

### Required miscellaneous



- |                               |               |
|-------------------------------|---------------|
| <b>Concealed wall elbow -</b> | 35 085 970-90 |
| •min. recess depth 90 mm      | 0010          |
| •max. recess depth 163 mm     |               |

28 669 970

mm [inches]

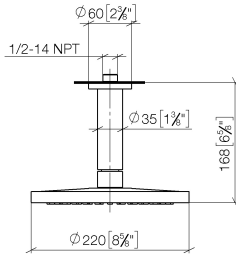

Flow rate chart



Codes & Standards

|                                 |  |
|---------------------------------|--|
| ASME<br>A112.18.1/CSA<br>B125.1 | California Energy<br>Commission<br>(CEC) |
|---------------------------------|--|

28 669 970

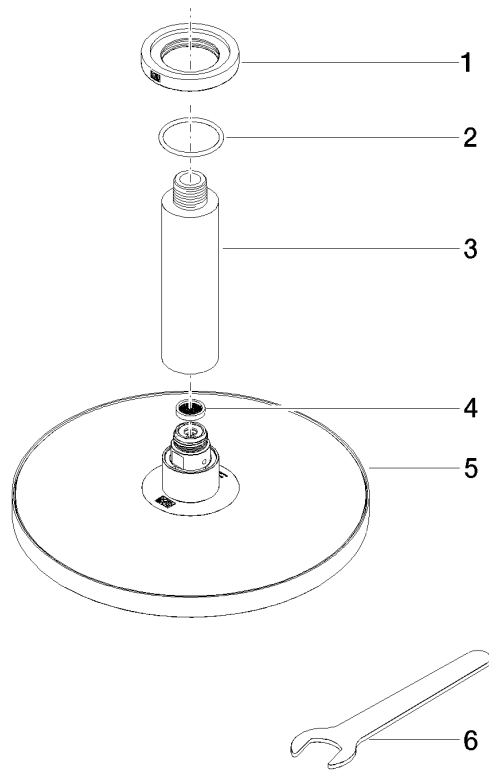

Spare parts list

| No. | Item Number        | Name       | Quantity used | Delivery time |
|-----|--------------------|------------|---------------|---------------|
| 1   | 09 27 22 040-26    | rosette    | 1             | 60            |
| 2   | 09 14 10 141 90    | seal       | 1             | 2             |
| 3   | 09 11 03 080-26    | connection | 1             | 60            |
| 4   | 09 23 01 075 90    | insert     | 1             | 2             |
| 5   | 04 12 05 092 10-26 | shower     | 1             | 60            |
| 6   | 90 30 09 069 00 90 | key        | 1             | 2             |