

36 428 892

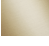
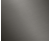

- rotary diverter with volume control and shut-off function
- cover plate Ø 150 mm
- temperature control handle with safety limit stop at 38°C
- hot water temperature limiter, can be preset
- single flow function only

	Platinum	36 428 892-08 0010
	Chrome	36 428 892-00 0010
	Brushed Platinum	36 428 892-06 0010
	Brushed Durabronze (23kt Gold)	36 428 892-28 0010
	Matte Black	36 428 892-33 0010
	Brushed Bronze	36 428 892-42 0010
	Brushed Champagne (22kt Gold)	36 428 892-46 0010
	Champagne (22kt Gold)	36 428 892-47 0010
	Brushed Chrome	36 428 892-93 0010
	Brushed Dark Platinum	36 428 892-99 0010

**Required miscellaneous**



**Concealed thermostat for three-way outlets -** 35 428 970-90 0010  
 ●max. recess depth 136 mm  
 ●min. recess depth 80 mm

**Recommended miscellaneous**



**xGRID Attachment set for integrating in the dry wall construction -** 12 340 970 90

**Required miscellaneous**



**xGRID Installation track 555 mm -** 12 360 970 90

36 428 892

mm [inches]

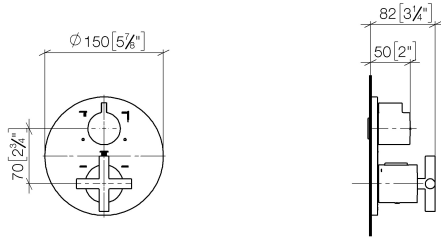

Flow rate chart

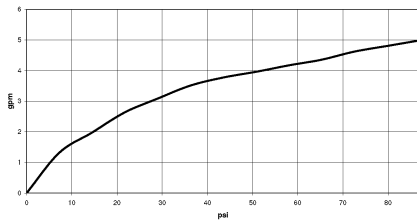

Codes & Standards

ASME A112.18.1

California Energy  
Commission  
(CEC)

cUPC



TARA Concealed thermostat with three function volume control - Platinum

---

TARA

36 428 892

Certificates

---

IAPMO\_4976

36 428 892

Product version from 5/1/2022

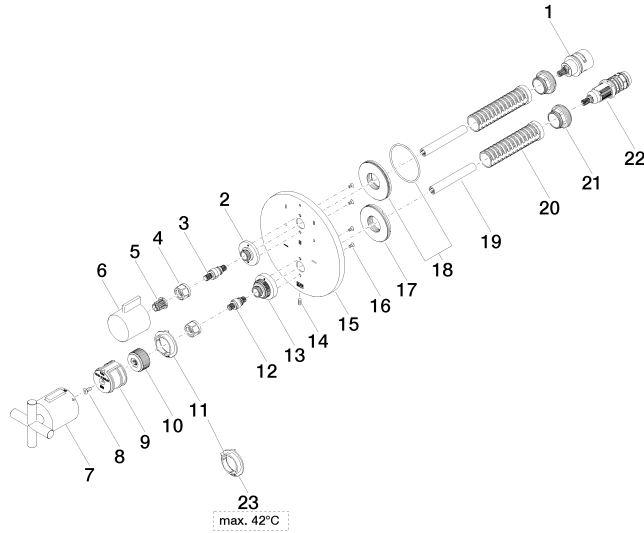



TARA Concealed thermostat with three function volume control - Platinum

TARA

36 428 892

**Spare parts list**

**Product version from 5/1/2022**

No.	Item Number	Name	Quantity used	Delivery time
	90 90 03 170 00 90	diverter	30	2