

TARA Concealed thermostat with three function volume control - Brushed Dark Platinum

TARA

36 428 892



- rotary diverter with volume control and shut-off function
- cover plate Ø 150 mm
- temperature control handle with safety limit stop at 38°C
- hot water temperature limiter, can be preset
- single flow function only

	Brushed Dark Platinum	36 428 892-99 0010
	Chrome	36 428 892-00 0010
	Brushed Platinum	36 428 892-06 0010
	Platinum	36 428 892-08 0010
	Brushed Durabronze (23kt Gold)	36 428 892-28 0010
	Matte Black	36 428 892-33 0010
	Brushed Bronze	36 428 892-42 0010
	Brushed Champagne (22kt Gold)	36 428 892-46 0010
	Champagne (22kt Gold)	36 428 892-47 0010
	Brushed Chrome	36 428 892-93 0010

Required miscellaneous



Concealed thermostat for three-way outlets - 35 428 970-90 0010
 ●max. recess depth 136 mm
 ●min. recess depth 80 mm

Recommended miscellaneous



xGRID Attachment set for integrating in the dry wall construction - 12 340 970 90

Required miscellaneous



xGRID Installation track 555 mm - 12 360 970 90



TARA Concealed thermostat with three function volume control - Brushed Dark Platinum

TARA

36 428 892
mm [inches]

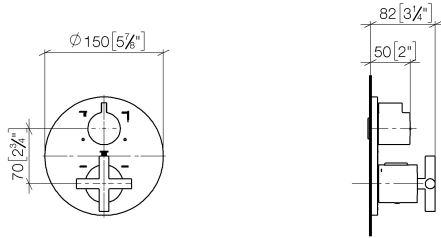

Flow rate chart

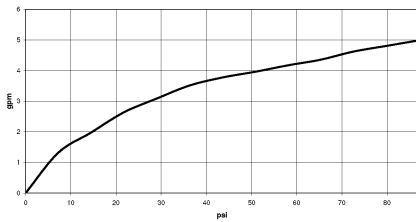

Codes & Standards

ASME A112.18.1

California Energy
Commission
(CEC)

cUPC



TARA Concealed thermostat with three function volume control - Brushed Dark
Platinum

TARA

36 428 892

Certificates

IAPMO_4976

36 428 892

Product version from 5/1/2022

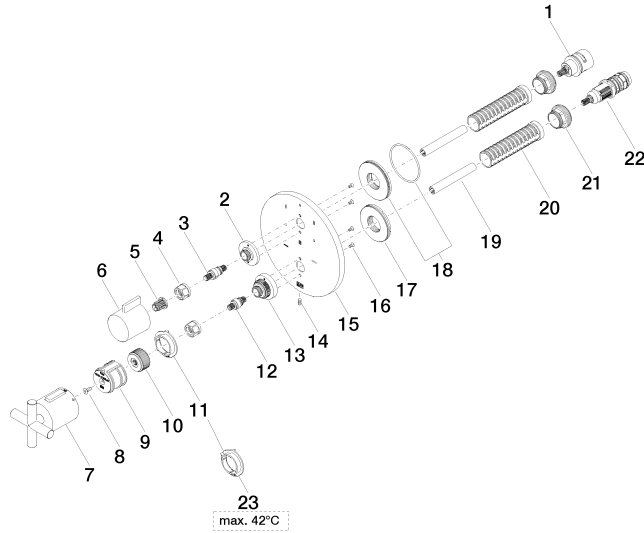



TARA Concealed thermostat with three function volume control - Brushed Dark
Platinum

TARA

36 428 892

Spare parts list

Product version from 5/1/2022

No.	Item Number	Name	Quantity used	Delivery time
	90 90 03 170 00 90	diverter	30	2