





CL.1 Wall valve clockwise closing cold 1/2" - Chrome

CL.1

36 607 706

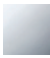

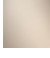
- rosette 60 x 60 mm
- with cold marking
- head part with cut-to-length spindle and sleeve

	Chrome	36 607 706-00
	Brushed Platinum	36 607 706-06
	Dark Chrome	36 607 706-19
	Brushed Champagne (22kt Gold)	36 607 706-46
	Champagne (22kt Gold)	36 607 706-47
	Brushed Dark Platinum	36 607 706-99

Required miscellaneous

	Wall valve 1/2" - •max. recess depth 150 mm •min. recess depth 105 mm	35 607 970-90 0010
---	--	-----------------------

36 607 706

mm [inches]



Codes & Standards

ADA	ASME A112.18.1/CSA B125.1
-----	---------------------------------

Certificates

DVGW_DW- 6501DN0116.	IAPMO_4976 (1).	LGA_29931.	WRAS_2010066.	LGA_29932.
-------------------------	-----------------	------------	---------------	------------

36 607 706

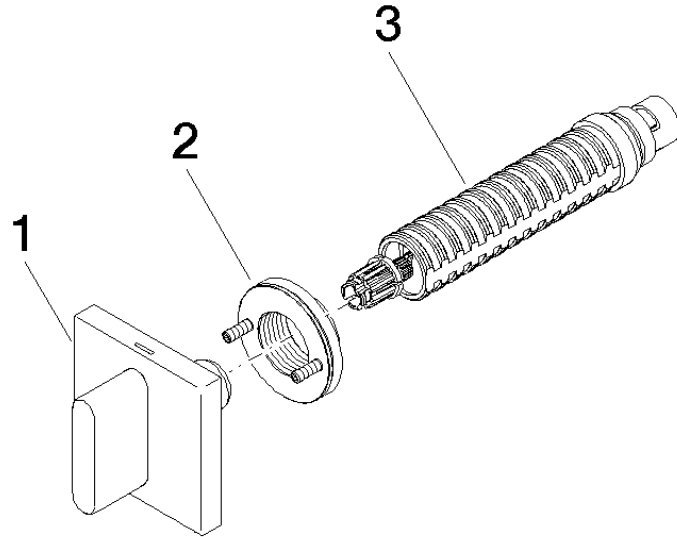

Spare parts list

No.	Item Number	Name	Quantity used	Delivery time
1	90 20 70 051 02-00	handle (cold)	1	10
2	90 21 02 108 00 90	disc	1	2
3	90 90 03 143 00 90	top	1	2