





**CL.1 Wall valve anti-clockwise closing hot 1/2" - Chrome**

CL.1

36 627 707

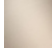

- with CASCADE structure
- rosette 60 x 60 mm
- with hot marking
- head part with cut-to-length spindle and sleeve

	Chrome	36 627 707-00
	Brushed Platinum	36 627 707-06
	Dark Chrome	36 627 707-19
	Brushed Champagne (22kt Gold)	36 627 707-46
	Champagne (22kt Gold)	36 627 707-47
	Brushed Dark Platinum	36 627 707-99

**Required miscellaneous**



**Wall valve 1/2" -** 35 607 970-90  
 •max. recess depth 150 mm 0010  
 •min. recess depth 105 mm

36 627 707

mm [inches]

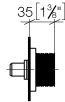

#### Codes & Standards

ADA

ASME  
A112.18.1/CSA  
B125.1

#### Certificates

DVGW\_DW-  
6501DN0116.

IAPMO\_4976 (1).

LGA\_29931.

WRAS\_2010066.

LGA\_29932.

36 627 707

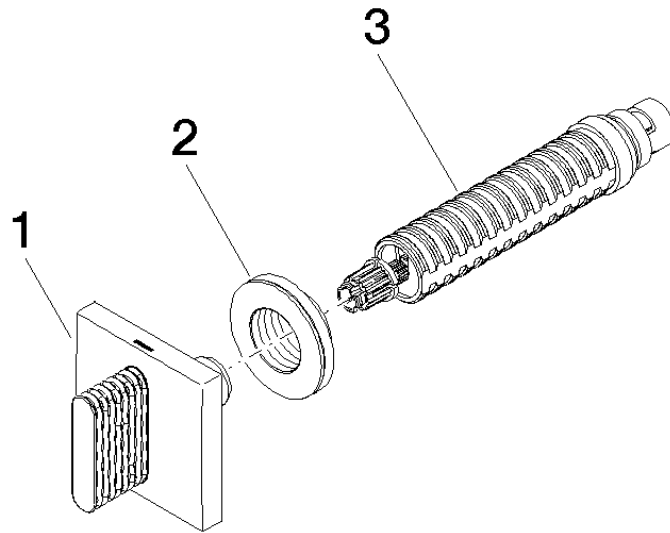

### Spare parts list

No.	Item Number	Name	Quantity used	Delivery time
1	90 20 70 053 03-00	handle ( hot )	1	10
2	09 21 02 108 90	disc	1	60
3	90 90 03 142 00 90	top	1	2