

WATER SHEET Cascade spout for wall mounting - Brushed Platinum
IMO

13 415 979



- 150mm projection
- CASCADE, max. flow rate 26.5 l/min (at 3 bar)
- cover plate 240 x 60 mm
- 1/2" connection
- plug-link mounting
- WRAS 1712702

Brushed Platinum

13 415 979-06

Chrome

13 415 979-00

Platinum

13 415 979-08

Dark Chrome

13 415 979-19

Brushed Durabrass (23kt Gold)

13 415 979-28

Matte Black

13 415 979-33

Brushed Champagne (22kt Gold)

13 415 979-46

Champagne (22kt Gold)

13 415 979-47

Brushed Chrome

13 415 979-93

Brushed Dark Platinum

13 415 979-99

Fits: IMO, LULU, MADISON, MEM, TARA, CL.1, LISSÉ, VAIA, META, CYO

Recommended miscellaneous

	Concealed wall elbow -	35 085 970 90
	•max. recess depth 163 mm	
	•min. recess depth 90 mm	

Recommended miscellaneous

	Concealed wall elbow -	35 085 970 90
	•max. recess depth 163 mm	
	•min. recess depth 90 mm	

13 415 979

mm [inches]

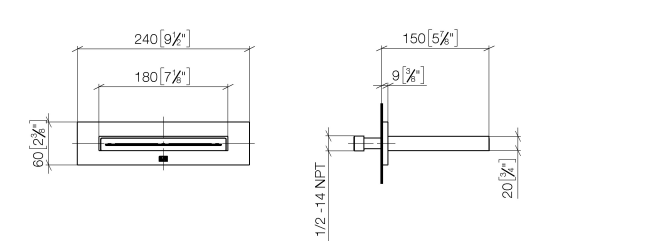

Flow rate chart

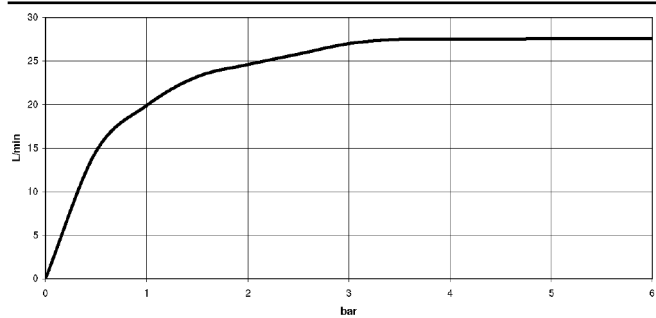

Trajectory diagram

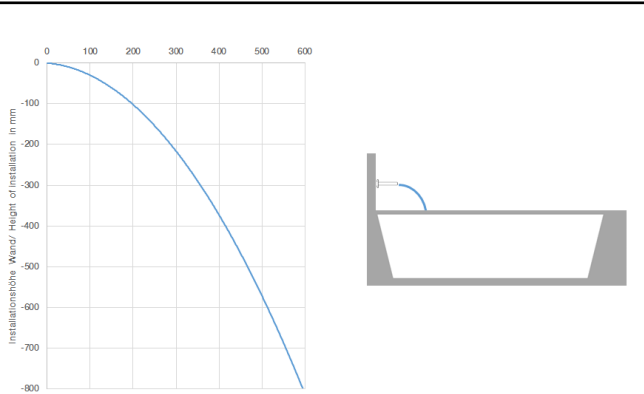

Certificates

LGA_19464. WRAS_2306001. IAPMO_4976 (6).

13 415 979



Spare parts list

No.	Item Number	Name	Quantity used	Delivery time
1	09 23 01 057 90	flow reducer	1	2
2	90 24 03 213 00 90	connection	1	2
3	09 14 03 134 90	seal	1	2
4	04 30 31 024 01 90	fixing set	1	2
5	09 17 97 059 90	holder	1	2
6	09 31 11 036 90	pin	2	2
7	09 31 11 040 90	pin	2	2
8	09 24 03 214 90	nipple	2	2
10	09 11 78 003 20-06	spout	1	10
11	90 29 03 059 00 90	insert	1	2