

## LISSÉ Deck-mounted basin spout without pop-up waste - Brushed Chrome





LISSÉ

13 700 845



- 130mm projection
- fixed spout
- circular, air-enriched flow
- height of mixer 95 mm
- height up to aerator 75 mm
- hole diameter 35 mm
- 1/2" connection
- max. flow 5.7 l/min
- lead-free
- This product can help a building meet the requirements of Green Building Rating Systems, e.g. LEED®, BREEAM®, DGNB
- WRAS 1909064

For Touchfree control please order eSet Touchfree  
WITH or WITHOUT temperature adjustment

	Brushed Chrome	13 700 845-93
	Chrome	13 700 845-00
	Dark Chrome	13 700 845-19
	Matte Black	13 700 845-33
	Brushed Dark Platinum	13 700 845-99

13 700 845

mm [inches]

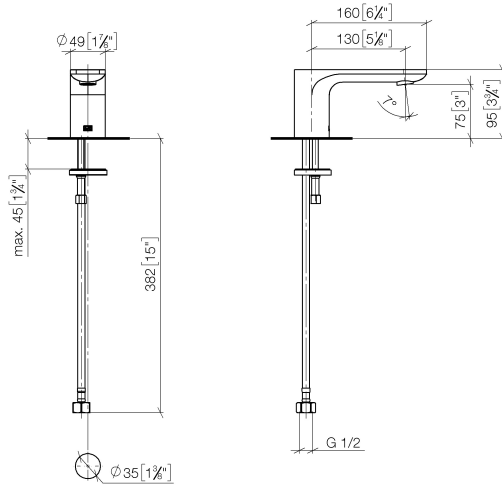

### Flow rate chart

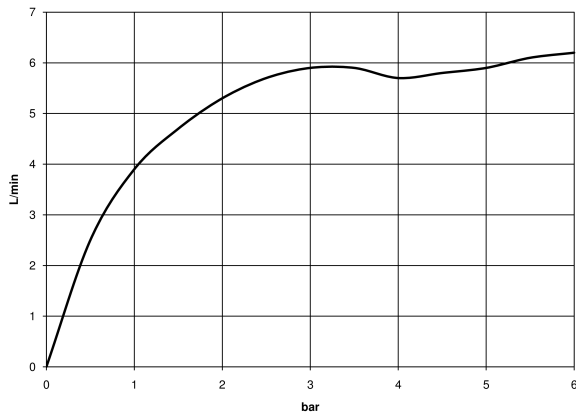

### Codes & Standards

ASME A112.18.1	cUPC	DIN 4109	ISO 3822
NSF372	NSF61	Scottish Water Byelaws	UK Water Supply Regulations

Ü-Zeichen



## LISSÉ Deck-mounted basin spout without pop-up waste - Brushed Chrome

LISSÉ

13 700 845

### Certificates

IAPMO\_4976

WRAS\_1909

IAPMO\_N-4

LGA\_29

IAPMO\_6

**Product version from 3/13/2017**

Parts for other  
finishes can be found  
here: [Chrome](#)

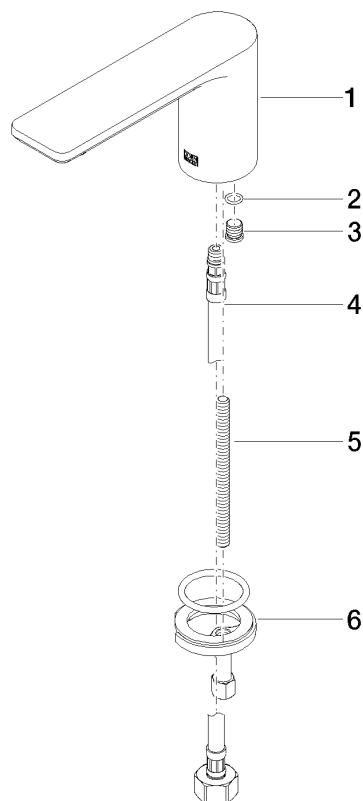



## LISSE Deck-mounted basin spout without pop-up waste - Brushed Chrome

LISSE

13 700 845

### Spare parts list

#### Product version from 3/13/2017

No.	Item Number	Name	Quantity used	Delivery time
	90 11 84 015 00-93	spout	6	20