





CL.1 Wall-mounted basin spout without pop-up waste - Brushed Champagne (22kt Gold)

13 800 705	Product version from 3/9/2015		
	<ul style="list-style-type: none"> • 200mm projection • fixed spout • rectangular spray pattern with 40 individual jets • hole diameter 37 mm • lead-free • 1/2" connection • plug-link mounting • max. flow 4.5 l/min • This product can help a building meet the requirements of Green Building Rating Systems, e.g. LEED®, BREEAM®, DGNB • WRAS 	 <div>Brushed Champagne (22kt Gold)</div>	13 800 705-46
		 <div>Chrome</div>	13 800 705-00
		 <div>Brushed Platinum</div>	13 800 705-06
		 <div>Dark Chrome</div>	13 800 705-19
		 <div>Champagne (22kt Gold)</div>	13 800 705-47
		 <div>Brushed Dark Platinum</div>	13 800 705-99

**CL.1 Wall-mounted basin spout without pop-up waste - Brushed Champagne
(22kt Gold)**

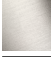
13 800 705 Product version from 3/9/2015
mm [inches]

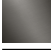
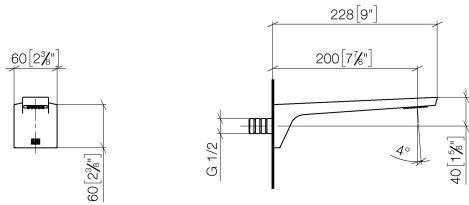

Flow rate chart

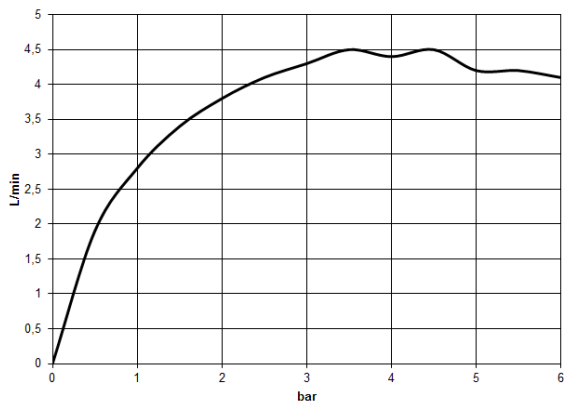

Codes & Standards

ASME A112.18.1	cUPC	NSF372	NSF61
----------------	------	--------	-------



CL.1 Wall-mounted basin spout without pop-up waste - Brushed Champagne
(22kt Gold)

13 800 705 Product version from 3/9/2015

Certificates

IAPMO_N-4	IAPMO_4976	IAPMO_6
-----------	------------	---------

CL.1 Wall-mounted basin spout without pop-up waste - Brushed Champagne (22kt Gold)

13 800 705

Product version from 3/9/2015

Parts for other finishes can be found here: Chrome

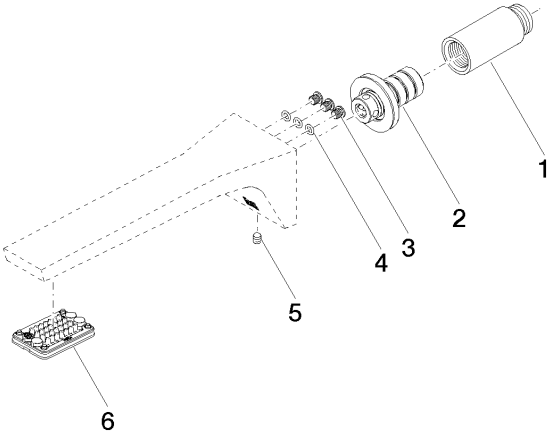

Spare parts list

No.	Item Number	Name	Quantity used	Delivery time
1	09 24 03 081 10 90	extension	1	2
2	90 24 03 108 01 90	nipple set	1	2
3	09 30 30 113 20 90	screw	3	2
4	09 14 10 001 90	seal	3	2
5	90 31 11 004 00 90	pin	1	2
6	90 11 02 297 00 90	aerator	1	2