

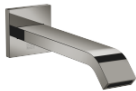









IMO Bath spout for wall mounting - Dark Chrome

13 801 670 Product version from 4/1/2024



- 200mm projection
- rectangular normal flow
- hole diameter 37 mm
- 1/2" connection
- max. flow 25.1 l/min at 3 bar flow pressure
- WRAS

	Dark Chrome	13 801 670-19
	Chrome	13 801 670-00
	Brushed Platinum	13 801 670-06
	Brushed Light Gold	13 801 670-27
	Matte Black	13 801 670-33
	Brushed Chrome	13 801 670-93
	Brushed Dark Platinum	13 801 670-99

Recommended miscellaneous



- Concealed wall elbow -**
- min. recess depth mm
 - max. recess depth mm

35 085 970 90

IMO Bath spout for wall mounting - Dark Chrome

13 801 670 Product version from 4/1/2024

mm [inches]

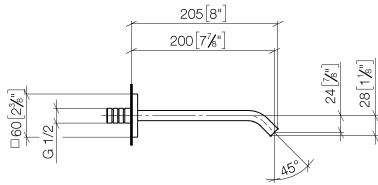

Flow rate chart

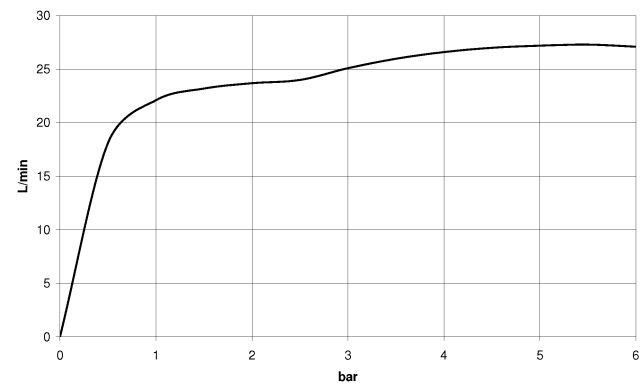

Codes & Standards

ASME A112.18.1 cUPC



IMO Bath spout for wall mounting - Dark Chrome

13 801 670 Product version from 4/1/2024

Certificates

IAPMO_4976

IMO Bath spout for wall mounting - Dark Chrome

13 801 670 Product version from 4/1/2024

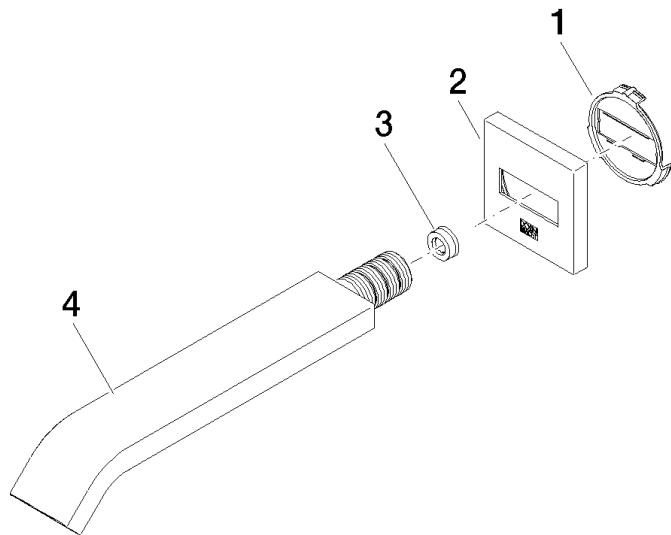

Spare parts list

No.	Item Number	Name	Quantity used	Delivery time
1	09 18 40 139 90	base	1	2
2	09 27 67 008-19	rosette	1	60
3	09 23 01 057 90	flow reducer	1	2
4	04 28 22 241 00-19	spout	1	60