

CYO Deck valve clockwise closing - Platinum / Brushed Platinum







CYO

20 000 811



- hole diameter valve 32 mm
- without rosette
- handle Ø 60mm
- WRAS

NOTE: The handle inserts must be ordered separately from the fittings!

|   |   |               |
|---|---|---------------|
|  | Platinum /<br>Brushed Platinum                | 20 000 811-36 |
|  | Chrome  | 20 000 811-00 |
|  | Brushed Platinum                              | 20 000 811-06 |
|  | Dark Chrome                                   | 20 000 811-19 |
|  | Brushed Durabass<br>(23kt Gold)               | 20 000 811-28 |
|  | Durabass /<br>Brushed Durabass<br>(23kt Gold) | 20 000 811-38 |
|  | Brushed Dark<br>Platinum                      | 20 000 811-99 |

20 000 811

mm [inches]

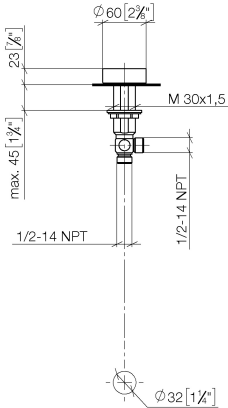

Codes & Standards

|                        |                             |           |       |
|------------------------|-----------------------------|-----------|-------|
| DIN 4109               | ISO 3822                    | NSF372    | NSF61 |
| Scottish Water Byelaws | UK Water Supply Regulations | Ü-Zeichen |       |

Certificates and sustainability

|        |           |         |           |
|--------|-----------|---------|-----------|
| LGA_38 | IAPMO_N-4 | IAPMO_6 | WRAS_2109 |
|--------|-----------|---------|-----------|

20 000 811

Parts for other  
finishes can be found  
here: [Chrome](#)

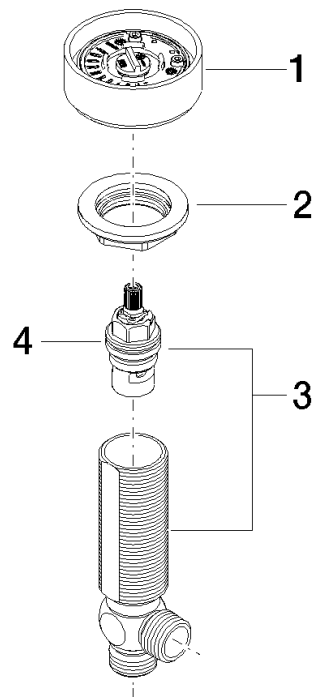

## Spare parts list

| No. | Item Number        | Name       | Quantity used | Delivery time |
|-----|--------------------|------------|---------------|---------------|
| 1   | 90 18 40 291 01-36 | handle     | 1.00          | 20            |
| 2   | 04 30 11 038 68 90 | fixing set | 1.00          | 2             |
| 4   | 90 90 03 237 00 90 | top        | 1.00          | 2             |
| 3   | 04 17 11 055 61 90 | side panel | 1.00          | 2             |