

20 000 980

- hole diameter valve 32 mm
- rosette 60 x 60 mm



20 000 980

mm [inches]

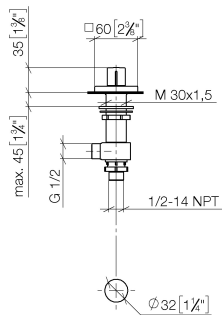

### Flow rate chart

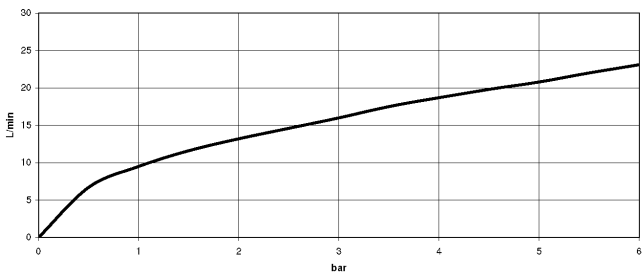

### Codes & Standards

ASME A112.18.1

cUPC

EN 200

NSF372

### VA-Zeichen



SYMETRICS Deck valve anti-clockwise closing cold or hot - Brushed Platinum

IMO

20 000 980

Certificates

ETA\_18

IAPMO\_4976

IAPMO\_6

20 000 980

Product version up to 4/30/2013

**Product version from 4/30/2013**

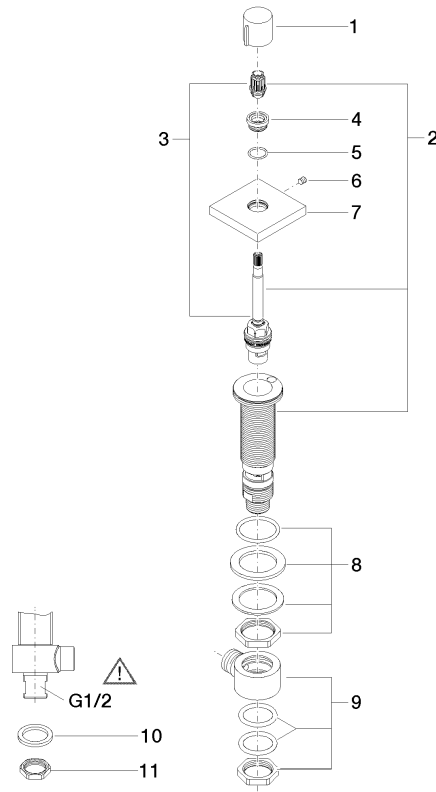



SYMETRICS Deck valve anti-clockwise closing cold or hot - Brushed Platinum

IMO

20 000 980

Spare parts list

Product version up to 4/30/2013

Product version from 4/30/2013

No.	Item Number	Name	Quantity used	Delivery time
	09 20 98 001-06	handle	11	10