

## MEM Three-hole basin mixer with pop-up waste - Brushed Dark Platinum

MEM

20 705 782



- 165mm projection
- fixed spout
- rectangular, air-enriched flow
- height of mixer 144 mm
- height up to aerator 78 mm
- hole diameter spout 35 mm
- hole diameter valve 32 mm
- rosette 60 x 60 mm
- 2x screw-in M 10 x 1 pressure hose, leak-tested
- max. flow 5.7 l/min
- lead-free
- This product can help a building meet the requirements of Green Building Rating Systems, e.g. LEED®, BREEAM®, DGNB
- WRAS 240102004

Only suitable for basins with an overflow.

|  |                                |               |
|--|--------------------------------|---------------|
|  | Brushed Dark Platinum          | 20 705 782-99 |
|  | Chrome                         | 20 705 782-00 |
|  | Brushed Platinum               | 20 705 782-06 |
|  | Platinum                       | 20 705 782-08 |
|  | Dark Chrome                    | 20 705 782-19 |
|  | Brushed Durabronze (23kt Gold) | 20 705 782-28 |
|  | Brushed Champagne (22kt Gold)  | 20 705 782-46 |
|  | Champagne (22kt Gold)          | 20 705 782-47 |

### Recommended miscellaneous



- High pressure hoses -**
- 2x 3/8" x 1/2" x 500mm high pressure hose

12 506 970 90

MEM Three-hole basin mixer with pop-up waste - Brushed Dark Platinum

MEM

20 705 782

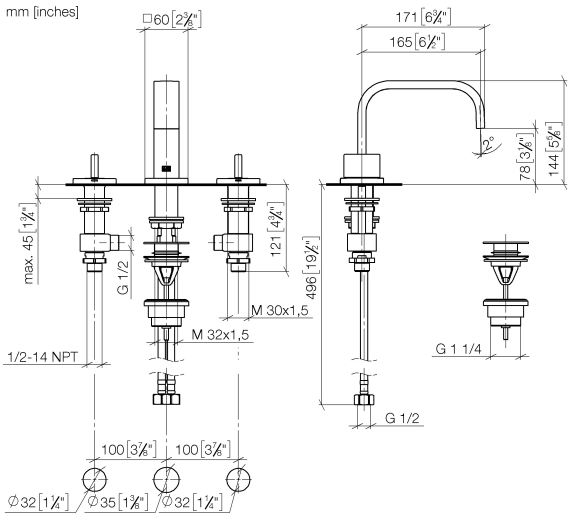

Flow rate chart

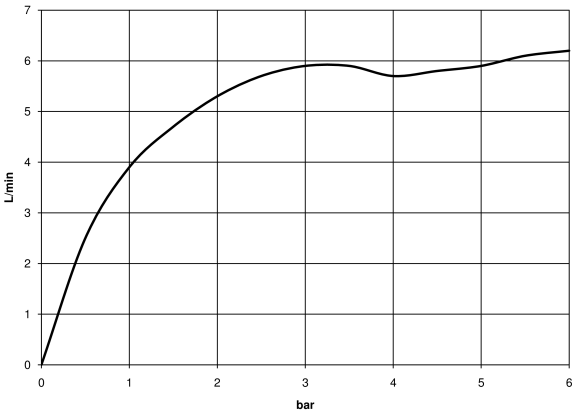

Codes & Standards

|                                |                             |          |                           |
|--------------------------------|-----------------------------|----------|---------------------------|
| DIN 4109                       | Executive Order<br>no. 1007 | ISO 3822 | Scottish Water<br>Byelaws |
| UK Water Supply<br>Regulations | Ü-Zeichen                   |          |                           |



## MEM Three-hole basin mixer with pop-up waste - Brushed Dark Platinum

---

MEM

20 705 782

### Certificates

---

WRAS\_240102

LGA\_38

GDV\_0400

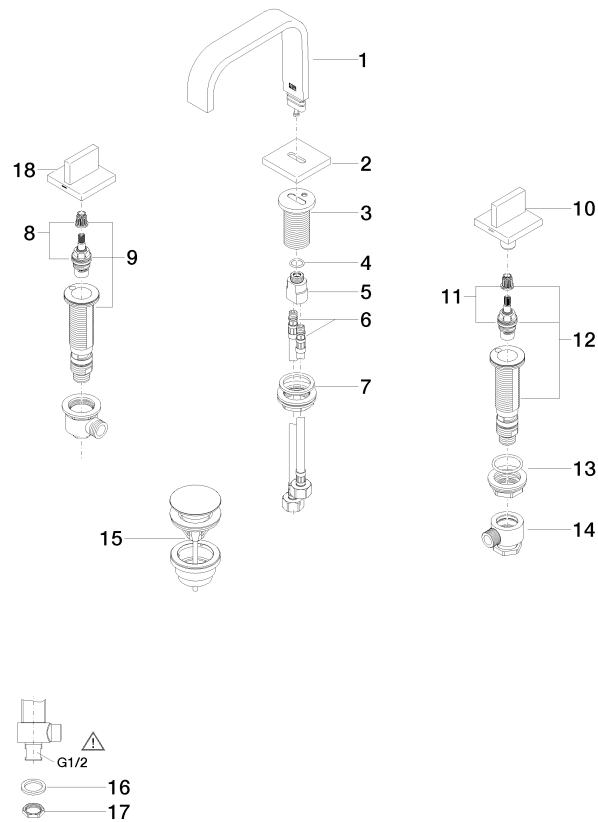



MEM Three-hole basin mixer with pop-up waste - Brushed Dark Platinum

MEM

20 705 782

Spare parts list

| No. | Item Number        | Name  | Quantity used | Delivery time |
|-----|--------------------|-------|---------------|---------------|
|     | 90 28 22 359 00-99 | spout | 23            | 30            |