

## Shower set without hand shower - Brushed Chrome

26 413 979 Product version from 10/1/2023















- COMPACT RAIN, max. flow rate l/min (at 3 bar)

\_x000D\_

- gauge 853 mm
- shower hose connector 3/8"
- metal shower hose 1750mm with integrated anti-twist protection
- slide bar
- Pipe diameter 18 mm
- inherently safe from back flow.
- WRAS

This article does not include a hand shower!

	Brushed Chrome	26 413 979-93
	Chrome	26 413 979-00
	Brushed Platinum	26 413 979-06
	Platinum	26 413 979-08
	Dark Chrome	26 413 979-19
	Light Gold	26 413 979-26
	Brushed Light Gold	26 413 979-27
	Brushed Durabronze (23kt Gold)	26 413 979-28
	Matte Black	26 413 979-33
	Brushed Bronze	26 413 979-42
	Brushed Champagne (22kt Gold)	26 413 979-46
	Champagne (22kt Gold)	26 413 979-47
	Brushed Dark Platinum	26 413 979-99

### Shower set without hand shower - Brushed Chrome

26 413 979 Product version from 10/1/2023

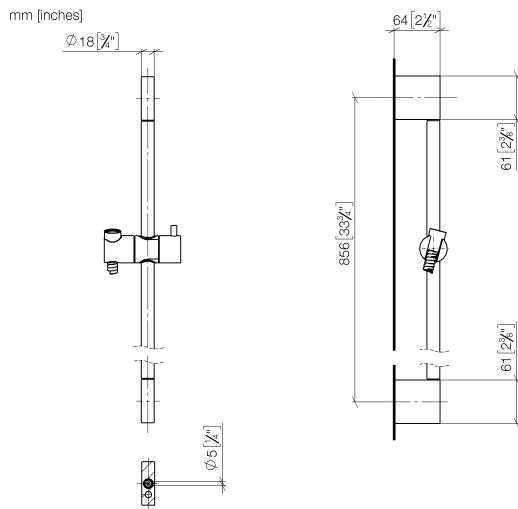

## Codes & Standards

ASME A112.18.1

cUPC

# Scottish Water Byelaws

UK Water Supply Regulations

XP P 41-280

## Certificates

WRAS\_2009

ACS\_20 ACC LY

IAPMO\_4976

## Shower set without hand shower - Brushed Chrome

26 413 979 Product version from 10/1/2023

Parts for other  
finishes can be found  
here: [Chrome](#)

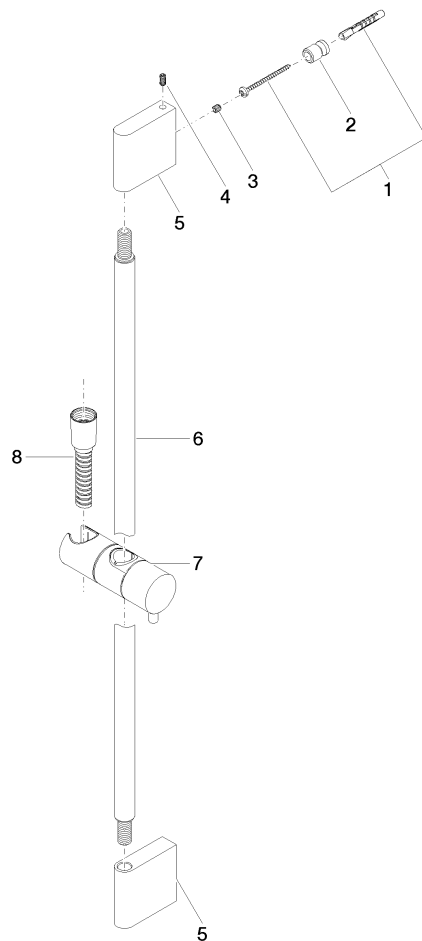

### Spare parts list

No.	Item Number	Name	Quantity used	Delivery time
1	05 17 20 726 02 90	fixing set	2	2
2	08 17 20 726 90	holder	2	2
3	09 31 11 049 90	pin	2	2
4	04 31 11 113 00 90	pin	2	2
5	08 17 97 054-93	holder	2	20
6	90 28 22 597 00-93	holder	1	20
7	12 580 970-93	Slide unit - Brushed Chrome	1	20
8	28 322 970-93	Metal shower hose 1/2" x 3/8" x 1750 mm - Brushed Chrome	1	20