

Shower set without hand shower - Brushed Platinum

IMO

26 413 980



Fits: IMO, MEM, CL.1, CYO

- slide bar
- Pipe diameter 18 mm
- rosette 60 x 60 mm
- gauge 800 mm
- metal shower hose 1750mm with integrated anti-twist protection
- shower hose connector 3/8"
- WRAS 2009048

This article does not include a hand shower!

	Brushed Platinum	26 413 980-06
	Chrome	26 413 980-00
	Platinum	26 413 980-08
	Dark Chrome	26 413 980-19
	Brushed Light Gold	26 413 980-27
	Brushed Durabronze (23kt Gold)	26 413 980-28
	Matte Black	26 413 980-33
	Brushed Champagne (22kt Gold)	26 413 980-46
	Champagne (22kt Gold)	26 413 980-47
	Brushed Chrome	26 413 980-93
	Brushed Dark Platinum	26 413 980-99

Shower set without hand shower - Brushed Platinum

IMO

26 413 980

Recommended miscellaneous



Concealed wall elbow -
 • max. recess depth 163 mm
 • min. recess depth 90 mm

35 085 970 90

Recommended miscellaneous



Wall elbow - Brushed Platinum

28 450 980-06

Required miscellaneous



Hand shower - Brushed Platinum 28 012 979-06

Required miscellaneous



**Hand shower FlowReduce -
Brushed Platinum** 28 016 979-06
0010

Required miscellaneous



Hand shower - Brushed Platinum 28 017 979-06

Required miscellaneous



**Hand shower FlowReduce -
Brushed Platinum** 28 012 979-06
0010

Required miscellaneous



Hand shower - Brushed Platinum 28 016 979-06

Required miscellaneous



Hand shower - Brushed Platinum 28 018 979-06

Required miscellaneous



**Hand shower FlowReduce -
Brushed Platinum** 28 018 979-06
0010

Required miscellaneous



**SERIES-VARIOUS Hand shower -
Brushed Platinum** 28 029 979-06
0010

Required miscellaneous



**SERIES-VARIOUS Hand shower -
Brushed Platinum** 28 029 979-06

Required miscellaneous



**SERIES-VARIOUS Hand shower -
Brushed Platinum** 28 027 979-06
0010

Required miscellaneous



**SERIES-VARIOUS Hand shower -
Brushed Platinum** 28 025 979-06
0010

Shower set without hand shower - Brushed Platinum

IMO

26 413 980

mm [inches]

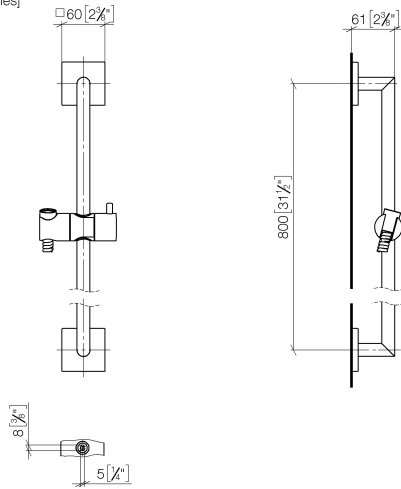

Codes & Standards

ASME A112.18.1

cUPC

Scottish Water
Byelaws

UK Water Supply
Regulations

XP P 41-280

Certificates

IAPMO_4976

WRAS_2009

ACS_20 ACC LY

Product version from 6/1/2024

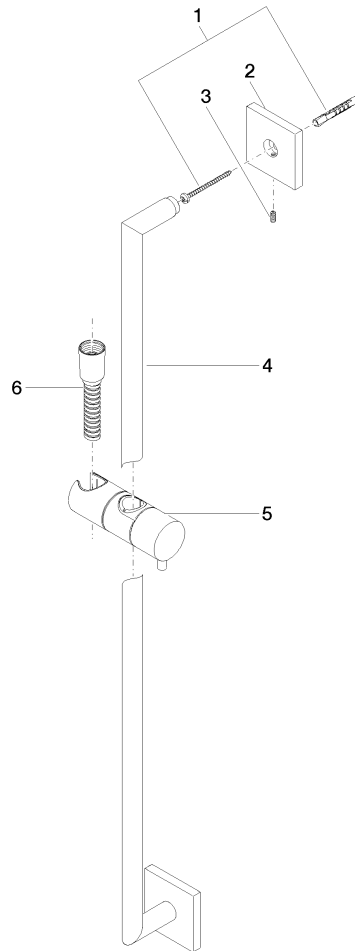



Shower set without hand shower - Brushed Platinum

IMO

26 413 980

Spare parts list

Product version from 6/1/2024

No.	Item Number	Name	Quantity used	Delivery time
	05 30 31 025 00 90	fixing set	9	2