

MADISON Showerpipe with shower mixer without hand shower - Platinum







26 632 360



- shower with fixed riser projection 420mm
- overhead shower: rain flow
- rain shower Ø 200 mm
- max. rainshower flow 14 l/min
- Function from: 8 l/min
- rotary diverter for fixed-riser shower/hand shower
- height of fittings up to top edge of elbow 1180mm
- height of fittings up to rain shower (bottom edge) 1009mm
- rosette for shower holder Ø 66mm
- rosette for wall mounting Ø 70mm
- rosette for shower mixer Ø 60mm
- gauge 150 mm - 13 mm
- metal shower hose 1250mm with integrated anti-twist protection
- 1/2" connection
- Pipe diameter 20 mm
- This product can help a building meet the requirements of Green Building Rating Systems, e.g. LEED®, BREEAM®, DGNB
- WRAS

This article does not include a hand shower!

Intrinsic protection against back flow.

| | | |
|---|-------------------------------|---------------|
|  | Platinum | 26 632 360-08 |
|  | Chrome | 26 632 360-00 |
|  | Brushed Platinum | 26 632 360-06 |
|  | Durabrand (23kt Gold) | 26 632 360-09 |
|  | Brushed Durabrand (23kt Gold) | 26 632 360-28 |
|  | Brushed Dark Platinum | 26 632 360-99 |

Required miscellaneous



- MADISON Hand shower - Platinum**

28 002 978-08

 - spray head Ø 95mm
 - Hand shower see page {PAGE}
 - Three settings: COMPACT RAIN, COMPACT SOFT FLOW, COMPACT AQUAPRESSURE FLOW, max. flow rate l/min (at 3 bar)

Required miscellaneous



- MADISON Hand shower FlowReduce - Platinum**

28 002 978-08 0010

 - spray head Ø 95mm
 - Hand shower see page {PAGE}
 - Three settings: COMPACT RAIN, COMPACT SOFT FLOW, COMPACT AQUAPRESSURE FLOW, max. flow rate l/min (at 3 bar)

Required miscellaneous



- MADISON Metal hand shower with porcelain insert (white) FlowReduce - Platinum**

28 002 970-08 0010

MADISON Showerpipe with shower mixer without hand shower - Platinum

26 632 360

mm [inches]

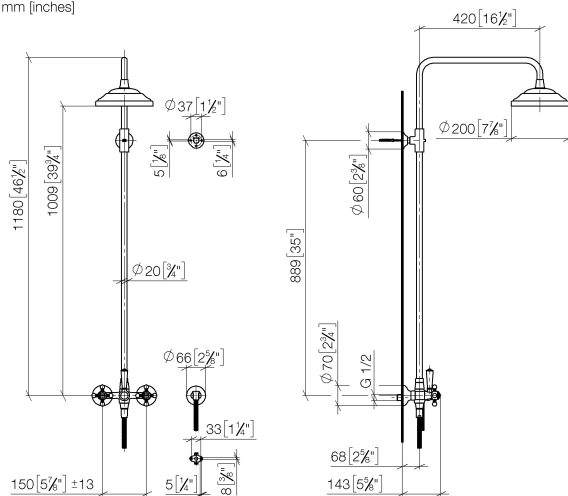

Flow rate chart

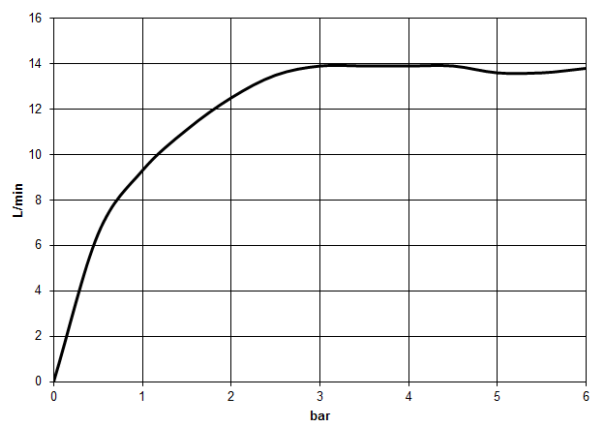

Codes & Standards

DIN 4109

EN 1717

ISO 3822

Scottish Water
Byelaws

UK Water Supply
Regulations

Ü-Zeichen



MADISON Showerpipe with shower mixer without hand shower - Platinum

26 632 360

Certificates

Belgaqua_21-023-2 LGA_29

WRAS_2204

MADISON Showerpipe with shower mixer without hand shower - Platinum

26 632 360

Parts for other
finishes can be found
here: [Chrome](#)

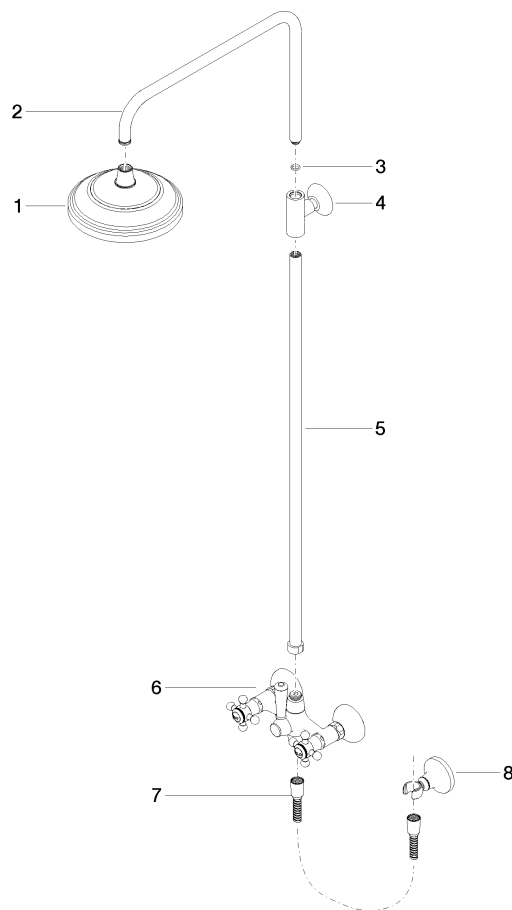

Spare parts list

| No. | Item Number | Name | Quantity used | Delivery time |
|--|--------------------|--|---------------|---------------|
| 1 | 04 12 05 038 01-08 | shower | 1 | 40 |
| 2 | 04 28 22 101 20-08 | spout | 1 | 40 |
| 3 | 90 14 10 011 00 90 | seal | 1 | 2 |
| 4 | 90 17 11 033 00-08 | holder | 1 | - |
| Spare part can no longer be ordered, please order the replacement item | | | | |
| 5 | 90 28 22 096 00-08 | pipe | 1 | - |
| Spare part can no longer be ordered, please order the replacement item | | | | |
| 6 | 04 17 10 001 00-08 | fitting | 1 | 40 |
| 7 | 28 104 970-08 | Metal shower hose 1/2" x 1/2" x 1250 mm - Platinum | 1 | 40 |
| 8 | 28 050 410-08 | holder | 1 | 60 |