

META Bath shower set for bath rim or tile edge installation - Chrome

27 632 661    Product version from 7/1/2023



- spout: circular, air-enriched flow
- max. flow 23.5 l/min at 3 bar flow pressure
- Hand shower: COMPACT RAIN, max. flow rate 6.8 l/min (at 3 bar)
- complete hand shower set with anti-scale system
- automatic bath/shower diverter
- 221mm projection
- height of mixer 319 mm
- height up to aerator 216 mm
- hole diameter spout 35 mm
- hole diameter single-lever mixer 35 mm
- hole diameter for complete hand shower set 32 mm
- rosette for spout Ø 60mm
- rosette for single-lever mixer Ø 55mm
- rosette for complete hand shower set Ø 60mm
- metal shower hose 1750mm with integrated anti-twist protection
- WRAS

Intrinsic protection against back flow.

|   |                               |               |
|---|-------------------------------|---------------|
|    | Chrome                        | 27 632 661-00 |
|    | Brushed Platinum              | 27 632 661-06 |
|    | Dark Chrome                   | 27 632 661-19 |
|    | Light Gold                    | 27 632 661-26 |
|    | Brushed Light Gold            | 27 632 661-27 |
|    | Matte Black                   | 27 632 661-33 |
|    | Brushed Bronze                | 27 632 661-42 |
|    | Brushed Champagne (22kt Gold) | 27 632 661-46 |
|    | Champagne (22kt Gold)         | 27 632 661-47 |
|   | Brushed Chrome                | 27 632 661-93 |
|  | Brushed Dark Platinum         | 27 632 661-99 |

Recommended miscellaneous

|   |                                    |               |
|---|------------------------------------|---------------|
|  | <b>Perfecto installation kit -</b> | 12 614 970 90 |
|---|------------------------------------|---------------|

Recommended miscellaneous

|   |  |               |
|---|--|---------------|
|  | <b>Decorative caps for Perfecto - Chrome</b> | 12 801 970-00 |
|   | • 1 pair                                     |               |

## META Bath shower set for bath rim or tile edge installation - Chrome

27 632 661 Product version from 7/1/2023

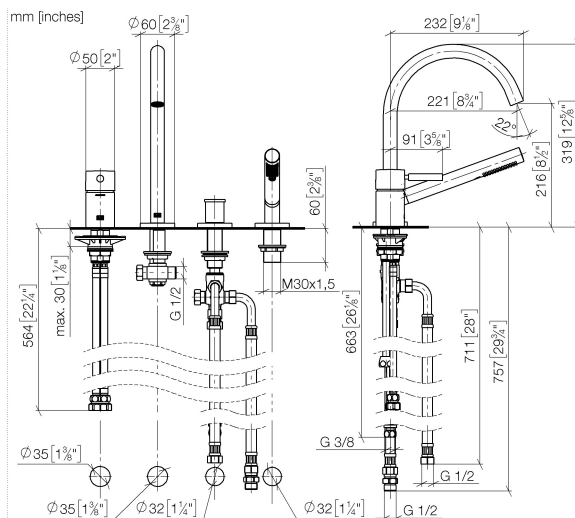

### Flow rate chart

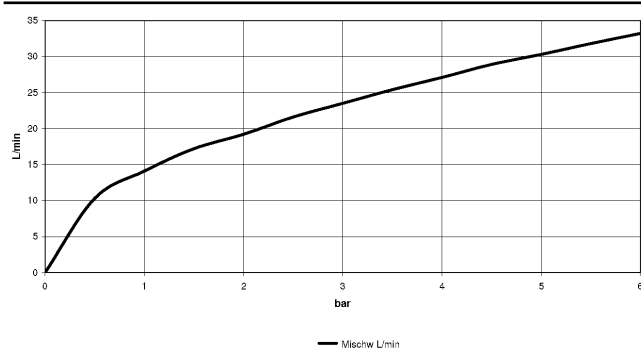

### Codes & Standards

|                |                        |                             |           |
|----------------|------------------------|-----------------------------|-----------|
| ASME A112.18.1 | cUPC                   | DIN 4109                    | EN 1717   |
| ISO 3822       | Scottish Water Byelaws | UK Water Supply Regulations | Ü-Zeichen |



META Bath shower set for bath rim or tile edge installation - Chrome

---

27 632 661 Product version from 7/1/2023

Certificates

---

|        |           |            |                   |
|--------|-----------|------------|-------------------|
| LGA_38 | WRAS_2207 | IAPMO_4976 | Belgaqua_21-026-2 |
|--------|-----------|------------|-------------------|

# META Bath shower set for bath rim or tile edge installation - Chrome

27 632 661    Product version from 7/1/2023

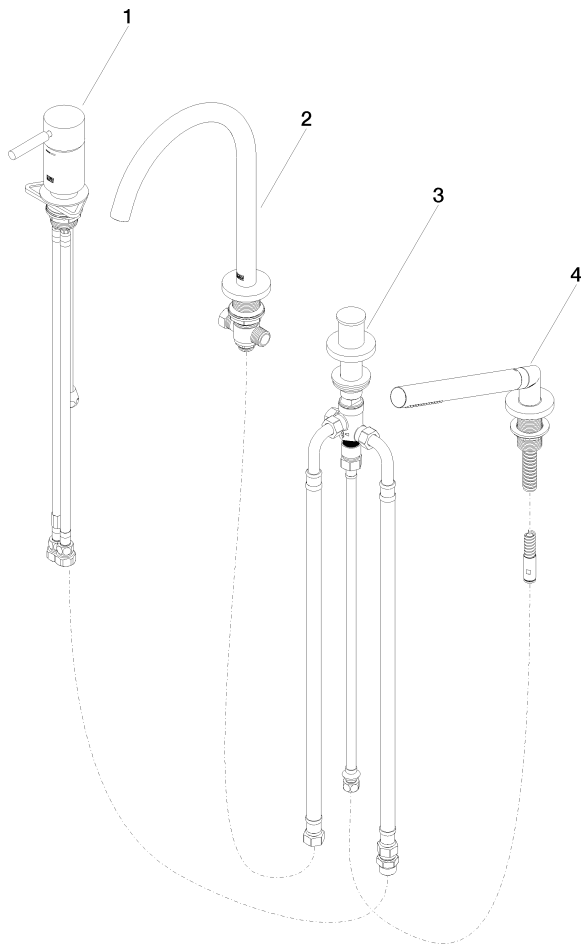

## Spare parts list

| No. | Item Number   | Name   | Quantity used | Delivery time |
|-----|---------------|--|---------------|---------------|
| 1   | 29 300 660-00 | META Single-lever bath mixer for bath rim or tile edge installation - Chrome | 1             | 10            |
| 2   | 13 512 661-00 | spout  | 1             | 60            |
| 3   | 29 140 660-00 | META Two-way diverter for bath rim or tile edge installation - Chrome        | 1             | 10            |
| 4   | 27 702 660-00 | META Hand shower set for bath rim or tile edge installation - Chrome         | 1             | 10            |