

Hand shower set with individual rosettes FlowReduce - Platinum

IMO

27 808 980



Fits: IMO, MEM, CL.1, CYO

- COMPACT RAIN, max. flow rate 6.8 l/min (at 3 bar)
- with anti-scale system
- 3/8" shower outlet
- rosette for wall elbow 60 x 60mm
- rosette for shower holder 60 x 60mm
- metal shower hose 1250mm with integrated anti-twist protection
- 1/2" wall elbow
- This product can help a building meet the requirements of Green Building Rating Systems, e.g. LEED®, BREEAM®, DGNB

Intrinsic protection against back flow.

| | | |
|--|-------------------------------|--------------------|
| | Platinum | 27 808 980-08 0010 |
| | Chrome | 27 808 980-00 |
| | Chrome | 27 808 980-00 0010 |
| | Brushed Platinum | 27 808 980-06 |
| | Brushed Platinum | 27 808 980-06 0010 |
| | Platinum | 27 808 980-08 |
| | Dark Chrome | 27 808 980-19 |
| | Dark Chrome | 27 808 980-19 0010 |
| | Brushed Durabass (23kt Gold) | 27 808 980-28 0010 |
| | Brushed Durabass (23kt Gold) | 27 808 980-28 |
| | Matte Black | 27 808 980-33 |
| | Matte Black | 27 808 980-33 0010 |
| | Brushed Champagne (22kt Gold) | 27 808 980-46 0010 |
| | Champagne (22kt Gold) | 27 808 980-47 0010 |
| | Brushed Chrome | 27 808 980-93 |
| | Brushed Chrome | 27 808 980-93 0010 |
| | Brushed Dark Platinum | 27 808 980-99 |
| | Brushed Dark Platinum | 27 808 980-99 0010 |

Recommended miscellaneous

Concealed wall elbow -

35 085 970 90



- max. recess depth 163 mm
- min. recess depth 90 mm

27 808 980

mm [inches]

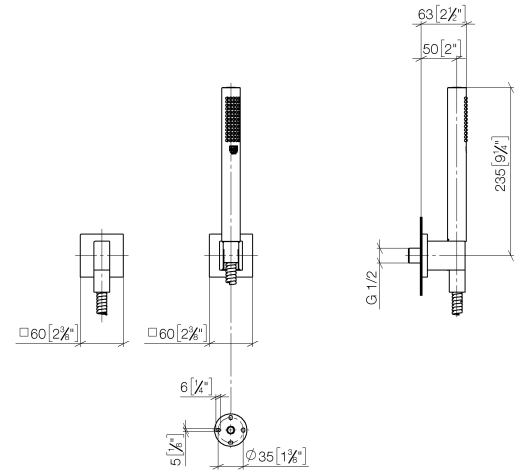

Flow rate chart

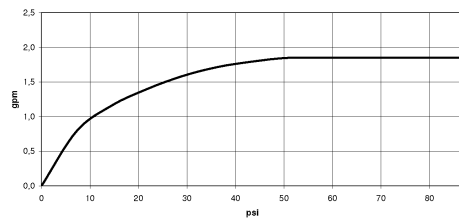

Certificates

LGA_29985.

IAPMO_4976 (1).

27 808 980

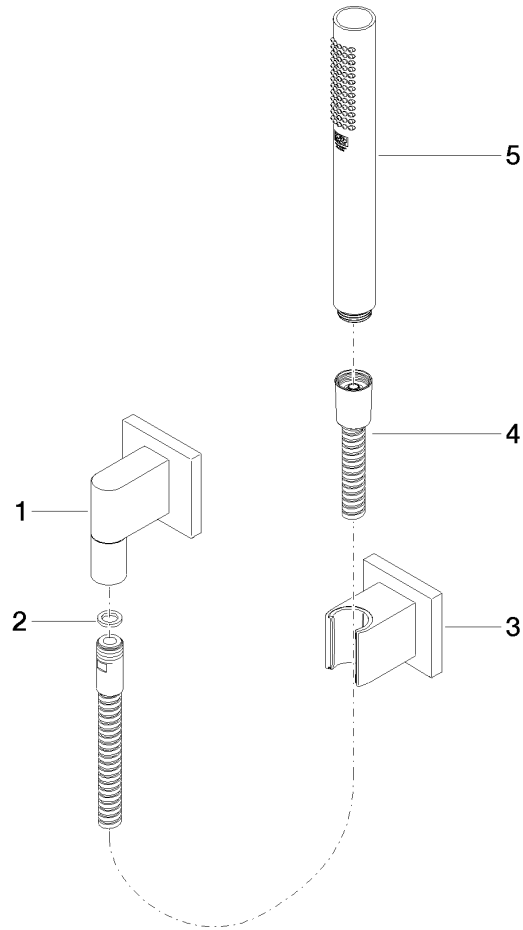

Spare parts list

| No. | Item Number | Name | Quantity used | Delivery time |
|-----|--------------------|--|---------------|---------------|
| 1 | 28 450 980-08 | Wall elbow - Platinum | 1 | 40 |
| 2 | 90 14 20 026 00 90 | seal | 1 | 2 |
| 3 | 28 050 980-08 | Wall bracket - Platinum | 1 | 40 |
| 4 | 90 30 02 072 00-08 | Metal shower hose 1/2" x 3/8" x 1250 mm - Platinum | 1 | 40 |
| 5 | 90 12 11 140 30-08 | shower | 1 | 40 |