

# Rain shower for surface-mounted ceiling installation with light 300 x 240 mm - SERIES SPECIFIC Chrome

28 042 980    Product version from 5/1/2022

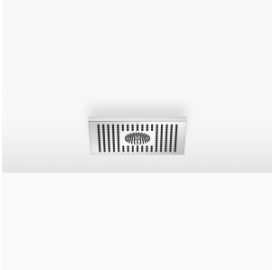

- rain shower 300 x 240mm
- PURE RAIN, max. flow rate 12 l/min (at 3 bar)
- PURIFY RAIN, max. flow rate 6 l/min (at 3 bar)
- with anti-scale system

**Technical dimensions:**

- Distance to ceiling from bottom edge of shower 40 mm

**Ceiling module power supply**

- 350mA (CC)

**Electric:**

**Spot lighting**

- Technology: LED, not dimmable
- LED colour temperature approx. 3000 K
- Provided by customer: Light switch
- Contains energy efficiency class bulbs
- Bulbs protected against splashing water

**Environment**

**Planning tips:**

- Not suitable for outdoor use.
- Not suitable for use in a steam room.
- Not suitable for use in chlorinated or salty environments.
- Comply with the protection zone regulations as defined in DIN VDE 0100, Part 701 (IEC 60364-7-701).
- WRAS

	Chrome	28 042 980-00
	Brushed Platinum	28 042 980-06
	Platinum	28 042 980-08
	Brushed Durabronze (23kt Gold)	28 042 980-28
	Matte Black	28 042 980-33
	Brushed Champagne (22kt Gold)	28 042 980-46
	Champagne (22kt Gold)	28 042 980-47
	Brushed Chrome	28 042 980-93
	Brushed Dark Platinum	28 042 980-99

## Required miscellaneous



**Concealed ceiling installation box for surface-mounted ceiling installation with light -**

- min. recess depth 90 mm
- max. recess depth 115 mm
- 2x female thread 1/2" connections
- Input 100-240V AC 50-60Hz
- concealed rough parts
- Output 350 mA SELV / Class 2
- Provided by customer: Light switch

## Rain shower for surface-mounted ceiling installation with light 300 x 240 mm - SERIES SPECIFIC Chrome

28 042 980 Product version from 5/1/2022  
mm [inches]

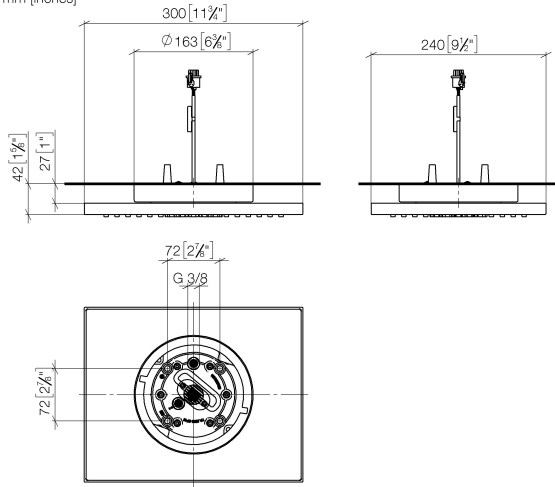

### Flow rate chart



### Codes & Standards

DIN 4109

ISO 3822

Scottish Water  
Byelaws

UK Water Supply  
Regulations

### Ü-Zeichen



Rain shower for surface-mounted ceiling installation with light 300 x 240 mm -      SERIES SPECIFIC  
Chrome

---

28 042 980    Product version from 5/1/2022

Certificates and sustainability

---

LGA\_38                      WRAS\_240502

# Rain shower for surface-mounted ceiling installation with light 300 x 240 mm - SERIES SPECIFIC Chrome

28 042 980 Product version from 5/1/2022

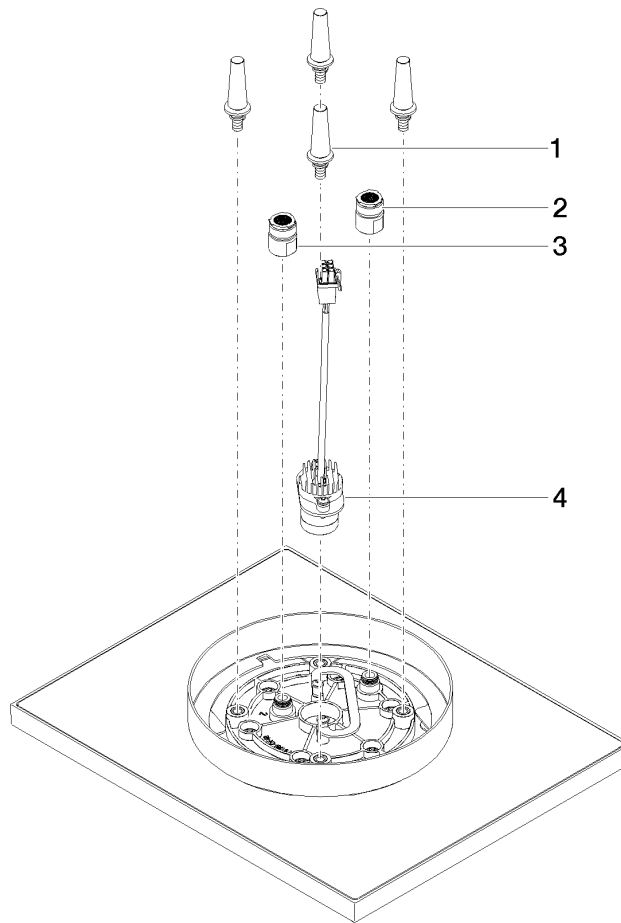

## Spare parts list

No.	Item Number	Name	Quantity used	Delivery time
1	90 17 20 263 00 90	fixing set	1.00	2
4	90 10 01 225 00 90	electronic accessories	1.00	2
2	90 24 03 309 01 90	connection	1.00	2
3	90 24 03 309 00 90	connection	1.00	2