













## Wall elbow with integrated shower holder - Brushed Platinum

28 490 660 Product version from 10/1/2023

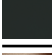

- 3/8" shower outlet
- rosette Ø 60 mm
- 1/2" connection
- WRAS

Intrinsic protection against back flow.

|   |                                |               |
|---|--------------------------------|---------------|
|    | Brushed Platinum               | 28 490 660-06 |
|    | Chrome                         | 28 490 660-00 |
|    | Platinum                       | 28 490 660-08 |
|    | Dark Chrome                    | 28 490 660-19 |
|    | Light Gold                     | 28 490 660-26 |
|    | Brushed Light Gold             | 28 490 660-27 |
|    | Brushed Durabronze (23kt Gold) | 28 490 660-28 |
|    | Matte Black                    | 28 490 660-33 |
|    | Brushed Bronze                 | 28 490 660-42 |
|   | Brushed Champagne (22kt Gold)  | 28 490 660-46 |
|  | Champagne (22kt Gold)          | 28 490 660-47 |
|   | Cyprum                         | 28 490 660-49 |
|  | Brushed Chrome                 | 28 490 660-93 |
|  | Brushed Dark Platinum          | 28 490 660-99 |

### Recommended miscellaneous

#### Concealed wall elbow -

35 085 970 90



- max. recess depth mm
- min. recess depth mm

Wall elbow with integrated shower holder - Brushed Platinum

28 490 660 Product version from 10/1/2023

mm [inches]

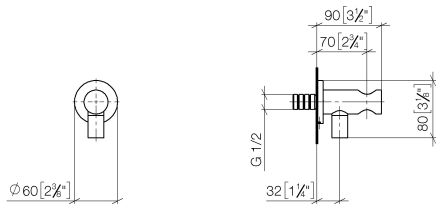

Flow rate chart

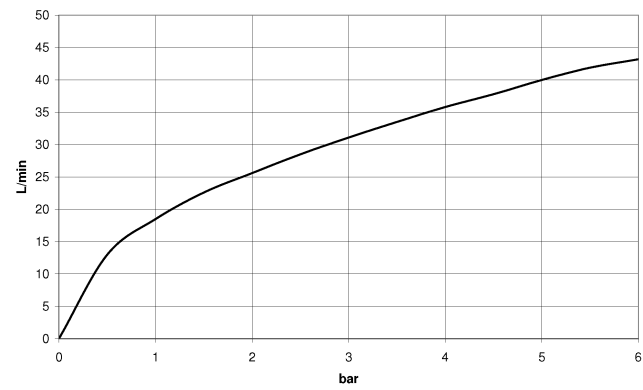

Codes & Standards

EN 1717

Scottish Water  
Byelaws

UK Water Supply  
Regulations



## Wall elbow with integrated shower holder - Brushed Platinum

---

28 490 660 Product version from 10/1/2023

### Certificates

---

Belgaqua\_21-024-2 WRAS\_1912

## Wall elbow with integrated shower holder - Brushed Platinum

28 490 660 Product version from 10/1/2023

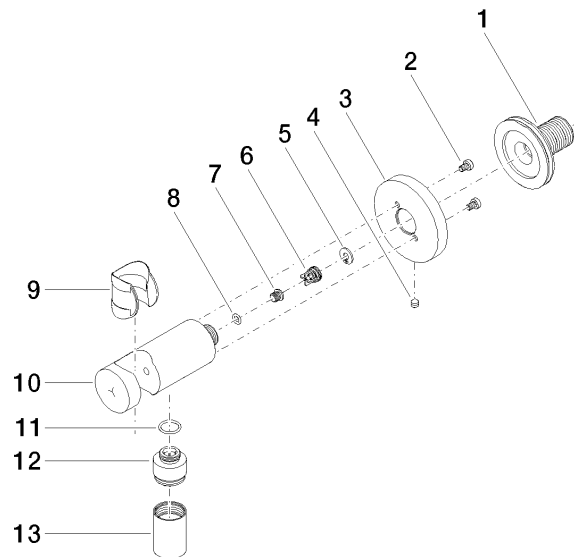

### Spare parts list

| No. | Item Number        | Name                | Quantity used | Delivery time |
|-----|--------------------|---------------------|---------------|---------------|
| 1   | 90 24 03 280 00 90 | nipple              | 1             | 2             |
| 2   | 09 30 30 037 90    | screw               | 2             | 2             |
| 3   | 09 27 66 001-06    | rosette             | 1             | 10            |
| 4   | 09 31 11 112 90    | pin                 | 1             | 60            |
| 5   | 09 16 01 023 90    | ring                | 1             | 2             |
| 6   | 09 23 01 131 90    | back-flow preventer | 1             | 2             |
| 7   | 09 30 30 113 20 90 | screw               | 1             | 2             |
| 8   | 09 14 10 001 90    | seal                | 1             | 2             |
| 9   | 09 18 40 216 90    | sleeve              | 1             | 2             |
| 10  | 09 11 03 124-06    | connection          | 1             | 10            |
| 11  | 09 14 10 213 90    | seal                | 1             | 2             |
| 12  | 09 24 03 279-06    | nipple              | 1             | 10            |
| 13  | 90 21 02 069 00-06 | cover               | 1             | 10            |