









- rain shower Ø 200 mm
- rain flow
- max. flow 7 l/min
- Function from: 6.5 l/min
- with anti-scale system

**Technical data:**

- 435mm projection
- rosette Ø 55 mm
- 1/2" connection

**Notes:**

- This product can help a building meet the requirements of Green Building Rating Systems, e.g. LEED®, BREEAM®, DGNB

	Chrome	28 544 977-00
	Brushed Platinum	28 544 977-06
	Platinum	28 544 977-08
	Durabrand (23kt Gold)	28 544 977-09
	Brushed Durabrand (23kt Gold)	28 544 977-28
	Brushed Dark Brass	28 544 977-39
	Brushed Dark Platinum	28 544 977-99

28 544 977 Product version from 7/1/2025

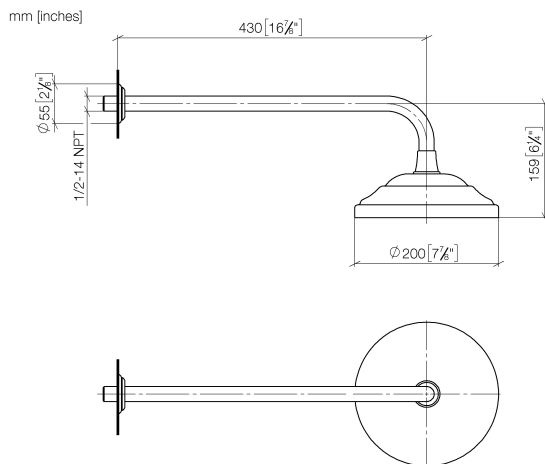

## Flow rate chart

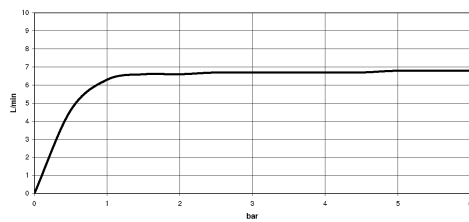

## Codes & Standards

DIN 4109

ISO 3822

Scottish Water  
Byelaws

UK Water Supply  
Regulations

## Ü-Zeichen



## MADISON Rain shower with wall fixing FlowReduce 200 mm - Chrome

---

MADISON

28 544 977 Product version from 7/1/2025

Certificates and sustainability

---

LGA\_38

WRAS\_250102

Parts for other finishes can be found here: [Brushed](#)  
[Platinum](#)

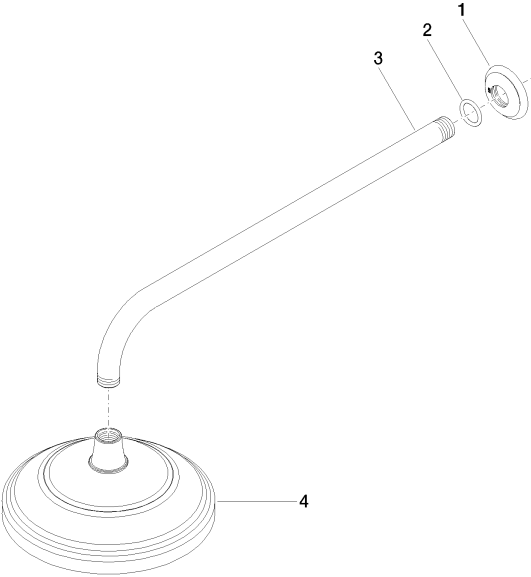

### Spare parts list

No.	Item Number	Name	Quantity used	Delivery time
	3 09 11 03 017-00	connection	1.00	10
	4 90 12 05 038 20-00	shower	1.00	10
	1 09 27 35 003-00	rosette	1.00	10
	2 90 14 10 026 00 90	seal	1.00	2