







MADISON Rain shower with wall fixing FlowReduce 200 mm - Platinum

28 544 977



- 435mm projection
- rain shower Ø 200 mm
- rain flow
- max. flow 7 l/min
- Function from: 6.5 l/min
- rosette Ø 55 mm
- 1/2" connection
- with anti-scale system
- This product can help a building meet the requirements of Green Building Rating Systems, e.g. LEED®, BREEAM®, DGNB

| | | |
|---|-------------------------------|---------------|
|  | Platinum | 28 544 977-08 |
|  | Chrome | 28 544 977-00 |
|  | Brushed Platinum | 28 544 977-06 |
|  | Durabrand (23kt Gold) | 28 544 977-09 |
|  | Brushed Durabrand (23kt Gold) | 28 544 977-28 |
|  | Brushed Dark Platinum | 28 544 977-99 |

MADISON Rain shower with wall fixing FlowReduce 200 mm - Platinum

28 544 977

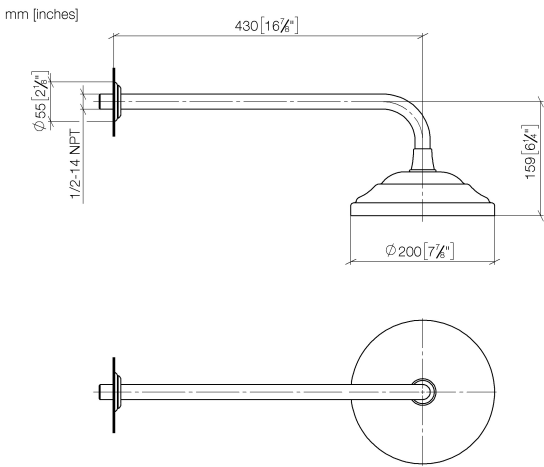

Flow rate chart

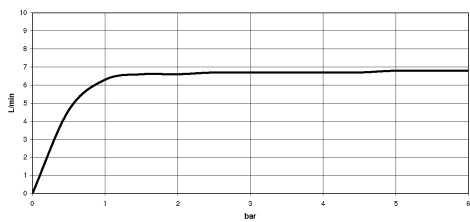

Codes & Standards

| | | | |
|----------|----------|---------------------------|--------------------------------|
| DIN 4109 | ISO 3822 | Scottish Water Byelaws | UK Water Supply Regulations |
|----------|----------|---------------------------|--------------------------------|

Ü-Zeichen



MADISON Rain shower with wall fixing FlowReduce 200 mm - Platinum

28 544 977

Certificates

LGA_38

WRAS_250102

MADISON Rain shower with wall fixing FlowReduce 200 mm - Platinum

28 544 977

Parts for other
finishes can be found
here: [Chrome](#)

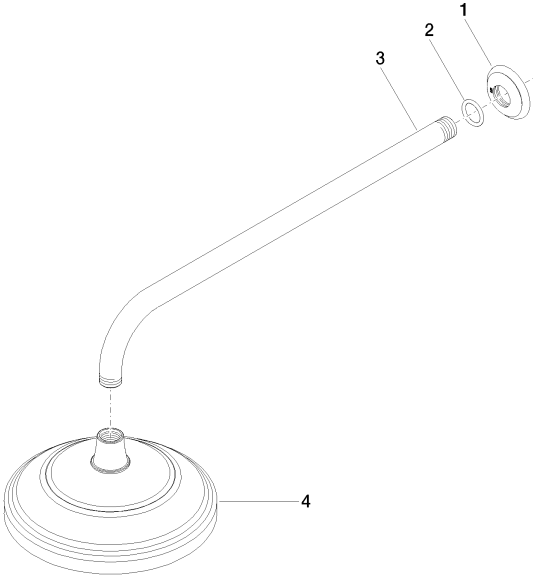

Spare parts list

| No. | Item Number | Name | Quantity used | Delivery time |
|-----|--------------------|------------|---------------|---------------|
| 1 | 09 27 35 003-08 | rosette | 1 | 40 |
| 2 | 90 14 10 026 00 90 | seal | 1 | 2 |
| 3 | 09 11 03 017-08 | connection | 1 | 40 |
| 4 | 90 12 05 038 20-08 | shower | 1 | 40 |