







# MADISON Rain shower with wall fixing 200 mm - Brushed Chrome

28 545 977    Product version from 12/5/2019

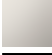

- 435mm projection
- rain shower Ø 200 mm
- PURE RAIN, max. flow rate 14 l/min (at 3 bar)
- Function from: 8 l/min
- rosette Ø 55 mm
- 1/2" connection
- with anti-scale system

	Brushed Chrome	28 545 977-93
	Chrome	28 545 977-00
	Brushed Platinum	28 545 977-06
	Platinum	28 545 977-08
	Durabrass (23kt Gold)	28 545 977-09
	Brushed Durabrass (23kt Gold)	28 545 977-28
	Brushed Dark Platinum	28 545 977-99

## MADISON Rain shower with wall fixing 200 mm - Brushed Chrome

28 545 977 Product version from 12/5/2019

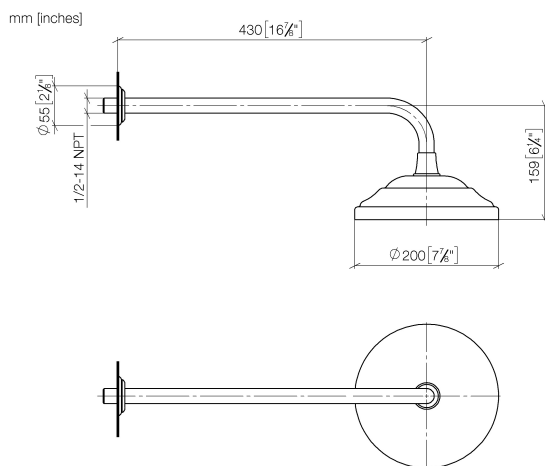

Flow rate chart

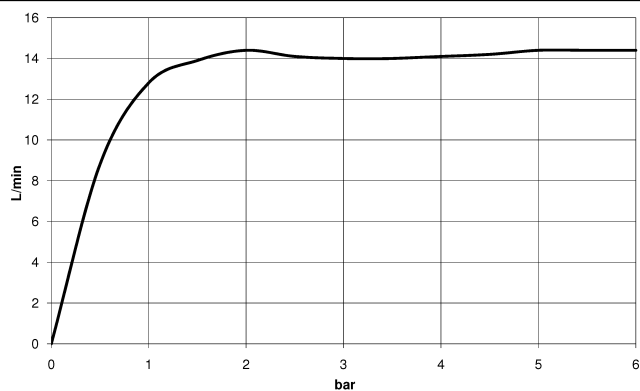

### Codes & Standards

ASME A112.18.1

cUPC

DIN 4109

EN 1112

ISO 3822

Ü-Zeichen



## MADISON Rain shower with wall fixing 200 mm - Brushed Chrome

---

28 545 977 Product version from 12/5/2019

### Certificates

---

DVGW\_DW-  
6517DN0

LGA\_38

IAPMO\_4976

# MADISON Rain shower with wall fixing 200 mm - Brushed Chrome

28 545 977    Product version from 12/5/2019

Parts for other  
finishes can be found  
here: [Chrome](#)

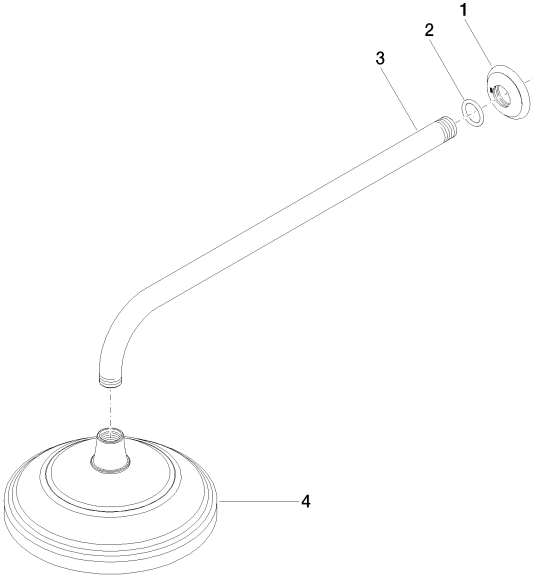

## Spare parts list

No.	Item Number	Name	Quantity used	Delivery time
1	09 27 35 003-93	rosette	1	60
2	90 14 10 026 00 90	seal	1	2
3	09 11 03 017-93	connection	1	60
4	04 12 05 038 01-93	shower	1	20