

Rain shower with wall fixing FlowReduce 300 mm - Brushed Dark Platinum

SERIES SPECIFIC

28 678 670 Product version from 5/1/2024



- 450mm projection
- rain shower Ø 300 mm
- rain flow
- max. flow 9 l/min
- Function from: 7 l/min
- rosette 65 x 65 mm
- 1/2" connection
- with anti-scale system
- quick clearing
- This product can help a building meet the requirements of Green Building Rating Systems, e.g. LEED®, BREEAM®, DGNB

| | | |
|---|--------------------------------|---------------|
|  | Brushed Dark Platinum | 28 678 670-99 |
|  | Chrome | 28 678 670-00 |
|  | Brushed Platinum | 28 678 670-06 |
|  | Platinum | 28 678 670-08 |
|  | Dark Chrome | 28 678 670-19 |
|  | Brushed Light Gold | 28 678 670-27 |
|  | Brushed Durabronze (23kt Gold) | 28 678 670-28 |
|  | Matte Black | 28 678 670-33 |
|  | Brushed Bronze | 28 678 670-42 |
|  | Brushed Champagne (22kt Gold) | 28 678 670-46 |
|  | Champagne (22kt Gold) | 28 678 670-47 |
|  | Brushed Chrome | 28 678 670-93 |

28 678 670 Product version from 5/1/2024

mm [inches]

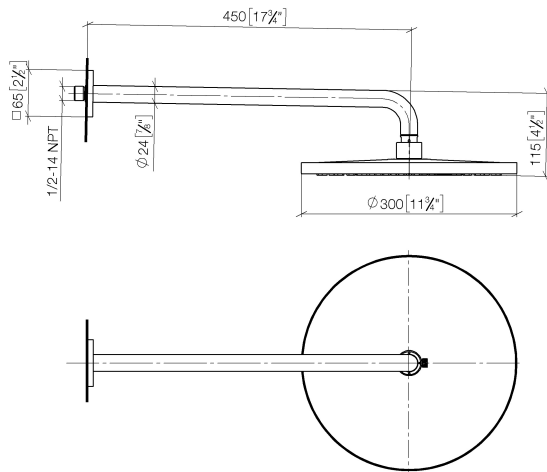

Flow rate chart



Codes & Standards

DIN 4109

ISO 3822

Ü-Zeichen



Rain shower with wall fixing FlowReduce 300 mm - Brushed Dark Platinum

SERIES SPECIFIC

28 678 670 Product version from 5/1/2024

Certificates and sustainability

LGA_29

Parts for other
finishes can be found
here: [Chrome](#)

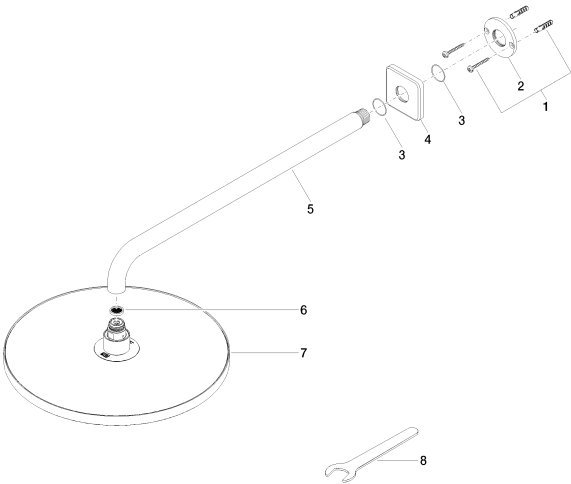

Spare parts list

| No. | Item Number | Name | Quantity used | Delivery time |
|-----|----------------------|------------|---------------|---------------|
| | 6 09 23 01 075 90 | insert | 1.00 | 2 |
| | 1 04 30 31 032 00 90 | fixing set | 1.00 | 2 |
| | 8 90 30 09 069 00 90 | key | 1.00 | 2 |
| | 5 90 11 03 070 00-99 | pipe | 1.00 | 20 |
| | 3 09 14 10 150 90 | seal | 2.00 | 2 |
| | 7 90 12 05 091 20-99 | shower | 1.00 | 20 |
| | 4 09 27 67 015-99 | rosette | 1.00 | 20 |
| | 2 09 17 20 120 90 | holder | 1.00 | 2 |