

META META SLIM Single-lever basin mixer without pop-up waste - Matte Black

META

33 526 662 Product version up to 1/23/2020



- 125mm projection
- fixed spout
- circular, air-enriched flow
- height of mixer 134 mm
- height up to aerator 52 mm
- hole diameter 35 mm
- 2x screw-in M 8 x 1 pressure hose, leak-tested
- max. flow 5.7 l/min
- lead-free
- This product can help a building meet the requirements of Green Building Rating Systems, e.g. LEED®, BREEAM®, DGNB
- WRAS

| | | |
|---|-------------------------------|---------------|
|  | Matte Black | 33 526 662-33 |
|  | Chrome | 33 526 662-00 |
|  | Brushed Platinum | 33 526 662-06 |
|  | Dark Chrome | 33 526 662-19 |
|  | Light Gold | 33 526 662-26 |
|  | Brushed Light Gold | 33 526 662-27 |
|  | Brushed Dark Brass | 33 526 662-39 |
|  | Brushed Bronze | 33 526 662-42 |
|  | Brushed Champagne (22kt Gold) | 33 526 662-46 |
|  | Champagne (22kt Gold) | 33 526 662-47 |
|  | Brushed Chrome | 33 526 662-93 |
|  | Brushed Dark Platinum | 33 526 662-99 |

33 526 662 Product version up to 1/23/2020

mm [inches]

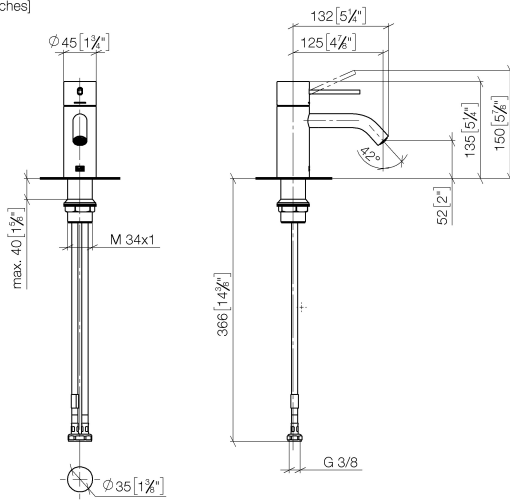

Flow rate chart



Codes & Standards

DIN 4109

ISO 3822

Scottish Water
Byelaws

UK Water Supply
Regulations

Ü-Zeichen



META META SLIM Single-lever basin mixer without pop-up waste - Matte Black

META

33 526 662 Product version up to 1/23/2020

Certificates and sustainability

LGA_29

WRAS_2003

33 526 662 Product version up to 1/23/2020

Parts for other
finishes can be found
here: [Chrome](#)

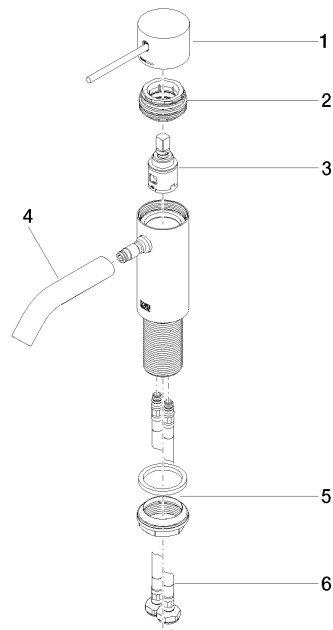

Spare parts list

| No. | Item Number | Name | Quantity used | Delivery time |
|-----|--------------------|--------------------|---------------|---------------|
| 4 | 90 11 06 206 00-33 | spout | 1.00 | 30 |
| 2 | 90 24 04 536 00 90 | threaded connector | 1.00 | 60 |
| 5 | 04 23 10 044 07 90 | fixing set | 1.00 | 2 |
| 6 | 04 30 04 100 00 90 | hose | 2.00 | 2 |
| 1 | 90 20 66 020 00-33 | handle | 1.00 | 30 |
| 3 | 90 15 05 042 00 90 | cartridge | 1.00 | 2 |