

# META META SLIM Single-lever basin mixer without pop-up waste - Brushed Dark Platinum

META

33 526 662 Product version from 10/1/2021 to 4/1/2025



- 125mm projection
- fixed spout
- circular, air-enriched flow
- height of mixer 134 mm
- height up to aerator 52 mm
- hole diameter 35 mm
- 2x screw-in M 8 x 1 pressure hose, leak-tested
- max. flow 5.7 l/min
- lead-free
- This product can help a building meet the requirements of Green Building Rating Systems, e.g. LEED®, BREEAM®, DGNB
- WRAS

	Brushed Dark Platinum	33 526 662-99
	Chrome	33 526 662-00
	Brushed Platinum	33 526 662-06
	Dark Chrome	33 526 662-19
	Light Gold	33 526 662-26
	Brushed Light Gold	33 526 662-27
	Matte Black	33 526 662-33
	Brushed Dark Brass	33 526 662-39
	Brushed Bronze	33 526 662-42
	Brushed Champagne (22kt Gold)	33 526 662-46
	Champagne (22kt Gold)	33 526 662-47
	Brushed Chrome	33 526 662-93

# META META SLIM Single-lever basin mixer without pop-up waste - Brushed Dark Platinum

META

33 526 662 Product version from 10/1/2021 to 4/1/2025  
mm [inches]

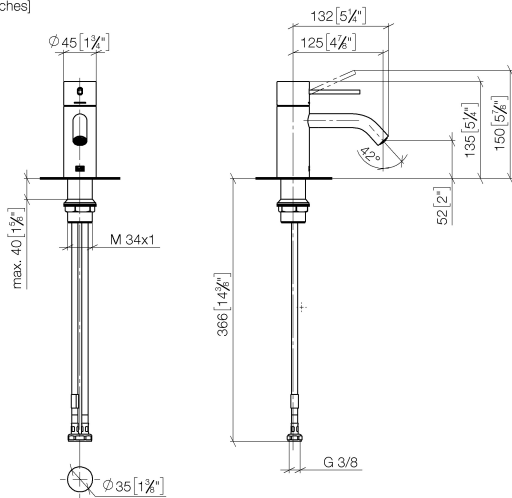

## Flow rate chart



## Codes & Standards

DIN 4109

ISO 3822

Ü-Zeichen



## META META SLIM Single-lever basin mixer without pop-up waste - Brushed Dark Platinum

---

META

33 526 662 Product version from 10/1/2021 to 4/1/2025

Certificates and sustainability

---

LGA\_29

## META META SLIM Single-lever basin mixer without pop-up waste - Brushed Dark Platinum

META

33 526 662 Product version from 10/1/2021 to 4/1/2025

Parts for other  
finishes can be found  
here: [Chrome](#)

