

## IMO Single-lever basin mixer with high spout with pop-up waste - Brushed Light Gold





IMO

33 528 671 Product version from 4/1/2024



- 170mm projection
- rectangular, air-enriched flow
- height of mixer 279 mm
- height up to aerator 235 mm
- hole diameter 35 mm
- 2x screw-in M 8 x 1 pressure hose, leak-tested
- max. flow 4.6 l/min
- lead-free
- This product can help a building meet the requirements of Green Building Rating Systems, e.g. LEED®, BREEAM®, DGNB
- fixed spout

Only suitable for basins with an overflow.

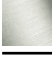
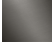
	Brushed Light Gold	33 528 671-27
	Chrome	33 528 671-00
	Brushed Platinum	33 528 671-06
	Dark Chrome	33 528 671-19
	Matte Black	33 528 671-33
	Brushed Chrome	33 528 671-93
	Brushed Dark Platinum	33 528 671-99

**IMO Single-lever basin mixer with high spout with pop-up waste - Brushed Light Gold**

IMO

33 528 671 Product version from 4/1/2024

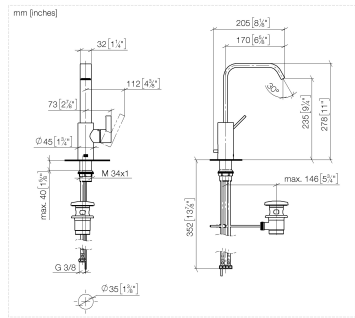

Flow rate chart

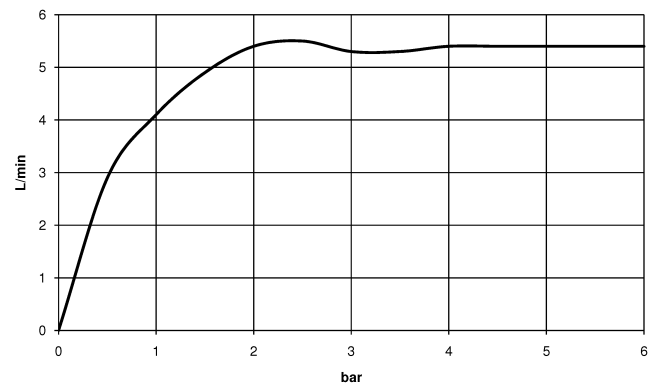

**Codes & Standards**

DIN 4109

ISO 3822

Ü-Zeichen



## IMO Single-lever basin mixer with high spout with pop-up waste - Brushed Light Gold

IMO

---

33 528 671 Product version from 4/1/2024

Certificates and sustainability

---

LGA\_28

# IMO Single-lever basin mixer with high spout with pop-up waste - Brushed Light Gold

IMO

33 528 671 Product version from 4/1/2024

Parts for other  
finishes can be found  
here: [Chrome](#)

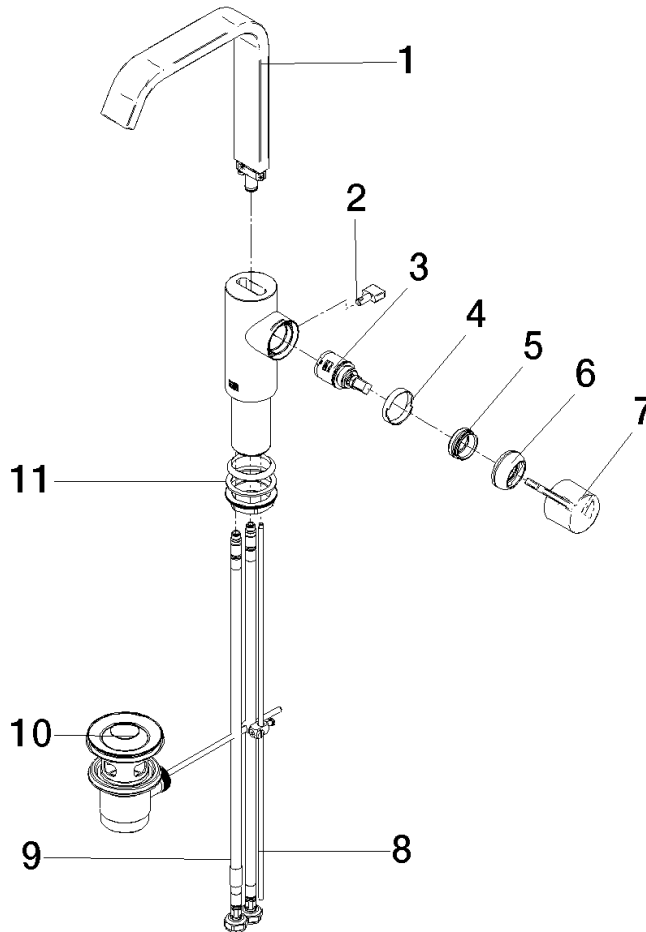

## Spare parts list

No.	Item Number	Name	Quantity used	Delivery time
7	90 20 67 027 00-27	handle	1.00	30
4	90 23 10 128 00 90	nut	1.00	2
9	04 30 04 100 00 90	hose	2.00	2
8	09 31 09 080-27	pull-rod	1.00	60
2	09 20 67 002-27	handle	1.00	60
5	09 24 04 266 90	nut	1.00	2
11	04 23 10 044 07 90	fixing set	1.00	2
3	90 15 05 042 00 90	cartridge	1.00	2
1	90 28 22 404 00-27	spout	1.00	30
6	90 28 30 061 00-27	cover	1.00	30
10	90 11 01 001 00-27	pop-up waste	1.00	30