

## META META SLIM Single-lever basin mixer with raised base without pop-up waste - Brushed Chrome

META

33 537 662 Product version up to 1/23/2020



- 135mm projection
- fixed spout
- circular, air-enriched flow
- height of mixer 300 mm
- height up to aerator 219 mm
- hole diameter 35 mm
- 2x screw-in M 8 x 1 pressure hose, leak-tested
- max. flow 5.7 l/min
- lead-free
- This product can help a building meet the requirements of Green Building Rating Systems, e.g. LEED®, BREEAM®, DGNB
- WRAS

for use on countertop bowls

Product change as of 1.4.2023: height of mixer 300 mm, height up to aerator 219 mm

	Brushed Chrome	33 537 662-93
	Chrome	33 537 662-00
	Brushed Platinum	33 537 662-06
	Dark Chrome	33 537 662-19
	Light Gold	33 537 662-26
	Brushed Light Gold	33 537 662-27
	Matte Black	33 537 662-33
	Brushed Bronze	33 537 662-42
	Brushed Champagne (22kt Gold)	33 537 662-46
	Champagne (22kt Gold)	33 537 662-47
	Brushed Dark Platinum	33 537 662-99

# META META SLIM Single-lever basin mixer with raised base without pop-up waste - Brushed Chrome

META

33 537 662 Product version up to 1/23/2020  
mm [inches]

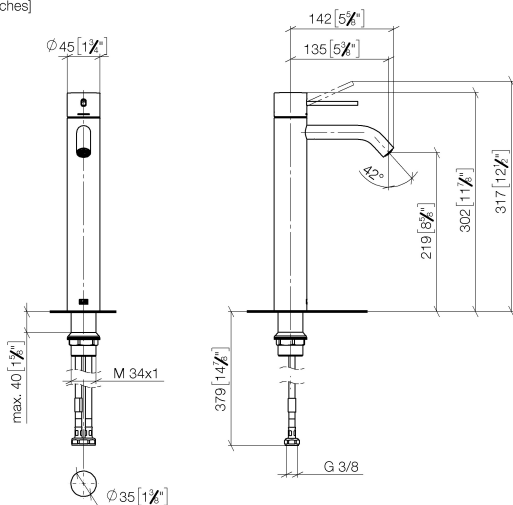

## Flow rate chart

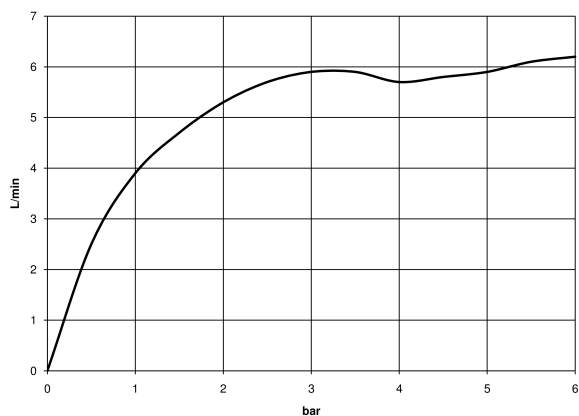

## Codes & Standards

DIN 4109

ISO 3822

Scottish Water  
Byelaws

UK Water Supply  
Regulations

## Ü-Zeichen



META META SLIM Single-lever basin mixer with raised base without pop-up  
waste - Brushed Chrome

---

META

33 537 662 Product version up to 1/23/2020

Certificates and sustainability

---

LGA\_29

WRAS\_2003

## META META SLIM Single-lever basin mixer with raised base without pop-up waste - Brushed Chrome

META

33 537 662 Product version up to 1/23/2020

Parts for other  
finishes can be found  
here: [Chrome](#)

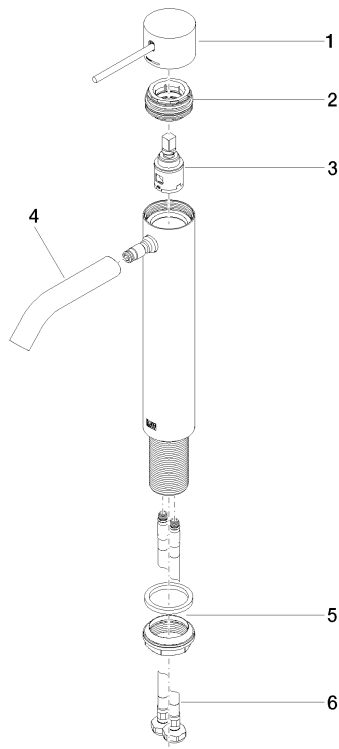

### Spare parts list

No.	Item Number	Name	Quantity used	Delivery time
5	04 23 10 044 07 90	fixing set	1.00	2
1	90 20 66 020 00-93	handle	1.00	20
4	90 11 06 207 00-93	spout	1.00	20
6	04 30 04 101 00 90	hose	2.00	2
3	90 15 05 042 00 90	cartridge	1.00	2
2	90 24 04 536 00 90	threaded connector	1.00	60